

MAYWOOD  STUDIO

# Garnish Table Set



**Garnish Table Set**

**Runner: 16 x 47, Mat: 16 x 21**

Featuring the Grand Entrance Fabric Collection

[maywoodstudio.com](http://maywoodstudio.com)

# GRAND ENTRANCE

## FABRICS FROM THE GRAND ENTRANCE COLLECTION

		FABRIC REQUIREMENTS		
		Fabric 1	10433-V2	1/3 yard
		Fabric 2	10430-E	1/4 yard
		Fabric 3	10433-E	1/4 yard
		Fabric 4	10435-V	1-1/2 yards
		Fabric 5	207-SW	3/4 yard
		Fabric 6	10431-V2	1 yard
Appliqué		Fabric 7	10435-P	1/8 yard
Appliqué		Fabric 8	M10434-E	1/8 yard
Appliqué		Fabric 9	10435-G	1/8 yard
Appliqué		Fabric 10	M10435-E	1/8 yard
				
		Backing	10848-Z	3 yards

### GARNISH TABLE SET

Instructions and Fabric requirements are for one table runner and 4 placemats.  
Fabric requirements for each project are on the following pages.

Please read all instructions before you begin. Seam allowance is 1/4".  
Fabric is abbreviated as F and by number. For example, Fabric 1 is 'F1'.  
Press seams in the direction of the arrows.

Print appliqué designs at 100%.

Appliqué designs are shown in reverse for use with Gentle Fuse fusible web.

WOF - Width of Fabric

LOF - Length of Fabric





RST - Right Sides Together

HST - Half Square Triangle







MAYWOOD  STUDIO

# Garnish Table Set

## (4) PLACEMATS 16 X 21 • YARDAGE & CUTTING INSTRUCTIONS

	Fabric	Yardage		Cutting
	F1	1/4 yard	A	(8) 5" squares
	F2	1/4 yard	B	(4) 5" squares
	F3	1/4 yard	C	(4) 5" squares
	F4	7/8 yard *includes binding	D E F	Cut (8) 2-1/2" x WOF strips for binding. Cut (2) 2-1/2" x WOF strips into (32) 2-1/2" squares Cut (1) 4" x WOF strip into (4) 4" x 10-1/2" rectangles Cut (1) 1-1/2" x WOF strip into (4) 1-1/2" squares
	F5	1/2 yard	G H I	Cut (9) 1-1/2" x WOF strips From 2 strips cut (16) 1-1/2" x 5" rectangles From 3 strips cut (12) 1-1/2" x 10-1/2" rectangles From 4 strips cut (8) 1-1/2" x 17" rectangles
	F6	5/8 yard	K L	Cut (8) 2-1/2" x WOF strips into (8) 2-1/2" x 17" top & bottom borders (8) 2-1/2" x 16-1/2" side borders
	BACKING	1-1/2 yards		Cut (4) 21 width x 27" length rectangles

## TABLE RUNNER 16 X 47 • YARDAGE & CUTTING INSTRUCTIONS

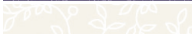
	Fabric	Yardage		Cutting
	F1	1/4 yard	A	(6) 5" squares
	F2	1/4 yard	B	(3) 5" squares
	F3	1/4 yard	C	(3) 5" squares
	F4	5/8 yard *includes binding	D E F	Cut (4) 2-1/2" x WOF strips for binding. Cut (2) 2-1/2" x WOF strips into (24) 2-1/2" squares Cut (1) 4" x WOF strip into: (2) 4" x 10-1/2" rectangles (3) 1-1/2" squares
	F5	1/3 yard	G H J	Cut (7) 1-1/2" x WOF strips From 2 strips cut (12) 1-1/2" x 5" rectangles From 2 strips cut (6) 1-1/2" x 10-1/2" rectangles Sew the remaining 3 strips together, end to end. Cut into (2) 43-1/2" top and bottom borders
	F6	1/3 yard	K L	Cut (4) 2-1/2" x WOF strips From 1 strip cut (2) 2-1/2" x 16-1/2" side borders Sew 3 strips together, end to end. Cut into (2) 2-1/2" x 43-1/2" side borders
	BACKING	1-1/2 yards		Single piece along length of fabric.

### Garnish Placemats

Instructions make 4 placemats.

### Sashed Half Snowball Block

1. Draw a diagonal line from corner to corner on the wrong side of (32) F4-D squares.

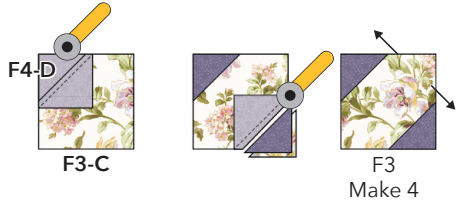

2. Place an F4-D square, RST over an F3-C square. Sew on the marked line. Cut 1/4" away from the marked line. Press. Repeat on the opposite corner. Press. Make 4.

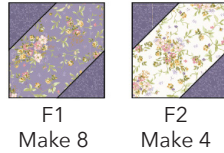

3. Repeat steps 1-2 to make (8) F1 units and (4) F2 units.

4. Top row: sew an F5-G rectangle to an F3 and F1 Half Snowball unit as illustrated to the right. Press. Make 4.

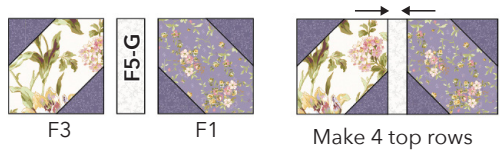

5. Bottom row: sew an F5-G rectangle to an F1 and F2 Half Snowball unit as illustrated to the right. Press. Make 4.

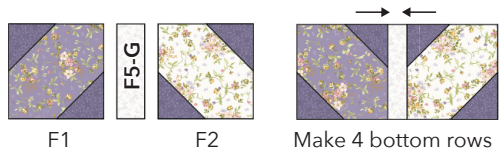

6. Make the sashing: sew an F5-G rectangle to either side of an F4-F square. Press. Make 4.



7. Finish the block: lay the sections out in three rows as illustrated below: top row - sashing - bottom row. Sew together. Press toward sashing. Make 4.

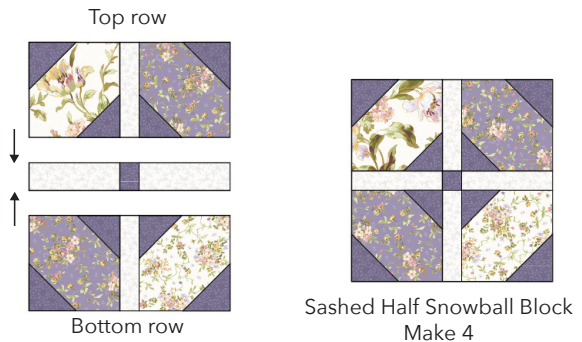

### Add the Borders

Repeat each step to make 4 placemats.

1. Sew an F4-E rectangle to an F5-H rectangle. Press toward F5.
2. Sew the step 1 unit to the left side of each Sashed Half Snowball block. Press toward F5.
3. Sew an F5-H rectangle to either side of step 2. Press toward F5.
4. Sew an F5-I rectangle to the top and bottom of step 3. Press toward F5.
5. Sew an F6-K rectangle to the top and bottom of step 4. Press toward F6.
6. Sew the F6-L rectangles to the sides of step 5. Press toward F6.

Repeat each step to make 4 placemats.

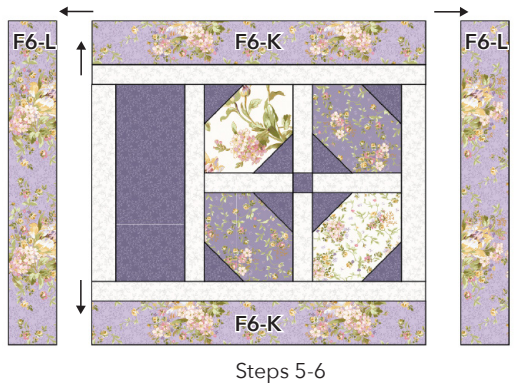
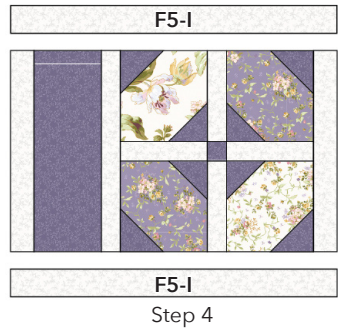
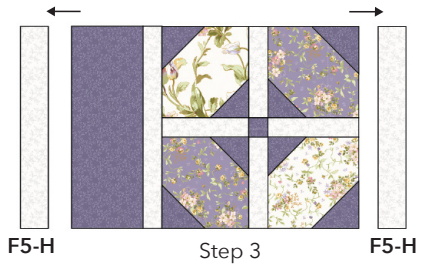
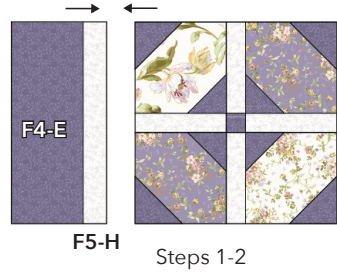



**Finish it up!**

1. Add the appliqué to the placemats.  
\*Find the appliqué templates and the instructions on pages 8-9.
2. Layer the backing (wrong side up), batting and placemat top (right side up). Baste layers to secure. Quilt as desired. Trim the excess backing and batting.
3. Sew the binding strips together into one continuous strip. Press in half length-wise. Sew the binding to the quilt top with a 1/4" seam allowance. Turn the binding to the back side of the quilt and stitch down by hand with matching thread.

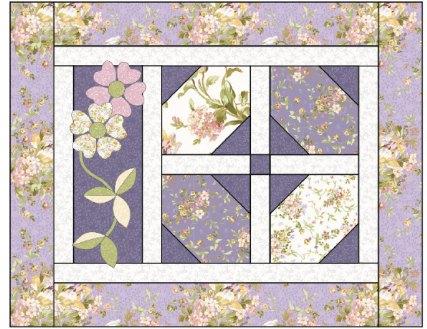

**Garnish Table Runner**

Instructions make 1 table runner

1. Follow the instructions on page 4 to make 3 Sashed Half Snowball Blocks.

\*Note you will make 3 blocks for the runner. The instructions for the placemats are for 4 blocks.

2. Sew an F5-H rectangle to either side of an F4-E rectangle. Make 2.

3. Lay the remaining F5-H rectangles, Step 2 units, and Sashed Half Snowball blocks out as illustrated below. Sew together. Press in the direction of the arrows.

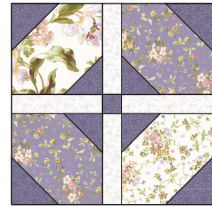

Sashed Half Snowball Block  
Make 3

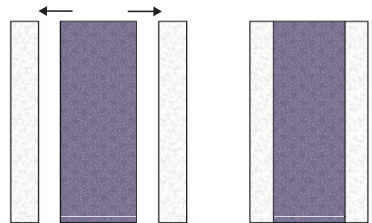

F4-E F5-H

Make 2

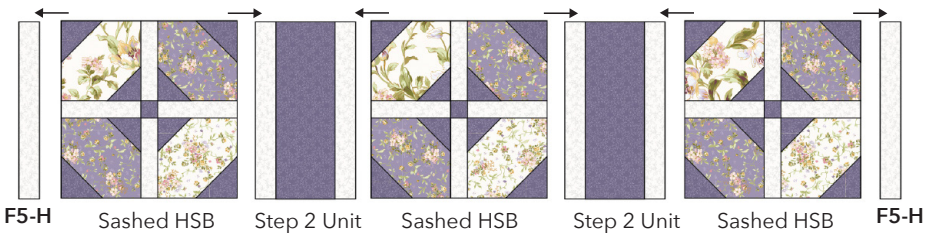

F5-H

Sashed HSB

Step 2 Unit

Sashed HSB

Step 2 Unit

Sashed HSB

F5-H

4. Sew the F5-J borders to the top and bottom of the runner. Press toward F5.
5. Sew the F6-L borders to the top and bottom of the runner. Press toward F6. Sew the F6-K borders to the sides of the runner. Press toward F6.
6. Follow the instructions on the top of p.6 to finish the runner.

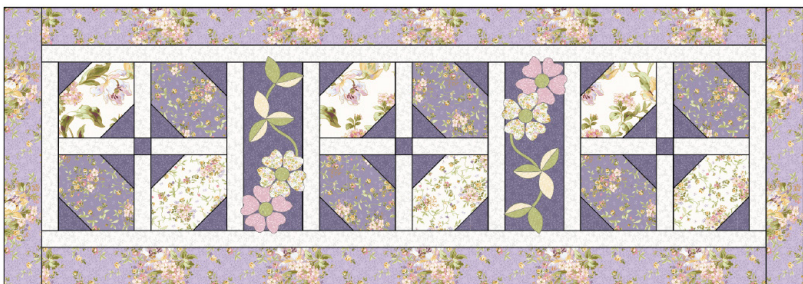
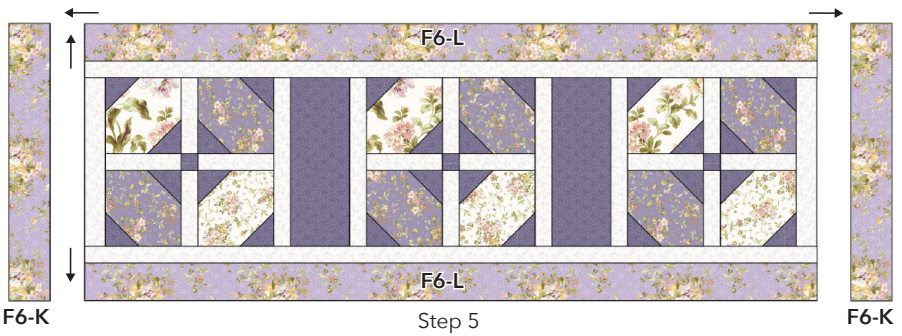
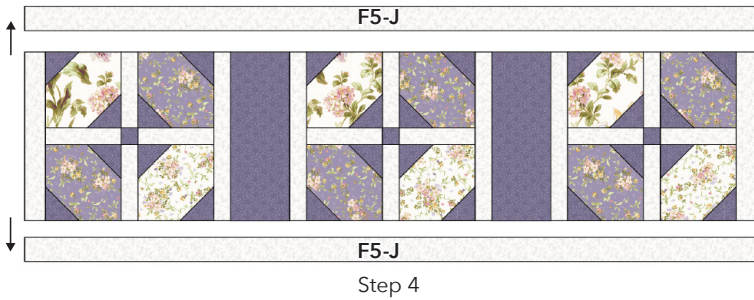

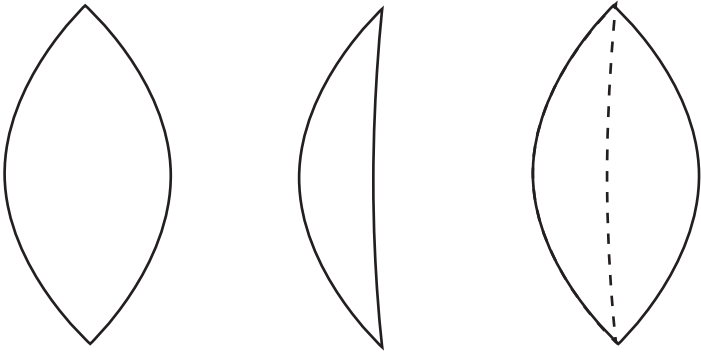

Use the leaf as a single layer and combine the partial leaf for the two color leaf

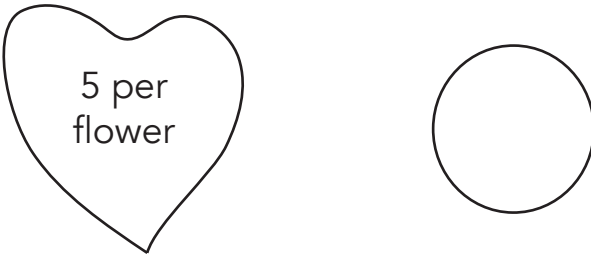

Rotate 5 flower petals and applique a circle in the center.  
The flower will be approximately 3" in diameter

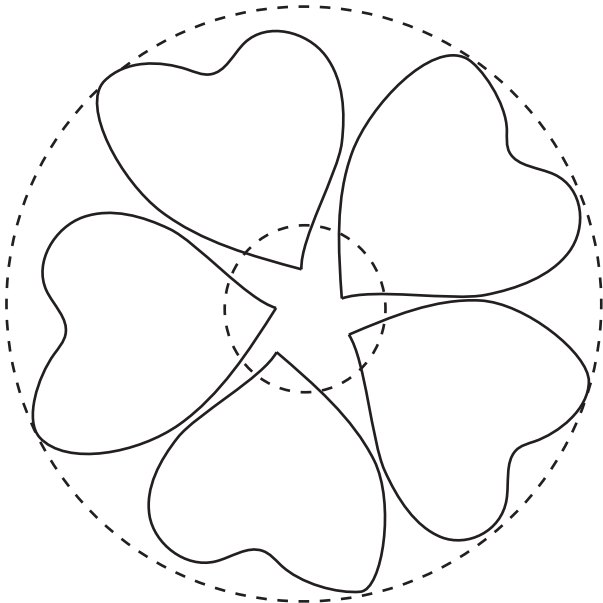



1"  
test

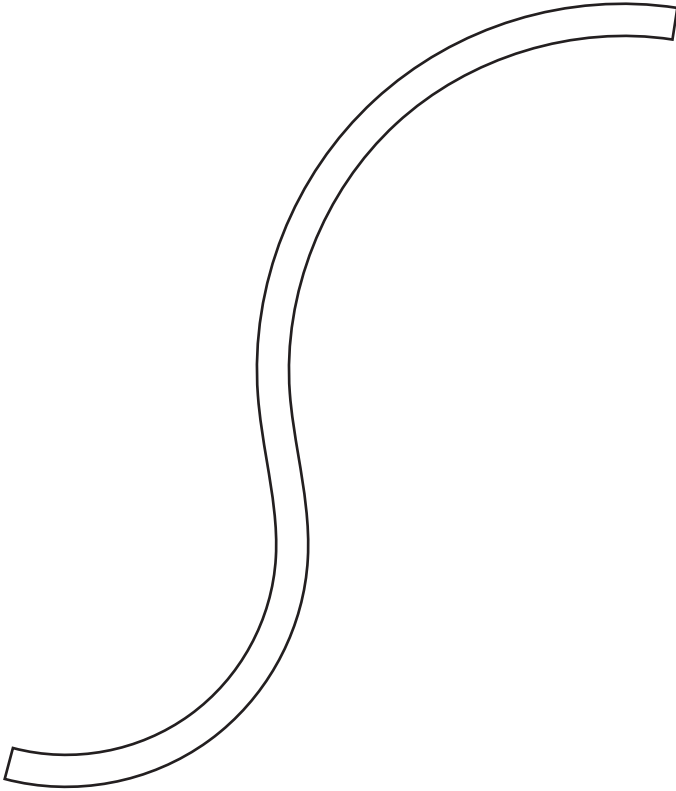

Flower appliqué layout. Measures approximately 3-1/2" x 10-1/2".  
(Layout shown reduced for reference only: not to scale.)

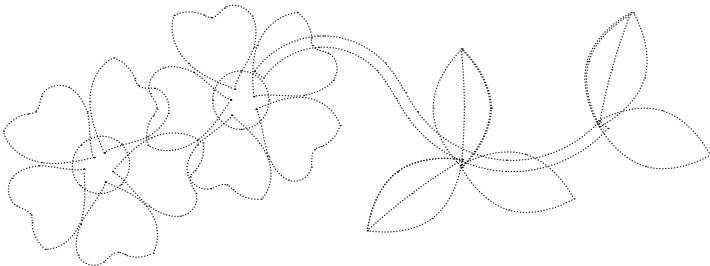

**Quilt Planning Diagram**  
Use this template to plan your quilt

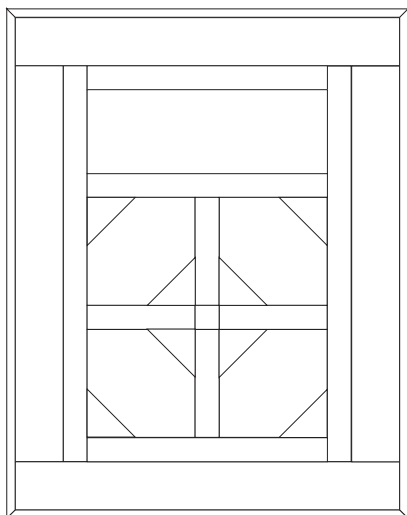
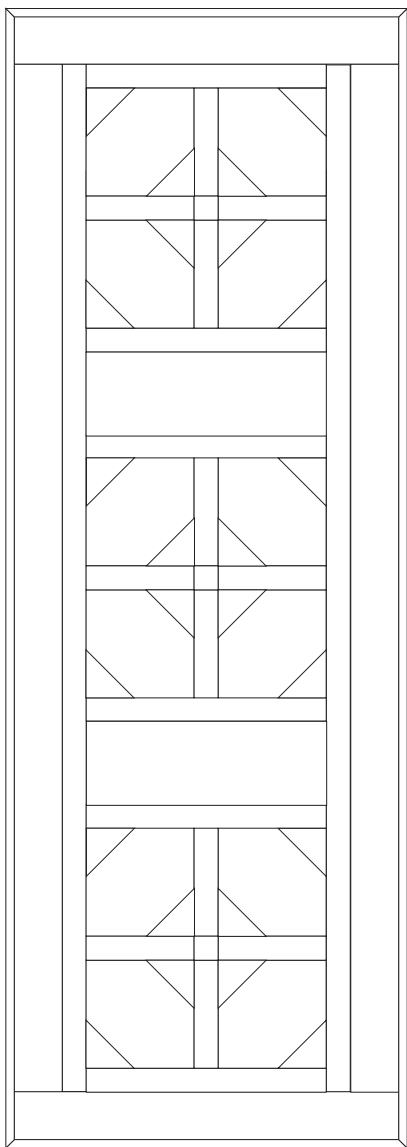

## INSTRUCTIONS

### 1. DRAW

TRACE YOUR DESIGN ONTO THE PAPER SIDE OF GENTLE FUSE. LEAVE AT LEAST ½" OF SPACE AROUND THE SHAPE AND CUT OUT.



### 2. FUSE

PRE-HEAT IRON TO A COTTON, NO STEAM SETTING & PLACE GENTLE FUSE ON THE WRONG SIDE OF FABRIC. USING IRON, PRESS FIRMLY FOR 5-8 SECONDS. CUT OUT THE DESIGN & PEEL AWAY THE PAPER BACKING. NEXT, POSITION THE PRE-FUSED APPLIQUÉ ON THE RIGHT SIDE OF FABRIC. IRON & PRESS FIRMLY FOR 8-10 SECONDS.



### 3. FINISH

FINISH WITH PREFERRED STITCH.

## FOR BEST RESULTS

PRE-WASH FABRIC • AVOID FABRIC SOFTENER • USE AN IRON  
TEST A SWATCH FIRST • DRAW DESIGNS IN REVERSE  
STORE AWAY FROM SUNLIGHT

