

STEELWORKS

Fabric and Quilt by Dolores Smith

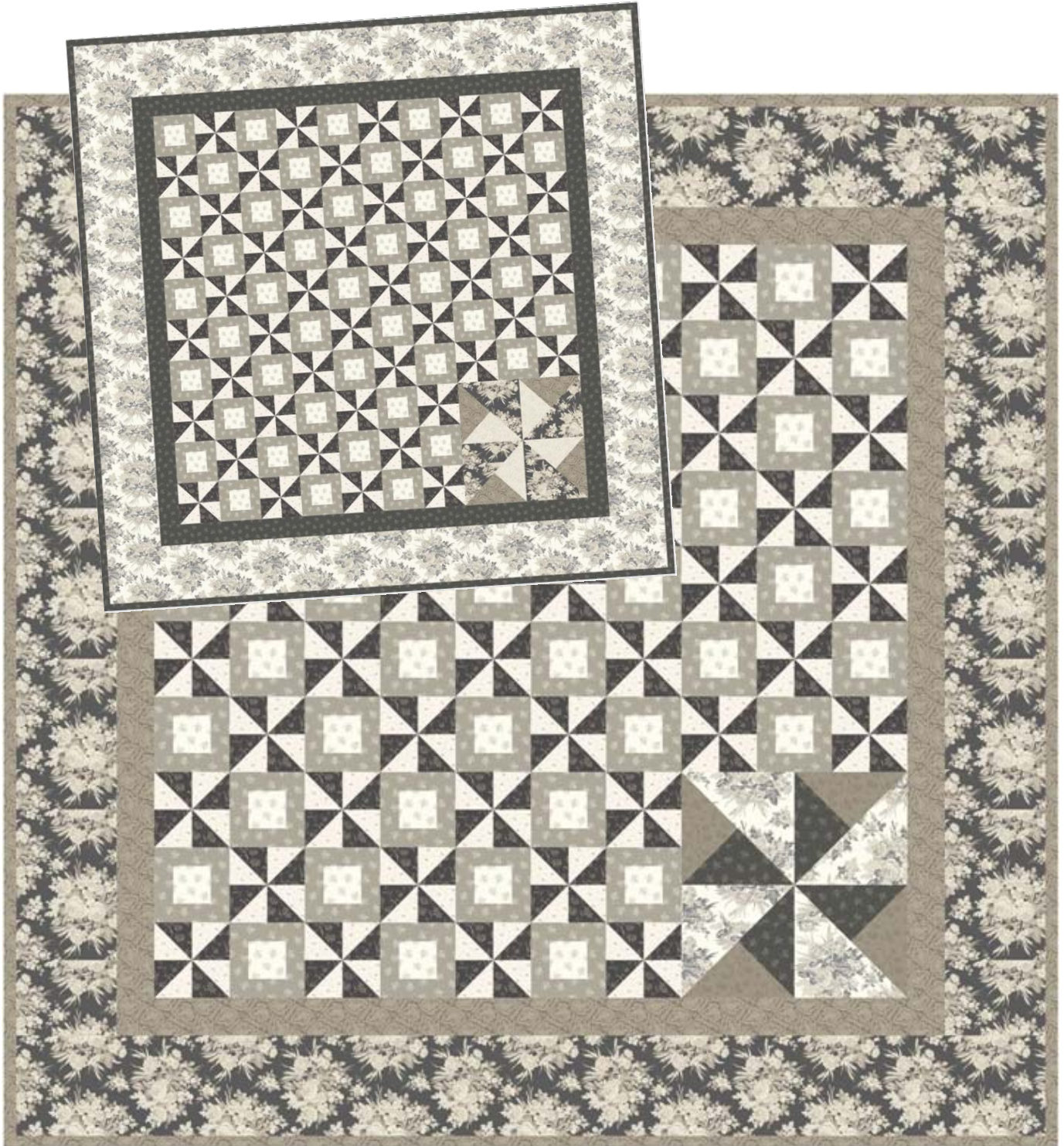

82" x 82"

Steelworks

Finished Quilt Size: 82" x 82"
Finished Block Sizes: 6" x 6" and 18" x 18"

Materials - Light

Fat Quarter of R540393-Charcoal
Fat Quarter of R540394-Taupe
Fat Quarter of R540397-Chalk
 $\frac{1}{2}$ **yard** of R540398-Cream
 $1\frac{1}{4}$ **yards** of R540395-Charcoal
 $1\frac{1}{4}$ **yards** of R540396-Ivory
 $1\frac{3}{8}$ **yards** of R540398-Charcoal (*includes binding*)
 $1\frac{1}{2}$ **yards** of R540398-Gray
 $2\frac{1}{2}$ **yards** of R540393-Cream

Materials - Dark

Fat Quarter of R540393-Cream
Fat Quarter of R540395-Gray
Fat Quarter of R540398-Charcoal
 $\frac{1}{2}$ **yard** of R540398-Cream
 $1\frac{1}{4}$ **yards** of R540395-Charcoal
 $1\frac{1}{4}$ **yards** of R540396-Ivory
 $1\frac{3}{8}$ **yards** of R540394-Taupe (*includes binding*)
 $1\frac{1}{2}$ **yards** of R540398-Gray
 $2\frac{1}{2}$ **yards** of R540393-Charcoal

Cutting:

Note: Cutting and sewing instructions are given using the Light quilt skus with the Dark quilt skus (*italicized and in parentheses*).

(A) = used in block A (B) = used in block B (C) = used in block C
WOF = width of fabric (*selvage to selvage*) LOF = length of fabric

From R540393-Charcoal (*R540393-Cream*), cut:

(2) 10" x 10" squares, cut diagonally once (C)

From R540394-Taupe (*R540395-Gray*), cut:

(1) $10\frac{1}{4}$ " x $10\frac{1}{4}$ " squares, cut diagonally twice (C)

From R540397-Chalk (*R540398-Charcoal*), cut:

(1) $10\frac{1}{4}$ " x $10\frac{1}{4}$ " squares, cut diagonally twice (C)

From R540398-Cream (*R540398-Cream*), cut:

(45) $3\frac{1}{2}$ " x $3\frac{1}{2}$ " squares (B)

From R540395-Charcoal (*R540395-Charcoal*), cut:

(92) 4" x 4" squares (A)

From R540396-Ivory (*R540396-Ivory*), cut:

(92) 4" x 4" squares (A)

From R540398-Charcoal (*R540394-Taupe*), cut:

(7) $3\frac{1}{2}$ " x WOF strips (Border One)
(9) $2\frac{1}{4}$ " x WOF strips for binding

From R540398-Gray (*R540398-Gray*), cut:

(90) 2" x $3\frac{1}{2}$ " rectangles (B)
(90) 2" x $6\frac{1}{2}$ " rectangles (B)

From R540393-Cream (*R540393-Charcoal*), cut:

(4) $8\frac{1}{2}$ " x LOF strips (Border Two)

Making Block A:

1. Draw a diagonal line on the wrong side of (92) 4" x 4" R540396-Ivory (*R540396-Ivory*) squares. Place a marked square, right sides together, on (1) 4" x 4" R540395-Charcoal (*R540395-Charcoal*) square.
2. Sew $\frac{1}{4}$ " away on each side of the drawn line. Cut on the drawn line to make (2) HSTs. Press the seams toward the R540395-Charcoal (*R540395-Charcoal*) triangles. Square and trim, if needed to make (2) $3\frac{1}{2}$ " x $3\frac{1}{2}$ " HSTs. Make a total of (184) HSTs.

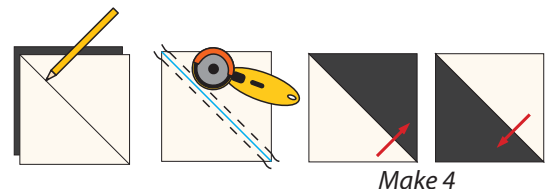

Steelworks

3. Lay out (4) HSTs in two rows of two HSTs each, noting the orientation of each HST.

4. Sew the HSTs together in each row. Press the seams toward the dark triangles.

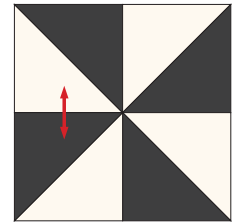
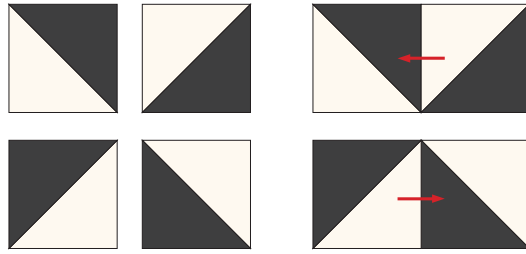

Block A - Make 46

5. Join the rows. Press the seam open to make a 6 1/2" x 6 1/2" Block A. Make a total of (46).

Making Block B:

1. Sew (2) 2" x 3 1/2" R540398-Gray (R540398-Gray) rectangles to opposite sides of (1) 3 1/2" x 3 1/2" R540398-Cream (R540398-Cream) square. Press the seams toward the gray rectangles.

2. Sew (2) 2" x 6 1/2" R540398-Gray (R540398-Gray) rectangles to the top and bottom of the unit. Press the seams toward the gray rectangles to make a 6 1/2" x 6 1/2" Block B. Make a total of (45).

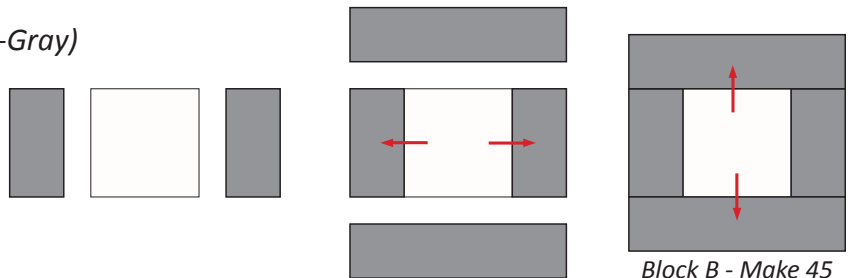

Block B - Make 45

Making Block C:

1. Sew (1) R540394-Taupe (R540395-Gray) triangle to the right of (1) R540397-Chalk (R540398-Charcoal) triangle as shown. Press the seam toward the dark triangle. Make a total of (4) two-piece triangles.

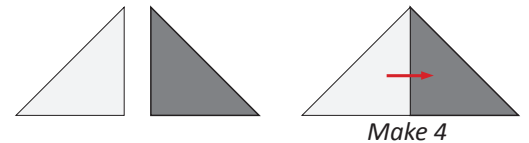

Make 4



Make 4

2. Sew the long side of (1) two-piece triangle to the long side of (1) R540393-Charcoal (R540393-Cream) triangle. Press the seam open and trim, if needed to make a 9 1/2" x 9 1/2" quarter-block. Make (4) quarter-blocks.

3. Lay out the (4) quarter-blocks in two rows of two quarter-blocks each, noting the orientation of each quarter-block.

4. Sew the quarter-blocks together in each row. Press the seams toward the large triangles.

5. Join the rows. Press the seam open to make an 18 1/2" x 18 1/2" Block C. Make (1).

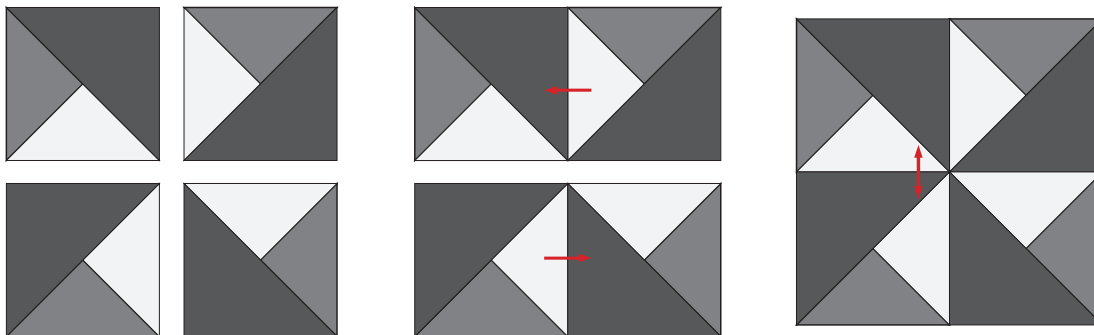

Block C - Make 1

Steelworks

Assembling the Quilt Top:

Refer to the Quilt Top Assembly diagram below.

1. Lay out (35) A blocks, alternating with (35) B blocks in seven rows as shown.
2. Sew the A and B blocks together in each row. Press the seams toward the B blocks.
3. Join the rows. Press the seams open to make a $42\frac{1}{2}$ " x $60\frac{1}{2}$ " quilt top section.
4. Lay out (11) A blocks, alternating with (10) B blocks in three rows as shown.
5. Sew the A and B blocks together in each row. Press the seams toward the B blocks.
6. Join the rows. Press the seams open to make an $18\frac{1}{2}$ " x $42\frac{1}{2}$ " unit.
7. Sew Block C to the right end of the $18\frac{1}{2}$ " x $42\frac{1}{2}$ " unit. Press the seam open to make an $18\frac{1}{2}$ " x $60\frac{1}{2}$ " quilt bottom section.
8. Sew quilt top section to the quilt bottom section. Press the seam open to make a $60\frac{1}{2}$ " x $60\frac{1}{2}$ " quilt top.

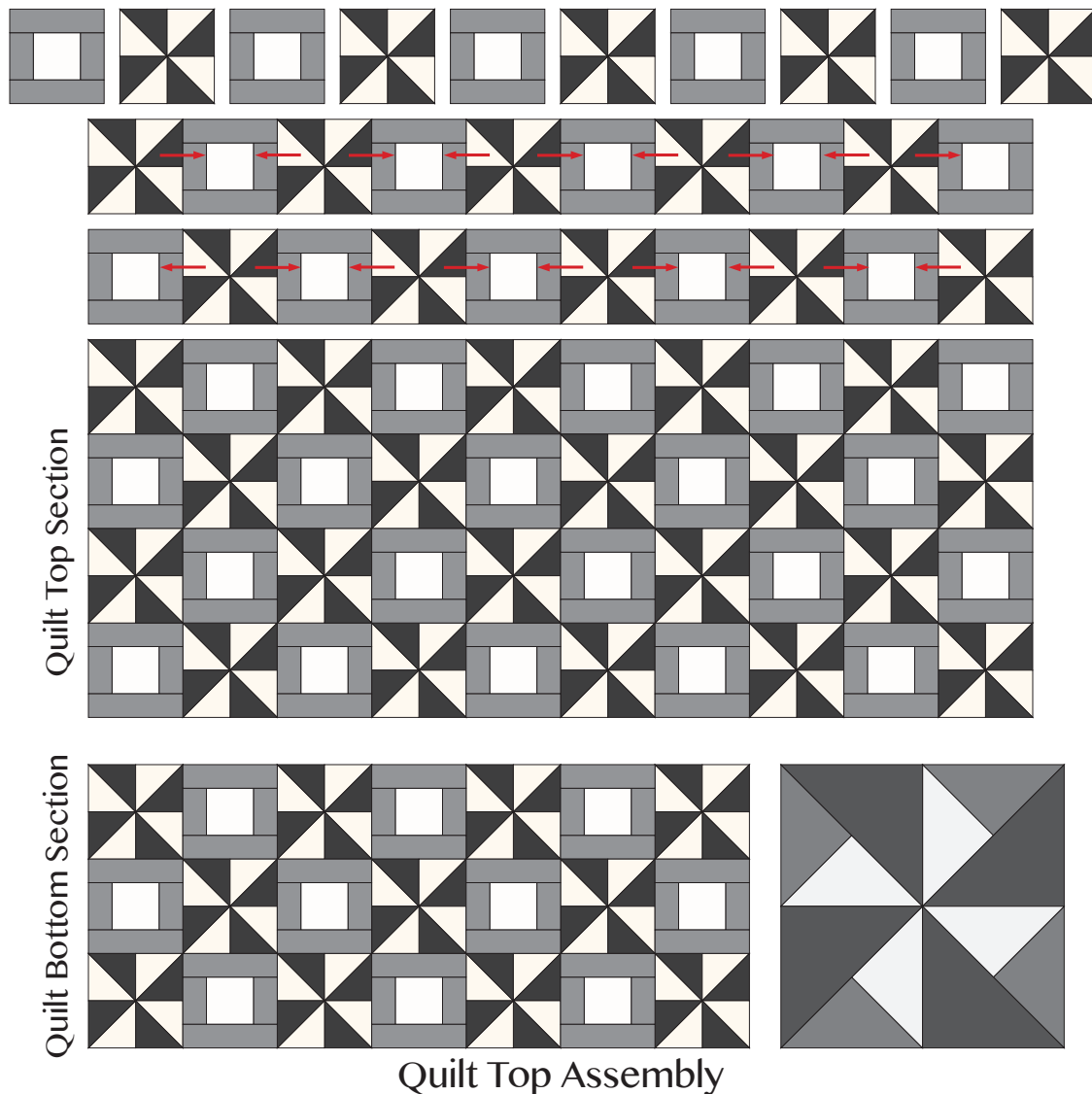

Steelworks

Adding the Borders:

Border One

1. Sew the short ends of (7) $3\frac{1}{2}$ " x WOF R540398-Charcoal (*R540394-Taupe*) strips together to make a long border one strip.
2. Crosscut the long strip into (2) $60\frac{1}{2}$ " lengths and (2) $66\frac{1}{2}$ " lengths.
3. Sew the $60\frac{1}{2}$ " lengths to opposite sides of the quilt top. Press the seams toward the border one strips.
4. Sew the $66\frac{1}{2}$ " lengths to the remaining sides of the quilt top. Press the seams toward the border one strips. Quilt top measures $66\frac{1}{2}$ " & $66\frac{1}{2}$ ".

Border Two

1. Cut (2) $8\frac{1}{2}$ " x LOF R540393-Cream (*R540393-Charcoal*) border two strips to measure $66\frac{1}{2}$ ". Sew the $66\frac{1}{2}$ " lengths to opposite sides of the quilt top. Press the seams toward the border two strips.
2. Cut (2) $8\frac{1}{2}$ " x LOF R540393-Cream (*R540393-Charcoal*) border two strips to measure $82\frac{1}{2}$ ". Sew the $82\frac{1}{2}$ " lengths to the remaining sides of the quilt top. Press the seams toward the border two strips to make an $82\frac{1}{2}$ " x $82\frac{1}{2}$ " quilt.

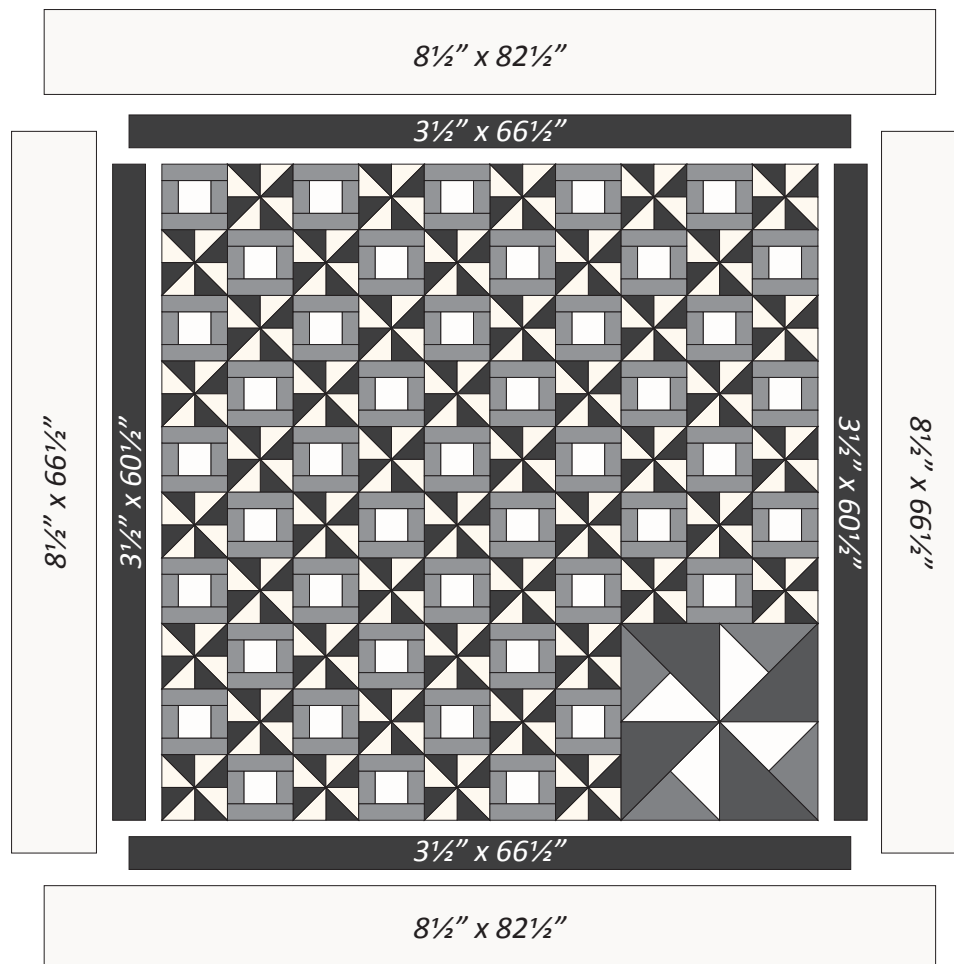

Finishing:

1. Layer the quilt, batting and backing. Quilt as desired.
2. Bind the quilt with double-fold binding made with the (9) $2\frac{1}{4}$ " x WOF R540398-Charcoal (*R540394-Taupe*) binding strips.