

MAGICAL WINTER RUNNER



16 ½" × 48 ½"

Magical by Lisa Audit ART
Winterland



MAGICAL WINTER RUNNER

FINISHED PROJECT SIZE 16 ½" × 48 ½"

Please read all instructions before beginning this project.
Yardage calculated using a 42" usable width of fabric.

GENERAL INSTRUCTIONS

Please check www.rileyblakedesigns.com/pattern-updates for any revisions before starting this project. This pattern requires a basic knowledge of quilting techniques and terminology. The project and block diagrams portrayed are virtual images. The layout and look of your project may differ when using actual fabric. It is not recommended to prewash fabric before cutting and assembling.

WOF = Width of Fabric
RST = Right Sides Together
SNF = Stitch and Flip
FG = Flying Geese
HST = Half Square Triangle

FABRIC REQUIREMENTS

All fabrics from the Magical Winterland collection unless stated otherwise.

¼ yard C14943-BLUE Foliage
¼ yard C14948-BARNRED Gingham
½ yard C14944-SNOW Snowflake
⅝ yard C14942-SNOW Winter Scene
⅝ yard C14944-WINTER Snowflake (includes binding)

OTHER SUPPLIES

Basic Sewing Supplies
⅓ yard Wide Back backing fabric of your choice
(suggested WB14949-BLUE Snowflake Wide Back)
Batting

CUTTING INSTRUCTIONS

When cutting fabrics, use a straight edge ruler and rotary cutter. Measurements include ¼" seam allowance. Label, allocate, and organize all cuts as noted.

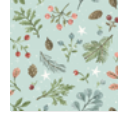

Blue Foliage

Cut (1) 4 ½" × WOF strip; subcut:
(3) 4 ½" × 4 ½" squares. Label as A.
(4) 2 ½" × 4 ½" rectangles. Label as B.
(4) 2 ½" × 2 ½" squares. Label as C.

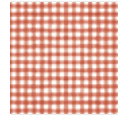

Barn Red Gingham

Cut (2) 2 ½" × WOF strips; subcut:
(24) 2 ½" × 2 ½" squares. Label as D.



Snow Snowflake

Cut (1) 5 ⅜" × WOF strip; subcut:
(4) 5 ⅜" × 5 ⅜" squares. Label as E.
Cut (1) 3" × WOF strip; subcut:
(8) 3" × 3" squares. Label as F.
Cut (2) 2 ½" × WOF strips; subcut:
(24) 2 ½" × 2 ½" squares. Label as G.



Snow Winter Scene

Cut (1) 8 ½" × WOF strip; subcut:
(2) 8 ½" × 8 ½" squares. Label as H.
(2) 4 ½" × 8 ½" rectangles. Label as I.*
Cut (2) 4 ½" × WOF strips; subcut:
(6) 4 ½" × 8 ½" rectangles. Label as J.*



Winter Snowflake

Cut (2) 3" × WOF strips; subcut:
(24) 3" × 3" squares. Label as K.
Cut (4) 2 ½" × WOF strips. Set aside for binding.

*Fabric cuts marked with an asterisk should be cut directionally. Pay close attention to orientation when cutting. See steps 1-4 and the runner layout diagram on page 5 for proper placement.

MAGICAL WINTER RUNNER

SEWING TECHNIQUES

All seams should be sewn with a $\frac{1}{4}$ " seam allowance unless stated otherwise. Sew with RST unless stated otherwise. Refer to the quilt layout diagram for placement of the prints. Press seams as desired unless stated otherwise. Dimensions listed in steps are unfinished sizes unless stated otherwise. Please refer to the following general sewing techniques as these methods are referenced throughout the pattern in their abbreviated form.

STITCH AND FLIP METHOD (SNF)

Place (2) pieces RST, matching raw edges in the corner to be replaced. Draw a diagonal line on the wrong side of the smaller piece across the corner. Stitch on the drawn line. Trim the seam allowance outside the sewn line to $\frac{1}{4}$ ". Flip the smaller piece away from the larger piece and press, replacing the corner. The size of the larger, original piece does not change.

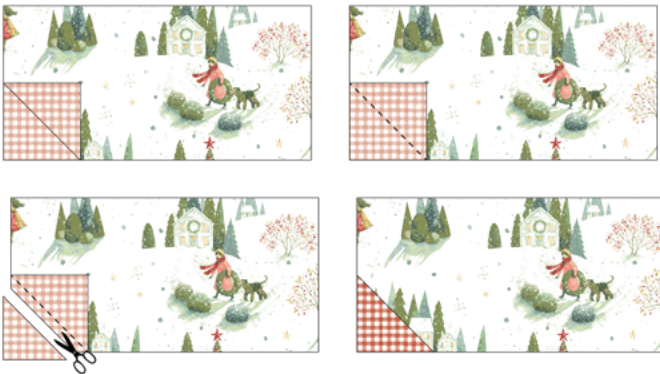

2-AT-A-TIME HALF SQUARE TRIANGLE METHOD (HST)

Place (2) squares RST. Draw a diagonal line on the wrong side of (1) square. Stitch $\frac{1}{4}$ " on each side of the drawn line. Cut on the drawn line to create (2) HSTs. Press toward the darker fabric. Trim HSTs to desired size.

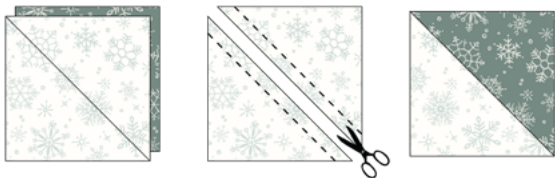

4-AT-A-TIME FLYING GEESE METHOD (FG)

Gather (1) large square and (4) smaller squares. Draw a diagonal line from corner to corner on the wrong side of each of the smaller squares. Place (2) smaller squares, RST, diagonally on the larger square, matching raw edges in the corners. The smaller squares will overlap and the diagonal lines should form one long line. Sew $\frac{1}{4}$ " on each side of the drawn line. Cut on the drawn line. Flip the smaller triangles away from the bottom triangle and press. Take (1) sub unit just created and place (1) small square, RST, on the larger square, matching raw edges in the corner. Sew $\frac{1}{4}$ " on each side of the drawn line. Cut on the drawn line. Repeat with the remaining sub unit and small square. Press and trim to the desired size.

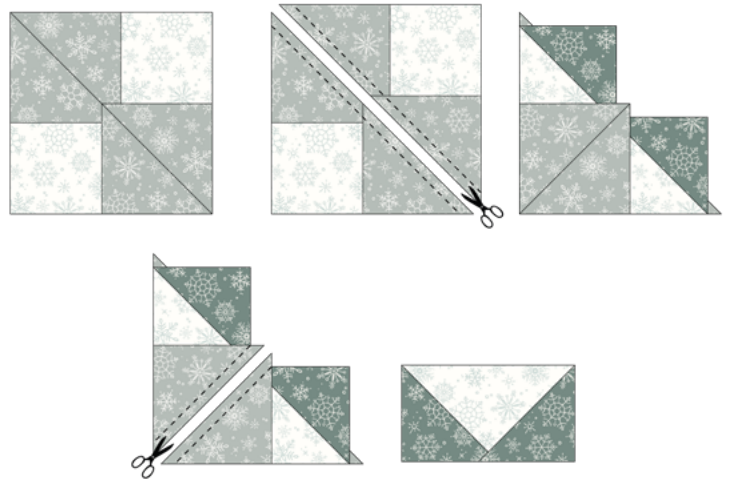

BLOCK ASSEMBLY

1. Using the SNF method, replace the bottom corners of (1) **J**-rectangle with (2) **D**-squares, referencing the diagram for proper placement and orientation. Make (3) total units.



Make (3)
4 $\frac{1}{2}$ " x 8 $\frac{1}{2}$ "

2. Using the SNF method, replace the top corners of (1) **J**-rectangle with (2) **D**-squares, referencing the diagram for proper placement and orientation. Make (3) total units.



Make (3)
4 $\frac{1}{2}$ " x 8 $\frac{1}{2}$ "

MAGICAL WINTER RUNNER

3. Using the SNF method, replace the top and bottom left corners of (1) **I**-rectangle with (2) **D**-squares, referencing the diagram for proper placement and orientation.



4. Using the SNF method, replace the top and bottom right corners of (1) **I**-rectangle with (2) **D**-squares, referencing the diagram for proper placement and orientation.



5. Using the SNF method, replace the corners of (1) **H**-square with (4) **D**-squares, referencing the diagram for proper placement and orientation. Make (2) total units.



6. Gather all of the **F**-squares and (8) **K**-squares and use the 2-at-a-time HST method to create the units shown below. Trim to 2 1/2" x 2 1/2". Make (16) total HST Units.



7. Gather all of the **E**-squares and remaining **K**-squares and use the FG method to create the FG units shown below. Trim to 2 1/2" x 4 1/2". Make (16) total FG units.



8. Gather (1) **C**-square, (1) **G**-square, and (2) HSTs. Sew together to create the block shown below, which should measure 4 1/2" x 4 1/2". Make (4) total blocks.

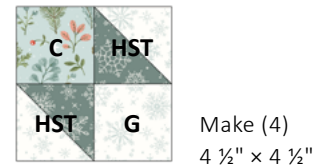

9. Gather (1) **B**-rectangle, (2) **G**-squares, (2) HSTs, and (1) FG unit. Sew together to create the block shown below, which should measure 4 1/2" x 8 1/2". Make (4) total blocks.

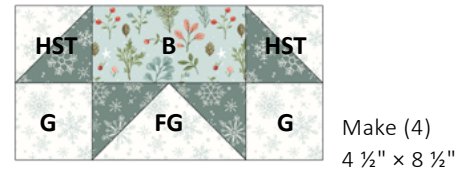

10. Gather (1) **A**-square, (4) **G**-squares, and (4) FG units. Sew together to create the block shown below which should measure 8 1/2" x 8 1/2". Make (3) total blocks.

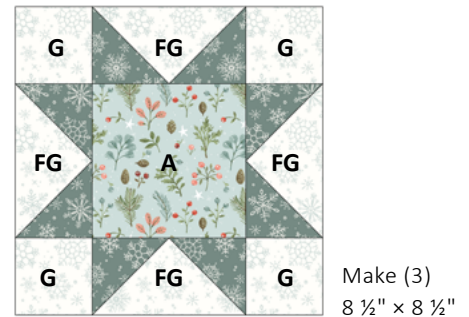

MAGICAL WINTER RUNNER

PROJECT ASSEMBLY

11. Arrange the blocks and units in (3) rows of (7) as shown below. Sew the blocks and units into rows, then sew the rows together to form the runner top, which should measure $16\frac{1}{2}'' \times 48\frac{1}{2}''$.



FINISHING INSTRUCTIONS

12. Finish your runner by layering the runner top, batting, and backing. Baste runner layers together and quilt as desired. Sew the Winter Snowflake binding strips together end-to-end. Then bind the trimmed, finished runner using your favorite binding method.

RUNNER LAYOUT DIAGRAM



$16\frac{1}{2}'' \times 48\frac{1}{2}''$

Enjoy and share your runner using the hashtags: [#magicalwinterlandfabric](#), [#magicalwinterrunner](#), [#rileyblakedesigns](#), and [#iloverileyblake](#).