

Bloomerang

••• A Free Project Sheet •••
••• NOT FOR RESALE •••

By Jane Shasky

Quilt Design by Heidi Pridemore



Quilt 2

Skill Level: Intermediate

 Henry Glass & Co., Inc.



facebook

Finished Quilt Size: 49" x 61"
(124.46 cm x 154.94 cm)

49 West 37th Street, New York, NY 10018

tel: 212-686-5194 fax: 212-532-3525

Toll Free: 800-294-9495

www.henryglassfabrics.net

Please check our website for pattern updates before starting this project.

BLOOMERANG Quilt 2

Finished Quilt Size: 49" x 61"
(124.46 cm x 154.94 cm)

Fabrics in the Collection



Packed Lilac
Multi - 954-56



Lilac Garden
Multi - 955-05



Vine
Green - 956-66



Tossed Lilac and Butterflies
Green - 957-65



Packed Flowers
Lavender - 958-55



Packed Flowers
Periwinkle - 958-75



Small Tossed Lilac and Butterflies
Multi - 959-05



Small Lilac Flower Tossed
Lilac - 960-05

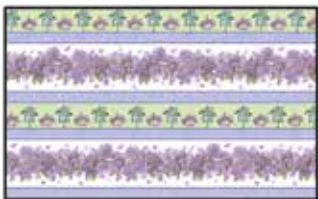

Border Stripe
Multi - 961-57



3 Blocks Panel 24 in x 44 in
Multi - 962P-05

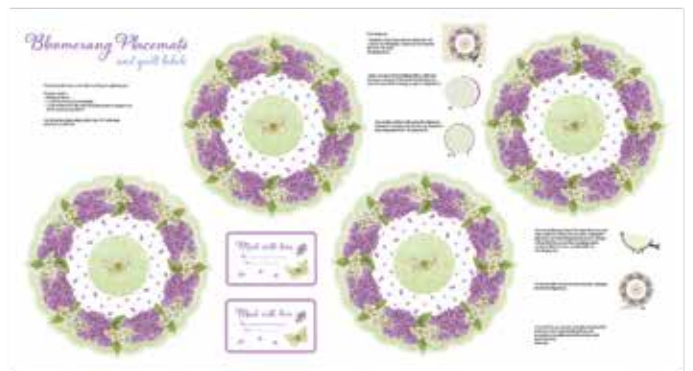

Placemats Panel 24 in x 44 in
Multi - 963P-05

Select Fabrics from Folio Basics



White on White
7755-01



Lilac
7755-05



Celery
7755-06



Light Violet
7755-56



Early Green
7755-62

BLOOMERANG

Quilt 2

Materials

7/8 yard (0.81 m)	Vine - Green (A)	956-66
7/8 yard (0.81 m)	Folio Basics - Light Violet (B)	7755-56
2/3 yard (0.61 m)	Small Lilac Flower Tossed - Lilac (C)	960-05
1/2 yard (0.46 m)	Packed Flowers - Lavender (D)	958-55
1/2 yard (0.46 m)	Folio Basics - Lilac (E)	7755-05
1/4 yard (0.23 m)	Tossed Lilac and Butterflies - Green (F)	957-55
7/8 yard (0.81 m)	Small Tossed Lilac and Butterflies - Multi (G)	959-05
1 yard (0.92 m)	Packed Flowers - Periwinkle (H)	958-75*
1/4 yard (0.23 m)	Packed Lilac - Multi (I)	954-56
1/2 yard (0.46 m)	Folio Basics - Early Green (J)	7755-62
4 yards (3.66 m)	Lilac Garden - Multi (Backing)	955-05

*Includes binding

Cutting Instructions

Please note: All strips are cut across the width of fabric (WOF) from selvage to selvage unless otherwise noted.

From the Vine - Green (A), cut:

- (6) 4 1/2" x WOF strips. Sub-cut (54) 4 1/2" squares.

From the Folio Basics - Light Violet (B), cut:

- (6) 2 1/2" x WOF strips. Sub-cut (96) 2 1/2" squares.
- (3) 2" x WOF strips. Sew the strips together end to end with diagonal seams and cut (2) 2" x 48 1/2" strips.
- (2) 2" x 39 1/2" WOF strips.

From the Small Lilac Flower Tossed - Lilac (C), cut:

- (8) 2 1/2" x WOF strips. Sub-cut (120) 2 1/2" squares.

From the Packed Flowers - Lavender (D), cut:

- (3) 4 1/2" x WOF strips. Sub-cut (24) 4 1/2" squares.

From the Folio Basics - Lilac (E), cut:

- (5) 2 1/2" x WOF strips. Sub-cut (72) 2 1/2" squares.

From the Tossed Lilac and Butterflies - Green (F), cut:

- (1) 5 1/2" x WOF strip. Sub-cut (4) 5 1/2" squares.

From the Small Tossed Lilac and Butterflies - Multi (G), cut:

- (3) 5 1/2" x WOF strips. Sew the strips together end to end with diagonal seams and cut (2) 5 1/2" x 51 1/2" strips.
- (2) 5 1/2" x 39 1/2" WOF strips.

From the Packed Flowers - Periwinkle (H), cut:

- (3) 4 1/2" x WOF strips. Sub-cut (24) 4 1/2" squares.
- (6) 2 1/2" x WOF strips for the binding.

From the Packed Lilac - Multi (I), cut:

- (1) 4 1/2" x WOF strip. Sub-cut (6) 4 1/2" squares.

From the Folio Basics - Early Green (J), cut:

- (5) 2 1/2" x WOF strips. Sub-cut (72) 2 1/2" squares.

From the Lilac Garden - Multi (Backing), cut:

- (2) 69" x WOF strips for the backing. Sew the strips together and trim to make the 57" x 69" back.

Block Assembly

Note: Pay attention to the unit orientations when assembling the various components. Use a 1/4" seam allowance with right sides together (RST) unless otherwise noted.

1. Place (1) 2 1/2" Fabric E square on the top left corner of (1) 4 1/2" Fabric D square, right sides together (Fig. 1). Sew across the diagonal of the smaller square from the upper right corner to the lower left corner (Fig. 1). Flip open the triangle formed and press. Trim away the excess fabric from behind the triangle 1/4" away from the sewn seam (Fig. 2).

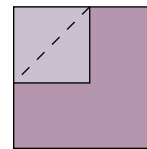

Fig. 1

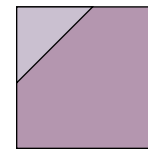

Fig. 2

2. Follow Figure 3 for the seam direction to add a 2 1/2" Fabric E square to the upper right corner and 2 1/2" Fabric C squares to the lower left and lower right corners of the 4 1/2" Fabric D square to make (1) Unit 1 square (Fig. 4).

3. Repeat Steps 1-2 to make (24) Unit 1 squares total.

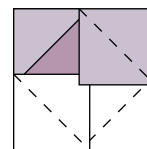

Fig. 3

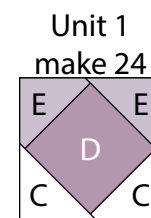

Fig. 4

BLOOMERANG

Quilt 2

4. Repeat Steps 1-2 and refer to Figures 5-9 for fabric identification, placement and seam direction to make (6) Unit 2 squares, (24) Unit 3 squares, (6) Unit 4 squares, (24) Unit 5 squares and (24) Unit 6 squares.

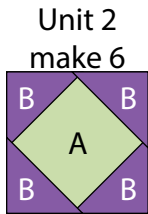

Fig. 5

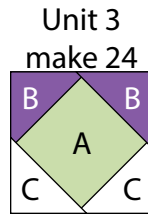

Fig. 6

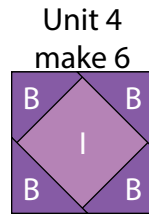

Fig. 7

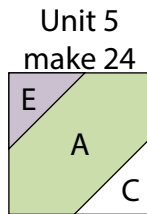

Fig. 8

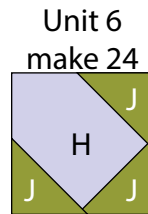

Fig. 9

5. Sew (1) Unit 5 square to each side of (1) Unit 1 square to make the top row. Repeat to make the bottom row. Sew (1) Unit 1 square to each side of (1) Unit 2 square to make the middle row. Sew together the (3) rows lengthwise to make (1) 12 1/2" Block One square (Fig. 10). Repeat to make (6) Block One squares total.

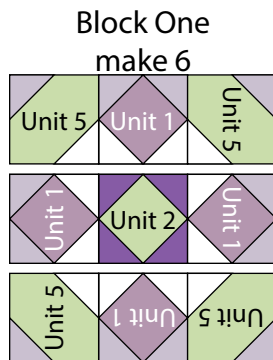

Fig. 10

6. Repeat Step 5 and refer to Figure 11 for component identification, placement and orientation to make (6) Block Two squares.

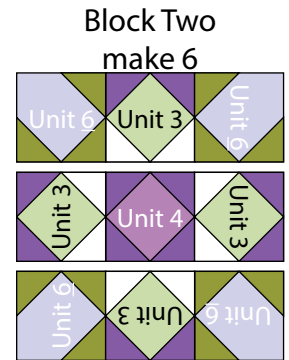

Fig. 11

7. Sew (1) Block One square to each side of (1) Block Two square to make Row One (Fig. 12). Repeat to make Row Three.

8. Sew (1) Block Two square to each side of (1) Block One square to make Row Two (Fig. 12). Repeat to make Row Four.

9. Sew together the (4) Rows, lengthwise and in numerical order from top to bottom, to make the 36 1/2" x 48 1/2" Center Block (Fig. 12).

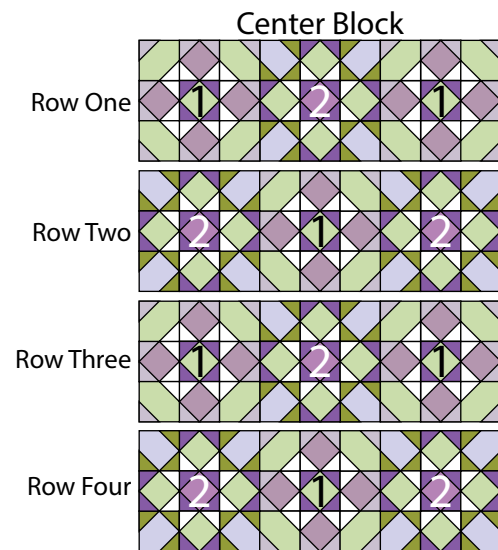

Fig. 12

BLOOMERANG

Quilt 2

Quilt Top Assembly

(Follow the Quilt Layout while assembling the quilt top.)

10. Sew (1) 2" x 48 1/2" Fabric B strip to each side of the Center Block. Sew (1) 2" x 39 1/2" Fabric B strip to the top and to the bottom of the Center Block.

11. Sew (1) 5 1/2" x 51 1/2" Fabric G strip to each side of the Center Block.

12. Sew (1) 5 1/2" Fabric F square to each end of (1) 5 1/2" x 39 1/2" Fabric G strip. Repeat to make a second strip. Sew the strips to the top and to the bottom of the Center Block to make the quilt top.

13. Layer and quilt as desired.

14. Sew the (6) 2 1/2" x WOF Fabric H strips together, end to end with 45-degree seams, to make the binding. Fold this long strip in half lengthwise with wrong sides together and press.

15. Bind as desired.

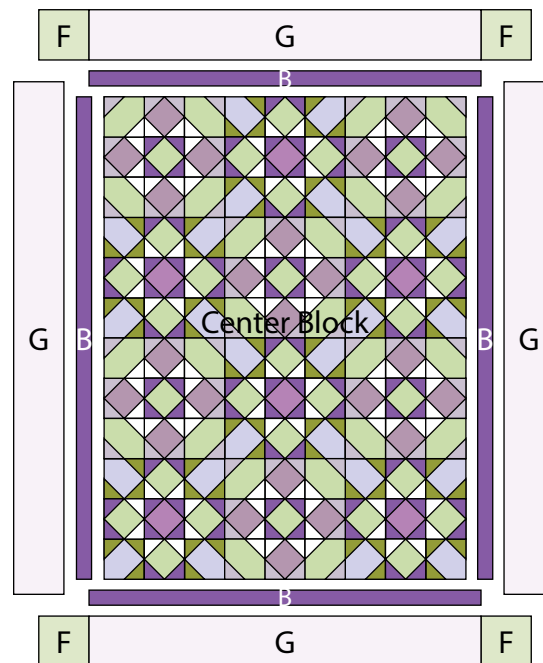

Quilt Layout

Every effort has been made to ensure that all projects are error free. All the information is presented in good faith, however no warranty can be given nor results guaranteed as we have no control over the execution of instructions. Therefore, we assume no responsibility for the use of this information or damages that may occur as a result. When errors are brought to our attention, we make every effort to correct and post a revision as soon as possible. Please make sure to check www.henryglassfabrics.net for pattern updates prior to starting the project. We also recommend that you test the project prior to cutting for kits. Finally, all free projects are intended to remain free to you and are not for resale.