

free pattern

Benartex **TRADITIONS**

THE DRAWING ROOM BY PAT SLOAN



My Blue Heaven

by Stephanie Sheridan
(62" x 82")

CUTTING INSTRUCTIONS

WOF = Width of fabric | HST = Half Square Triangle | QST = Quarter Square Triangle

**Sew strips via short ends, then subcut as indicated in pattern*

	COMFY CHAIR A 17707-50 <i>Blue</i>	1 YD	(4) 7-5/8" x WOF strips, subcut (17) 7-5/8" squares and (4) 5-1/2" squares
	PARQUET FLOOR B 17008-11 <i>Navy</i>	5/8 YD	(1) 6-1/4" x WOF strip, subcut (3) 6-1/4" squares, crosscut twice for (12) QST (1) 5-7/8" x WOF strip, subcut (6) 5-7/8" squares, crosscut once for (12) HST (1) 4-7/8" x WOF strip, subcut (6) 4-7/8" squares, crosscut once for (12) HST
	AFTER DINNER MINT C 17009-50 <i>Blue</i>	5/8 YD	(1) 6-1/4" x WOF strip, subcut (3) 6-1/4" squares, crosscut twice for (12) QST (1) 5-7/8" x WOF strip, subcut (6) 5-7/8" squares, crosscut once for (12) HST (1) 4-7/8" x WOF strip, subcut (6) 4-7/8" squares, crosscut once for (12) HST
	DECANTOR D 17010-50 <i>Blue</i>	1-7/8 YDS	(1) 6-1/4" x WOF strip, subcut (3) 6-1/4" squares, crosscut twice for (12) QST (1) 5-7/8" x WOF strip, subcut (6) 5-7/8" squares, crosscut once for (12) HST (1) 4-7/8" x WOF strip, subcut (6) 4-7/8" squares, crosscut once for (12) HST (7) 5-1/2" x WOF strips *, BORDER
	GOOD BOOKS E 17011-11 <i>Navy</i>	1/2 YD	(1) 6-1/4" x WOF strip, subcut (3) 6-1/4" squares, crosscut twice for (12) QST and (4) 4-7/8" squares, crosscut once for (8) HST (1) 5-7/8" x WOF strip, subcut (6) 5-7/8" squares, crosscut once for (12) HST
	SIDE TABLE F 17012-09 <i>Ivory</i>	1-3/4 YDS	(3) 6-1/4" x WOF strips, subcut (18) 6-1/4" squares, crosscut twice for (72) QST (17) 1-1/4" x WOF strips, subcut (68) 1-1/4" x 9" strips (8) 1-1/2" x WOF strips *, BORDER
	SIDE TABLE G 17012-50 <i>Blue</i>	1-1/4 YDS	(1) 6-1/4" x WOF strip, subcut (3) 6-1/4" squares, crosscut twice for (12) QST (1) 5-7/8" x WOF strip, subcut (6) 5-7/8" squares, crosscut once for (12) HST (1) 4-7/8" x WOF strip, subcut (6) 4-7/8" squares, crosscut once for (12) HST
	TEA TABLE H 17013-50 <i>Blue</i>	5/8 YD	(1) 6-1/4" x WOF strip, subcut (3) 6-1/4" squares, crosscut twice for (12) QST (1) 5-7/8" x WOF strip, subcut (6) 5-7/8" squares, crosscut once for (12) HST (1) 4-7/8" x WOF strip, subcut (6) 4-7/8" squares, crosscut once for (12) HST

UNIT ASSEMBLY: *Refer to UNIT DIAGRAMS*

- Sew (1) F QST and (1) D QST together, then add (1) B 5-7/8" HST to create UNIT 1. Square to 5-1/2", make (2).
- Repeat step 1 using QSTs and HSTs shown to create remaining UNITS. Square all to 5-1/2", make number indicated.

UNIT DIAGRAMS

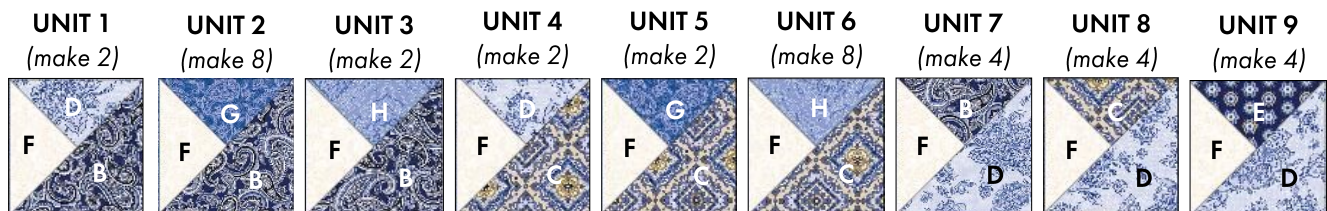
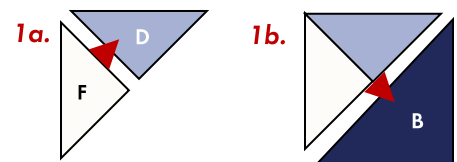

UNIT DIAGRAMS (continued)

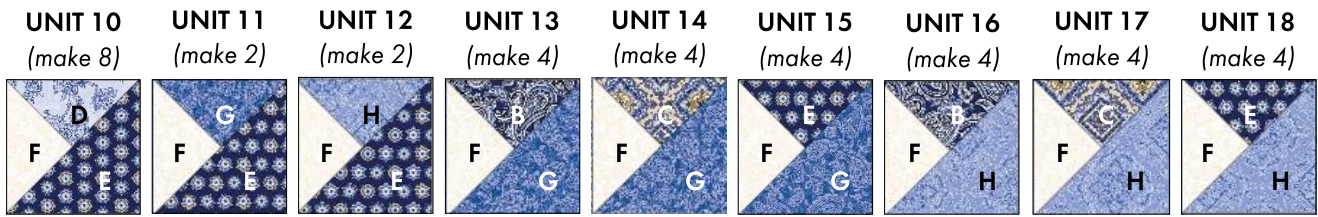

BLOCK 1 ASSEMBLY: Refer to BLOCK DIAGRAMS

- Sew (1) each UNITS 2, 7, 10 and 15 together to create BLOCK 1A, being sure to note rotation of each unit. Square to 10-1/2", make (4).
- Repeat step 3 using UNITS labeled below to create remaining BLOCKS. Square all to 10-1/2", make number indicated.

BLOCK 1 DIAGRAMS

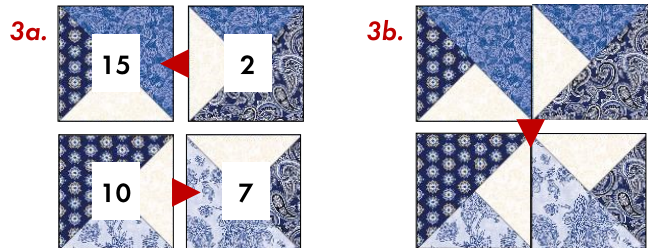

BLOCK 1A
make (4)

BLOCK 1B
make (4)

BLOCK 1C
make (4)

BLOCK 1D
make (2)

BLOCK 1E
make (2)

BLOCK 1F
make (2)



BLOCK 2 ASSEMBLY: Refer to BLOCK DIAGRAMS

- Find center of (1) B 4-7/8" HST and (1) F 1-1/4" x 9" strip. Match centers and sew together, then press open. Trim F ends as shown to complete BF HST, make (12).
- Sew (2) BF HSTs to opposing sides of (1) A 7-5/8" square, press, then repeat on remaining sides to create BLOCK 2A. Square to 10-1/2" (ensuring that there is 1/4" seam allowance beyond the A square points), make (3).
- Repeat steps 5 and 6 using F 1-1/4" x 9" strips, A 7-5/8" squares and 4-7/8" HSTs as labeled below to create remaining blocks. Square all to 10-1/2", make number indicated.

BLOCK 2 DIAGRAMS

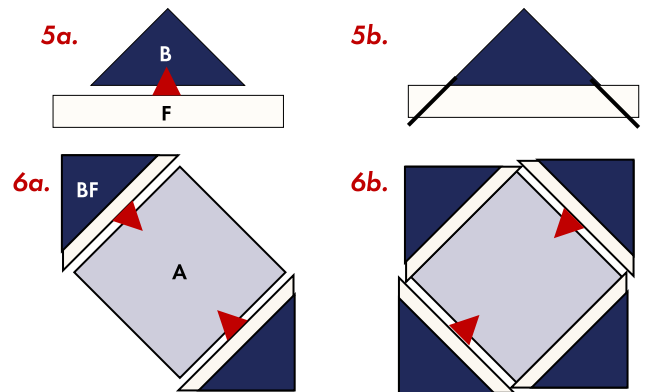

BLOCK 2A
make (3)

BLOCK 2B
make (3)

BLOCK 2C
make (3)

BLOCK 2D
make (3)

BLOCK 2E
make (3)

BLOCK 2F
make (2)

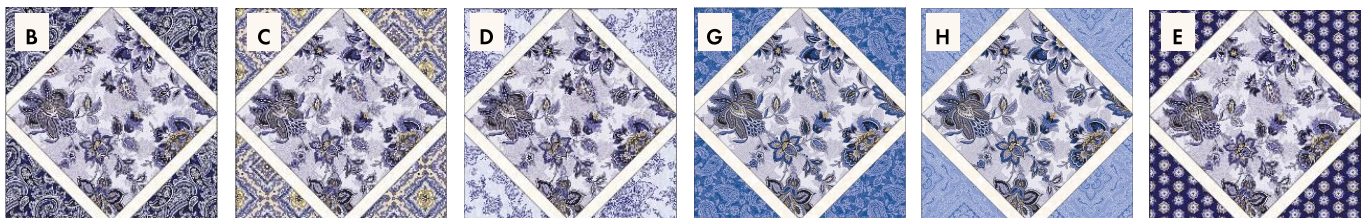

QUILT ASSEMBLY: Refer to **QUILT DIAGRAM** for proper placement and rotation.

8. Sew blocks together into rows, then sew rows together.

ROW 1: 1A–2A–1B–2B–1C

ROW 2: 2C–1D–2D–1E–2E

ROW 3: 1C–2F–1A–2A–1B

ROW 4: 2E–1F–2C–1D–2D

ROW 5: 1B–2B–1C–2F–1A

ROW 6: 2D–1E–2E–1F–2C

ROW 7: 1A–2A–1B–2B–1C

BORDER ASSEMBLY: Measure width and length of quilt top to ensure border cutting sizes. Below are our measurements. Refer to **QUILT DIAGRAM** for proper placement and rotation.

9. Sew (1) F 1-1/2" x (70-1/2") strip and (1) D 5-1/2" x (70-1/2") strip together to create **SIDE BORDER UNIT**, make (2). Sew to sides of quilt.

10. Sew together (2) A 5-1/2" squares, (2) F 1-1/2" x (5-1/2") strips and (1) D 5-1/2" x (50-1/2") strip, then sew (1) F 1-1/2" x (62-1/2") strip to bottom to create **TOP/BOTTOM BORDER UNIT**, make (2). Sew to top and bottom of quilt.

FINISHING:

Cut batting and backing 3" larger than top on all sides. Layer backing, batting and top together and baste or pin. When quilting is completed, trim excess batting and backing. Bind with G fabric.

Note: If this Benartex pattern is included in a kit, any questions about the kit should be addressed to the vendor from whom you bought it.

Share your finished quilt with the Benartex Community on social media by tagging **#benartex** or **#benartexfabrics**



Also visit our Sewing Group on Facebook,
Create Inspire Delight

MY BLUE HEAVEN
 QUILT DIAGRAM
 SIZE: 62" x 82"

