

Honey for Sale

SIZE: 46" x 61-1/2" • LEVEL: Intermediate • PATTERN BY: MARSHA EVANS MOORE
• FABRIC COLLECTION: Bee Culture



THIS IS A DIGITAL REPRESENTATION OF THE QUILT TOP, FABRIC MAY VARY.

PLEASE NOTE: BEFORE BEGINNING YOUR PROJECT, CHECK FOR ANY PATTERN UPDATES AT MICHAELMILLERFABRICS.COM'S FREE PROJECTS SECTION.

Honey for Sale



FABRIC A
DCX11251_Green
1/4 yard



FABRIC B
DCX11252_Lilac
1/4 yard



FABRIC C
DCX11253_Multi
3/4 yard



FABRIC D
DCX11254_Multi
3/8 yard



FABRIC E
DCX11255_Brown
1/8 yard



FABRIC F
DCX11256_Blue
3/4 yard



FABRIC G
DCX11257_Yellow
3/8 yard



FABRIC H
DCX11260_Panel
1 Panel



FABRIC I
DCX10060_Clementine
3/4 yard



FABRIC J
DCX10060_Caramel
3/8 yard



FABRIC K
Sc5333_Soft White
3/8 yard



Honey for Sale

KEY	CUTTING INSTRUCTIONS
A	(5) Hexagon Templates.
B	(5) Hexagon Templates.
C	Centered on wide stripe, <i>fussy cut</i> : (5) 4" x 19-1/2" strips; sew ends together matching print. Subcut (2) 4" x 42" borders.
D	(4) 2" x 42" strips; sew ends together. Subcut (2) 2" x 47-1/2" strips and (2) 2" x 30-1/2" strips.
E	(1) 2-1/2" x 42" strip; subcut (8) 2-1/2" squares.
F	(9) 2-1/2" x 42" strips; sew ends together. Subcut (2) 2-1/2" x 57-1/2" borders, (2) 2-1/2" x 42" borders, (2) 2-1/2" x 43-1/2" borders and (2) 2-1/2" x 23-1/2" borders.
G	(10) Hexagon Templates.
H	Centering panel, <i>fussy cut</i> : (1) 23-1/2" x 43-1/2" rectangle.
I	FOR BINDING: (6) 2-1/4" x 42" strips, sew short ends together. (6) 1" x 42" strips; subcut (20) Frame 1 Templates, (20) Frame 2 Templates and (20) Frame 3 Templates.
J	(6) 1" x 42" strips; subcut (20) Frame 1 Templates, (20) Frame 2 Templates and (20) Frame 3 Templates.
K	(4) 2-1/4" x 42" strips; subcut (40) Triangle Templates and (40) Triangle Templates reversed.
	Batting 54" x 69"

ADDITIONAL MATERIALS

3 yards backing fabric
Thread to match fabrics
Basic sewing supplies

Sewing machine
Rotary cutter, ruler and mat

Template plastic

Honey for Sale

PATCHWORK BORDER

1. Sew (2) **J** Frame 1 to upper left and lower right sides of (1) **G** Hexagon.
2. Sew (2) **J** Frame 2 to upper right and lower left sides of the **G** Hexagon.
3. Sew (2) **J** Frame 3 to top and bottom of **G** Hexagon to make hexagon unit.
4. Sew (2) **K** Triangles to upper left and lower right sides of the hexagon unit.
5. Sew (2) **K** Triangles reversed to upper right and lower left of the hexagon unit to make a rectangle. **G/J** block should measure 5-1/2" x 6-1/4" including seam allowance. Make 10.

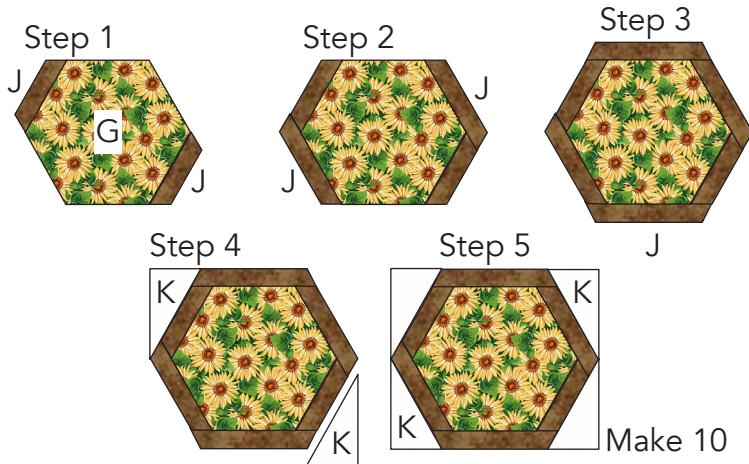

6. Following steps 1-5, make blocks using **A** and **B** Hexagons and **I** Frames 1-3. Make 5 each.



7. Sew together (5) **G/J** blocks alternating with (3) **B/I** blocks and (2) **A/I** blocks to make the left border. Make 1.
8. Sew together (5) **G/J** blocks alternating with (3) **A/I** blocks and (2) **B/I** blocks to make the right border. Borders should measure 6-1/4" x 50-1/2" including seam allowance. Make 1.

Make 1 each

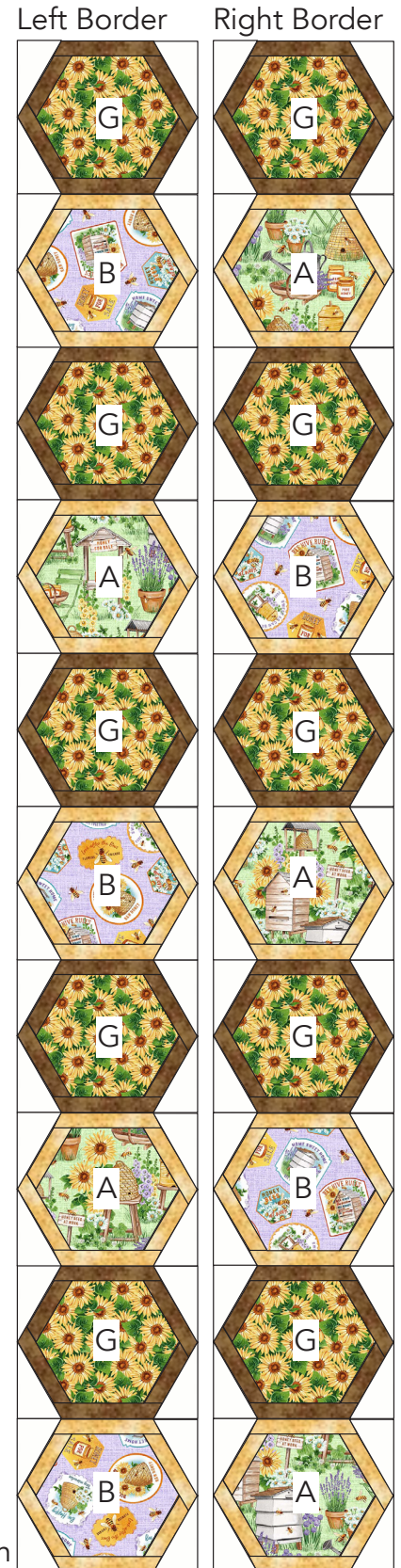



Honey for Sale

QUILT ASSEMBLY

9. Following the Quilt Layout on page 5, sew (1) **F** 2-1/2" x 43-1/2" border to each side of **H** center panel. Sew (2) **E** 2-1/2" squares to ends of (2) **F** 2-1/2" x 23-1/2" borders. Sew to top and bottom of quilt.

10. Sew (1) **D** 2" x 47-1/2" border to each side of quilt. Sew (2) **D** 2" x 30-1/2" borders to top and bottom of quilt.

11. Sew (1) left and (1) right patchwork border to sides of quilt.

12. Sew (2) **C** 4" x 42" borders to top and bottom of quilt.

13. Sew (1) **F** 2-1/2" x 57-1/2" border to each side of quilt. Sew (2) **E** 2-1/2" squares to ends of (2) **F** 2-1/2" x 42" borders. Sew to top and bottom of quilt.

Honey for Sale

Quilt Layout



FINISHING: Layer quilt top, batting and backing together to form quilt sandwich. Baste and quilt as desired. Bind using six fabric I 2-1/4" strips.

Honey for Sale

Templates

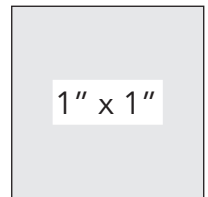
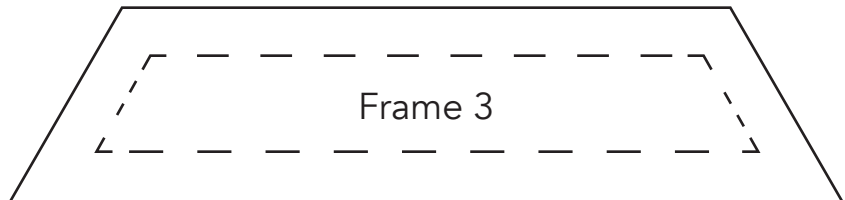
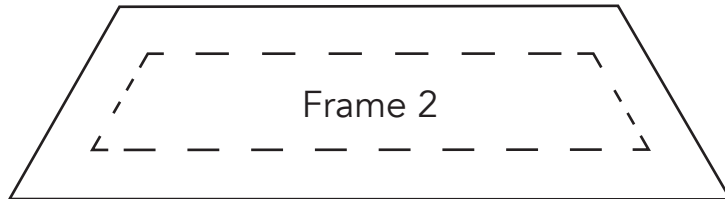
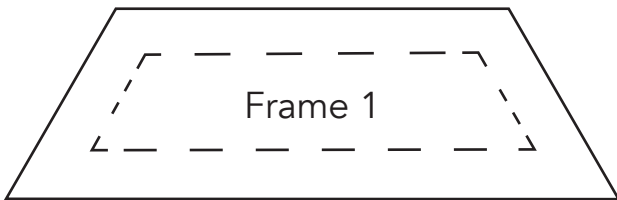
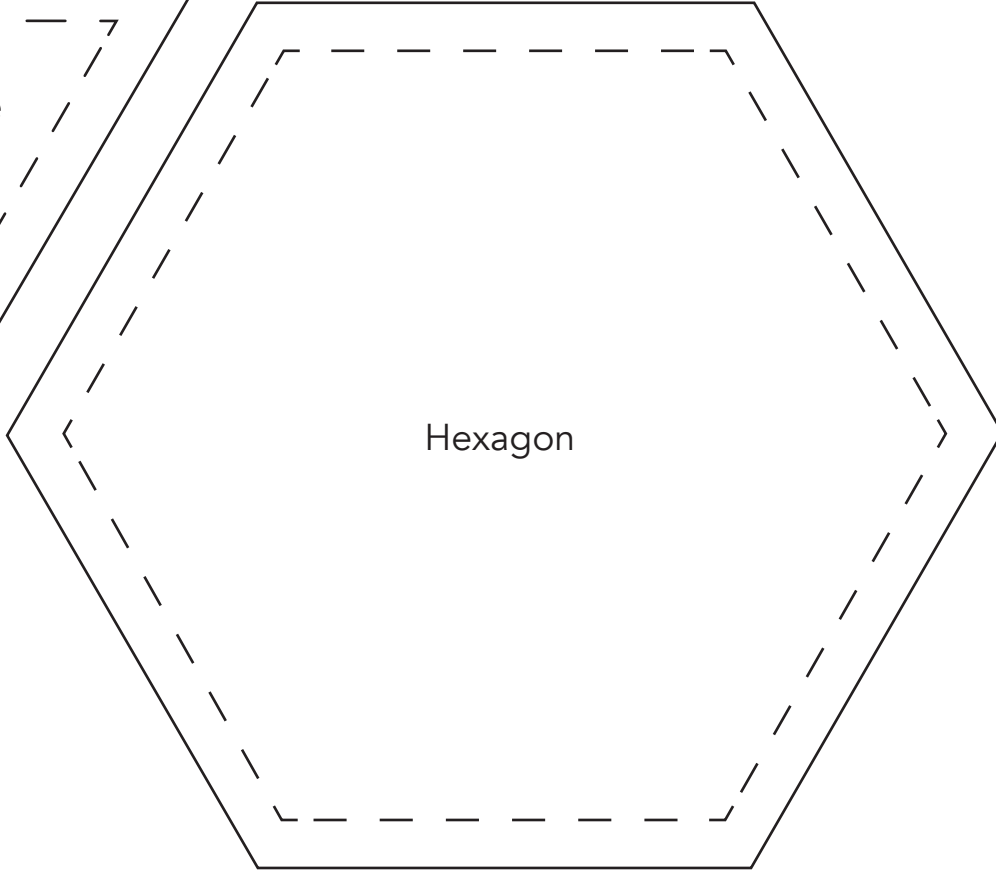
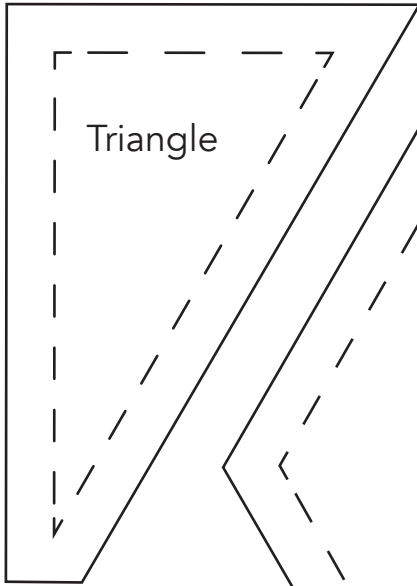

Print at 100%.