

# Pond Party

Featuring Paul's Pond Fabrics by the World of Susybee

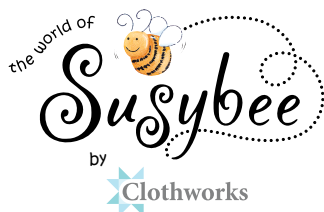

40" x 44"



BY WENDY SHEPPARD  
FOLLOW ON INSTAGRAM:  
@IVORY\_SPRING

# Pond Party

Crib Quilt featuring Paul's Pond by Susybee  
 Finished quilt size: 40" x 44"  
 Finished block size: 4" x 4" (star); 5" x 20" (cattail)  
 Backing: 42" x 52" (1 1/2y of 42" wide fabric)

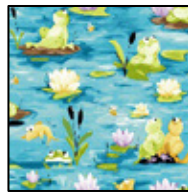





Prior to starting this project, please check our website for updates:  
[www.clothworks.com](http://www.clothworks.com)

SB20408-950 suggested

## Fabric and Cutting Chart

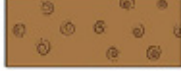
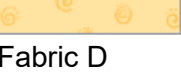
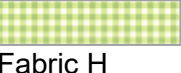
	Colorway 1	Colorway 2
 Fabric A SB20053-101	<p><b>3/4y</b></p> <p>a. Star block column                      (1) 1" x WOF strip.                      Subcut (2) 1" x 20 1/2" rectangles.                      (1) 2 1/2" x WOF strip.                      Subcut (2) 2 1/2" x 4 1/2" and (16) 1 1/2" x 2 1/2" rectangles.                      (1) 1 1/2" x WOF strip.                      Subcut (16) 1 1/2" x 1 1/2" squares.</p> <p>b. Cattail block                      (1) 1" x WOF strip.                      Subcut (16) 1" x 1" squares.                      (2) 1 1/2" x WOF strips.                      Subcut (2) 1 1/2" x 2 1/2",                      (2) 1 1/2" x 3 1/2",                      (2) 1 1/2" x 5 1/2",                      (2) 1 1/2" x 11 1/2" rectangles                      and (10) 1 1/2" x 1 1/2" squares.                      (1) 3" x WOF strip.                      Subcut (2) 3" x 9 1/2" rectangles.</p> <p>c. Inner border                      (2) 1 1/2" x WOF strips.                      Subcut (2) 1 1/2" x 37 1/2" strips.                      (2) 2" x WOF strips.                      Subcut (2) 2" x 30 1/2" strips.</p> <p>d. Side strip                      (1) 1 1/2" x WOF strip.                      Subcut (1) 1 1/2" x 40 1/2" strip.</p>	<p><b>3/4y</b></p> <p>a. Star block column                      (1) 1" x WOF strip.                      Subcut (2) 1" x 20 1/2" rectangles.                      (1) 2 1/2" x WOF strip.                      Subcut (2) 2 1/2" x 4 1/2" and (16) 1 1/2" x 2 1/2" rectangles.                      (1) 1 1/2" x WOF strip.                      Subcut (16) 1 1/2" x 1 1/2" squares.</p> <p>b. Cattail block                      (1) 1" x WOF strip.                      Subcut (16) 1" x 1" squares.                      (2) 1 1/2" x WOF strips.                      Subcut (2) 1 1/2" x 2 1/2",                      (2) 1 1/2" x 3 1/2",                      (2) 1 1/2" x 5 1/2",                      (2) 1 1/2" x 11 1/2" rectangles                      and (10) 1 1/2" x 1 1/2" squares.                      (1) 3" x WOF strip.                      Subcut (2) 3" x 9 1/2" rectangles.</p> <p>c. Inner border                      (2) 1 1/2" x WOF strips.                      Subcut (2) 1 1/2" x 37 1/2" strips.                      (2) 2" x WOF strips.                      Subcut (2) 2" x 30 1/2" strips.</p> <p>d. Side strip                      (1) 1 1/2" x WOF strip.                      Subcut (1) 1 1/2" x 40 1/2" strip.</p>

# Pond Party

 Fabric B SB20053-170	<p><b>1/8y</b>            Cattail block (1) 1" x WOF strip.            Subcut (1) 1" x 5 1/2" and (1) 1" x 11 1/2" rectangles.</p>	<p><b>1/2y</b>            a. Cattail block (1) 1" x WOF strip.            Subcut (1) 1" x 5 1/2" and (1) 1" x 11 1/2" rectangles.            b. Binding (5) 2 1/4" x WOF strips.            Piece strips to make a continuous binding strip.</p>
 Fabric C SB20053-280	<p><b>1/8y</b>            Cattail block (1) 3" x WOF strip.            Subcut (1) 3" x 6 1/2" and (1) 3" x 9 1/2" rectangles.</p>	<p><b>1/8y</b>            Cattail block (1) 3" x WOF strip.            Subcut (1) 3" x 6 1/2" and (1) 3" x 9 1/2" rectangles.</p>
 Fabric D SB20053-310  Fabric H SB20268-820	<p><b>1/8y</b>            Star block column (1) 2 1/2" x WOF strip.            Subcut (1) 2 1/2" x 2 1/2" and (8) 1 1/2" x 1 1/2" squares.</p>	<p><b>1/8y</b>            Star block column (1) 2 1/2" x WOF strip.            Subcut (1) 2 1/2" x 2 1/2" and (8) 1 1/2" x 1 1/2" squares.</p>
 Fabric E SB20103-850	<p><b>1/2y</b>            Star block column and cattail block (1) 2 1/2" x WOF strip.            Subcut (1) 2 1/2" x 2 1/2" and (8) 1 1/2" x 1 1/2" squares (for star block); and (1) 1 1/2" x 6 1/2" rectangle (for cattail block)            b. Binding (5) 2 1/4" x WOF strips.            Piece strips to make a continuous binding strip.</p>	<p><b>1/8y</b>            Star block column and cattail block (1) 2 1/2" x WOF strip.            Subcut (1) 2 1/2" x 2 1/2" and (8) 1 1/2" x 1 1/2" squares (for star block); and (1) 1 1/2" x 6 1/2" rectangle (for cattail block)</p>
Fabric F	 SB20171-780 <b>3/8y</b> Outer border. (4) 2 1/2" x WOF strips. Subcut (4) 2 1/2" x 40 1/2" strips.	 SB20103-950 <b>3/8y</b> Outer border. (4) 2 1/2" x WOF strips. Subcut (4) 2 1/2" x 40 1/2" strips.
 Fabric G SB20171-815	<p><b>1/8y</b>            Star block column and cattail block (1) 2 1/2" x WOF strip.            Subcut (1) 2 1/2" x 2 1/2" and (8) 1 1/2" x 1 1/2" squares (for star block); and (1) 1 1/2" x 4 1/2" rectangle (for cattail block)</p>	<p><b>1/8y</b>            Star block column and cattail block (1) 2 1/2" x WOF strip.            Subcut (1) 2 1/2" x 2 1/2" and (8) 1 1/2" x 1 1/2" squares (for star block); and (1) 1 1/2" x 4 1/2" rectangle (for cattail block)</p>

# Pond Party

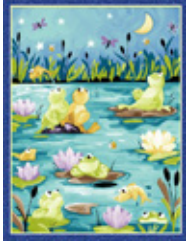

Fabric I  
SB20405-780

**1y**  
Quilt center  
(1) 28 1/2" x 37 1/2" rectangle from panel design, centering design. .  
This should be 1/4" to the outside of thin, green panel frame.

**1y**  
Quilt center  
(1) 28 1/2" x 37 1/2" rectangle from panel design, centering design. .  
This should be 1/4" to the outside of thin, green panel frame.

## Constructing star block column

1. Draw a diagonal line on the wrong side of (1) 1 1/2" x 1 1/2" print square. Place square, right sides together, at a corner of (1) 1 1/2" x 2 1/2" Fabric A rectangle. Sew on drawn line. Trim 1/4" away from sewn line. Open and press to reveal corner triangle. Repeat with another 1 1/2" x 1 1/2" print square at the opposite corner to make (1) flying geese unit. Make a total of (4) units.



2. Sew (2) step 1 units to the opposite sides of (1) 2 1/2" x 2 1/2" print square to make a row unit.



Sew (2) 1 1/2" x 1 1/2" Fabric A squares to the opposite short sides of (1) step 1 unit to make a row unit. Make a total of (2) row units.



3. Sew row units in step 2 to complete (1) star block. Block measures 4 1/2" x 4 1/2" unfinished.

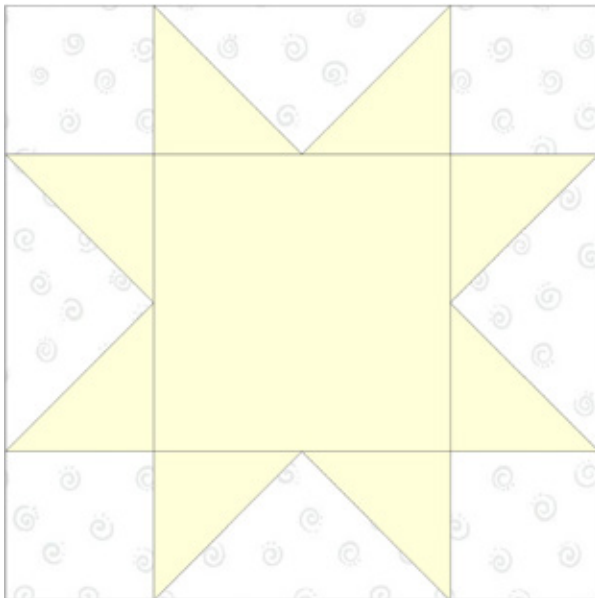

4. Make one block each for Fabrics D, E, G, H. Sew blocks together to make a pieced column unit. Add (2) 2 1/2" x 4 1/2" Fabric A rectangles to the top and bottom. Add (2) 1" x 20 1/2" Fabric A rectangles to the opposite short sides to make star block column.



# Pond Party

## Constructing cattail block

1. Draw a diagonal line on the wrong side of (1) 1" x 1" Fabric A square. Place square, right sides together, at a corner of (1) 3" x 6 1/2" Fabric C rectangle. Sew on drawn line. Trim 1/4" away from sewn line. Open and press. Repeat with (3) 1" x 1" Fabric A squares at the remaining corners of the same Fabric C rectangle.



2. Draw a diagonal line on the wrong side of (1) 1 1/2" x 1 1/2" Fabric A square. Place square, right sides together, at a corner of (1) 1 1/2" x 4 1/2" Fabric G rectangle. Sew on drawn line. Trim 1/4" away from sewn line. Open and press. Repeat with another 1 1/2" x 1 1/2" Fabric A square at the diagonally opposite corner of the same Fabric G rectangle. Add (1) 1 1/2" x 1 1/2" to the top of sewn unit.

3. Sew step 2 unit and (1) 1 1/2" x 5 1/2" Fabric A rectangle to the opposite long sides of (1) 1" x 5 1/2" Fabric B rectangle.

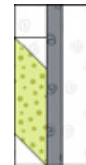

4. Use method used in step 1 to attach (4) 1" x 1" Fabric A squares to all the corners of (1) 3" x 9 1/2" Fabric C rectangle.

5. Use method used in step 4 to attach (2) 1 1/2" x 1 1/2" Fabric A squares to the diagonally opposite corners of (1) 1 1/2" x 6 1/2" Fabric E rectangles, noting seam orientations. Add (1) 1 1/2" x 3 1/2" Fabric A rectangle and (1) 1 1/2" x 2 1/2" Fabric A rectangle to the bottom of sewn unit. Sew unit and (1) 1 1/2" x 11 1/2" Fabric A rectangle to the opposite long sides of (1) 1" x 11 1/2" Fabric B rectangle.



6. Sew (1) 3" x 9 1/2" Fabric A rectangle to the top, and step 2 unit to the bottom of step 1 unit to make a column unit. Sew together step 4 units to make another column unit. Sew both column units together to complete cattail block. Block measures 5 1/2" x 20 1/2" unfinished.

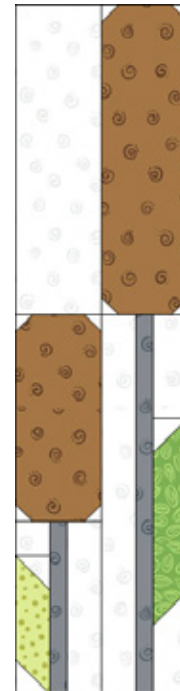

## Quilt Top Assembly

1. Sew (2) 1 1/2" x 37 1/2" Fabric A strips to the opposite long sides of (1) 28 1/2" x 37 1/2" Fabric I rectangle, followed by (2) 2" x 30 1/2" Fabric A strips to the remaining opposite short sides.

2. Sew together star block column and cattail block together along the short sides, and add to the right side of quilt center in step 1, followed by (1) 1 1/2" x 40 1/2" Fabric A strip.

# Pond Party

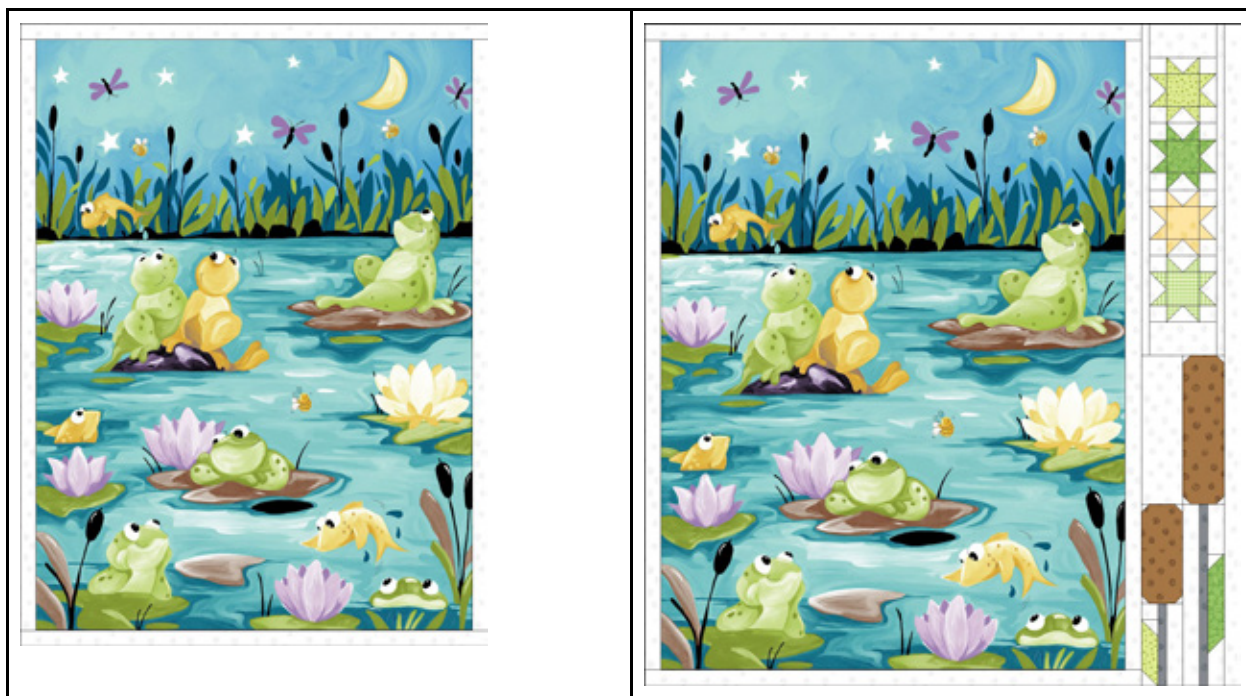

3. Sew (2) 2 1/2" x 40 1/2" Fabric F strips to the opposite long sides of quilt center, followed by (2) 2 1/2" x 40 1/2" Fabric F strips to the remaining opposite short sides of quilt center to complete quilt top.



## Finishing

1. Layer backing, batting and quilt top.
2. Baste the layers together. Quilt as desired.
3. Bind to complete the quilt.

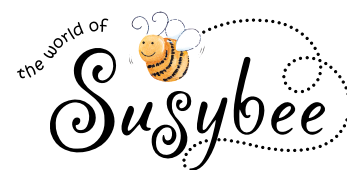

by  Clothworks

Not For Resale. While every attempt has been made to give accurate measurements, yardage requirements, and construction directions, this does not allow for personal variations in measuring, cutting and/or sewing. Clothworks is not responsible for printing errors. Check [clothworks.com](http://clothworks.com) for pattern updates.