

ADEL IN WINTER PANEL QUILT

Riley Blake
DESIGNS



Adel in Winter
by SANDY GERVAIS



ADEL IN WINTER PANEL QUILT

FINISHED QUILT SIZE 47" x 54"

Measurements include $\frac{1}{4}$ " seam allowance.

Sew with right sides together unless otherwise stated.

Please check our website www.rileyblakedesigns.com/pattern-updates for any revisions before starting this project. This pattern requires a basic knowledge of quilting technique and terminology. The quilt and block diagrams portrayed are virtual images. The layout and look of your project may differ when using actual fabric.

FABRIC REQUIREMENTS

1 Adel in Winter Panel (P12270)

$\frac{1}{2}$ Yard Red Lights (C12266)

1 $\frac{1}{2}$ Yards Mint Tripleberry (C12268)*

$\frac{3}{4}$ Yard Mint Snowflakes (C12267)

* Includes binding

CUTTING REQUIREMENTS

Please read instructions first before cutting.

WOF - width of fabric.

Label pieces as they are cut.

Adel in Winter Panel

Fussy cut 1 Center Panel $35\frac{1}{2}$ " x $42\frac{1}{2}$ ", centered over the motif.

Red Lights

Cut 5 strips $1\frac{1}{2}$ " x WOF.

Sub-cut from strips:

22 - $1\frac{1}{2}$ " x $3\frac{1}{2}$ " rectangles (A)

70 - $1\frac{1}{2}$ " squares (B)

Mint Tripleberry

Cut 4 strips $2\frac{1}{2}$ " x WOF.

Sub-cut from strips:

4 - $2\frac{1}{2}$ " x $5\frac{1}{2}$ " rectangles (E)

4 - $2\frac{1}{2}$ " x $3\frac{1}{2}$ " rectangles (F)

44 - $2\frac{1}{2}$ " squares (C)

Cut 6 strips $2\frac{1}{2}$ " x WOF for Binding.

Cut 4 strips $1\frac{1}{2}$ " x WOF.

Sub-cut from strips:

100 - $1\frac{1}{2}$ " squares (D)

Cut 6 strips $1\frac{1}{2}$ " x WOF for Border 2.

Mint Snowflakes

Cut 5 strips $3\frac{1}{2}$ " x WOF.

Sub-cut from strips:

26 - $3\frac{1}{2}$ " squares (G)

44 - $2\frac{1}{2}$ " x $3\frac{1}{2}$ " rectangles (H)

Cut 4 strips $1\frac{1}{2}$ " x WOF.

Sub-cut from strips:

88 - $1\frac{1}{2}$ " squares (I)

QUILT ASSEMBLY

Refer to the quilt photo and layout for the placement of prints. Press seam allowances as shown in the diagrams unless otherwise stated.

General Instructions

All angled pieces are constructed using the sew and flip method. This method is described below and referenced throughout the pattern.

Sew and Flip Method

Place the 2 pieces right sides together matching the raw edges in one corner. Draw a diagonal line on the wrong side of the top piece across the corner. Sew on the drawn line. Trim the seam allowance above the sewn line to $\frac{1}{4}$ ". Flip the top piece away from the bottom piece and press.

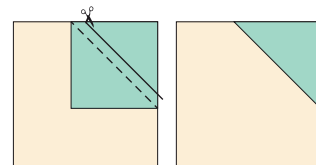

Border Blocks (Make 22)

Select the following pieces:

1 A rectangle and G square

2 C squares and H rectangles

3 B squares

4 D and I squares

Using the sew and flip method described in the general instructions, sew D squares to the upper corners of the G square ($3\frac{1}{2}$ " x $3\frac{1}{2}$ ").

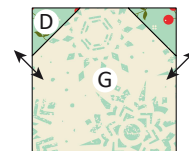

ADEL IN WINTER PANEL QUILT

Repeat to sew I squares to the upper corners of the A rectangle ($1\frac{1}{2}" \times 3\frac{1}{2}"$).



Sew 1 B square between 2 I squares. Sew the pieced squares between the G square and A rectangle to make the Center Unit ($3\frac{1}{2}" \times 5\frac{1}{2}"$).

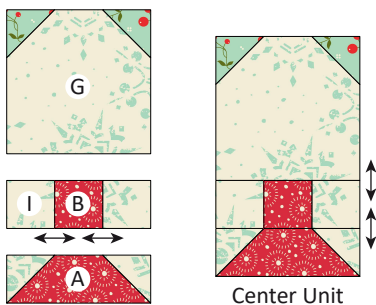

Using the sew and flip method, sew a D square to the upper left and a B square to the lower left corner of an H rectangle. Sew a C square to the top to make the Left Unit ($2\frac{1}{2}" \times 5\frac{1}{2}"$).

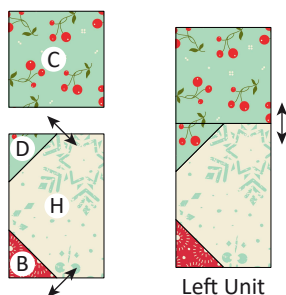

Using the sew and flip method, sew a D square to the upper right and a B square to the lower right corner of an H rectangle. Sew a C square to the top to make the Right Unit ($2\frac{1}{2}" \times 5\frac{1}{2}"$).

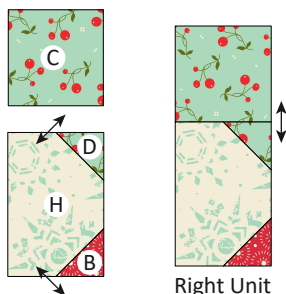

Sew together the Left, Center and Right Units to complete 1 Border Block ($5\frac{1}{2}" \times 7\frac{1}{2}"$).

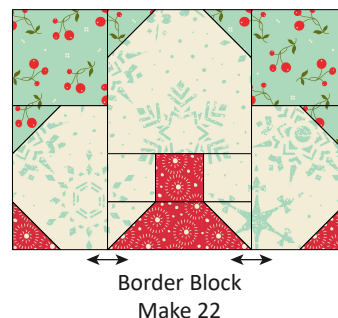

Repeat to make 22 Border Blocks.

Corner Blocks (Make 4)

Select the following pieces:

- 1 B and G square and E and F rectangle
- 3 D squares

Using the sew and flip method sew the B square to the lower right corner and D squares to the remaining corners of the G square ($3\frac{1}{2}" \times 3\frac{1}{2}"$).

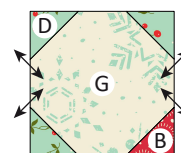

Sew the F rectangle to the left edge, followed by the E rectangle to the top edge of the G square to complete 1 Corner Block ($5\frac{1}{2}" \times 5\frac{1}{2}"$).

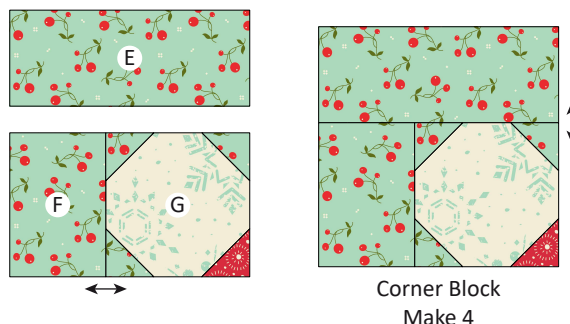

Repeat to make 4 Corner Blocks.

ADEL IN WINTER PANEL QUILT

Borders

Seam allowances vary so measure through the center of the quilt before cutting border pieces. Piece borders strips together end to end where necessary.

Sew side borders first. Press seam allowances towards the borders.

Border 1

Sew together 6 Border Blocks end to end. Repeat to make 2 border strips (5½" x 42½"). Sew the border strips to the left and right edges of the Center Panel (45½" x 42½").

Sew together 5 Border Blocks. Sew a Corner Block to each end, noting the orientation of the corner block. Repeat to make 2 border strips (5½" x 45½"). Sew the border strips to the top and bottom edges of the Center Panel (45½" x 52½").

Border 2

Side borders should be 52½". Top and bottom borders should be 47½".

Finish quilt by layering the quilt top, batting, and back. Bind with the Mint Tripleberry strips. Have fun with your colors and enjoy the journey of making your quilt.

Quilt Layout Diagram

