

MAYWOOD  STUDIO

# TOWN SQUARE QUILT



**Town Square Quilt by Maywood Studio**  
featuring Hometown Halloween by Kimberbell®

58" x 67"

#madewithmaywood  
maywoodstudio.com





# MAYWOOD STUDIO



Fabric 1  
9920-K



Fabric 2  
9924-O



Fabric 3  
9924-G

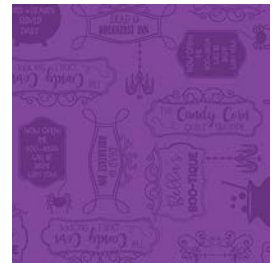

Fabric 4  
9924-V

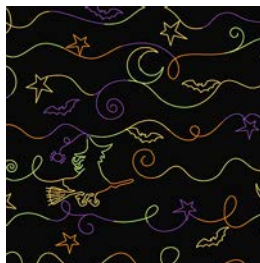

Fabric 5  
9922-J



Fabric 6  
9923-K



Fabric 7  
9925-K



Binding  
9926-V

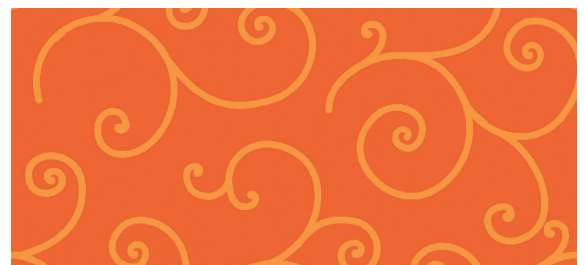

Kimberbell 108"  
Wide Backing  
MASQB202-OO

## Fabric Requirements

Fabric 1	9920-K	7/8 yard
Fabric 2	9924-O	1/2 yard
Fabric 3	9924-G	5/8 yard
Fabric 4	9924-V	1/2 yard
Fabric 5	9922-J	1-1/8 yard
Fabric 6	9923-K	1-1/4 yard
Fabric 7	9925-J	1/2 yard
Binding	9926-V	1/2 yard
Backing	MASQB202-OO Kimberbell 108" Backings	1-7/8 yards 108" (or 3-1/2 yards 44")

WOF - Width of Fabric  
 LOF - Length of Fabric  
 RST - Right Sides Together  
 HST - Half Square Triangle

## Cutting

Finished Size 58" x 67"

Fabric 1 - Trim to 26" x 29"

Fabric 2 (Orange)

A: (6) 5-1/2" x 5-1/2" squares (HSTs)

B: (4) 4-1/2" x 4-1/2" squares

C: (8) 3-1/2" x 3-1/2" squares

D: (4) 6" x 6-1/2" rectangles

Fabric 3 (Green)

A: (6) 5-1/2" x 5-1/2" squares (HSTs)

C: (8) 3-1/2" x 3-1/2" squares

D: (4) 6" x 6-1/2" rectangles

E: (4) 6-1/2" x 6-1/2" squares

Fabric 4 (Purple)

F: (6) 5-1/2" x 5-1/2" squares (HSTs)

G: (4) 2" x 29" strips

Fabric 5: (Black Moons & Stars)

F: (6) 5-1/2" x 5-1/2" squares (HSTs)

L: (4) 9" x 9" squares

Cut (6) 1-1/2" x WOF strips. Subcut into:

H: (32) 1-1/2" x 6-1/2" rectangles

Cut (4) 3-1/2" x WOF strips. Subcut into

I: (2) 3-1/2" x 29" strips

J: (2) 3-1/2" x 32" strips

Fabric 6: (Spider Webs)

Cut (1) 6" x WOF strip. Subcut into:

B: (4) 4-1/2" x 4-1/2" squares

N: (4) 6" x 6" squares

Cut (2) 2-1/2" x WOF strip. Subcut into:

K: (24) 2-1/2" x 2-1/2" squares

Cut (5) 2" x WOF strips. Subcut into

O: (24) 2" x 6-1/2" rectangles

Q: (6) 2" x 9" rectangles \*Use leftover from K

Cut (7) 3-1/2" x WOF strips. Subcut into:

L: (6) 3-1/2" x 6-1/2" rectangles

M: (4) 3-1/2" x 9" rectangles

P: (8) 3-1/2" x 6-1/2" rectangles

T: (2) 3-1/2" x 58 borders"

Fabric 7: (Lt. Grey Bats)

R: (2) 3-1/2" x 29" strips

S: (2) 3-1/2" x 32" strips

Binding (Stripe)

Cut (7) 2-1/4" x WOF strips

## Town Square Quilt Instructions

Please read all instructions before you begin. Seam allowance is 1/4" unless otherwise stated.

Do not prewash fabric. Use a light sizing or starch to stabilize pieces before sewing.

Fabric will be abbreviated to 'F'. For example, F2 refers to Fabric 2.

### Lollipop Blocks

Gather (6) F2 & F3-A squares, (6) F4 & F5-F squares, and (24) F6-K squares.

❑ 1. Mark a diagonal line from corner to corner on the F2-A squares. Sew the F2-A squares to the F4-F squares 1/4" away from the marked line. Cut on the marked line. Press toward F. Square up to 4-3/4" x 4-3/4". Make 6 for 12 total HST units.

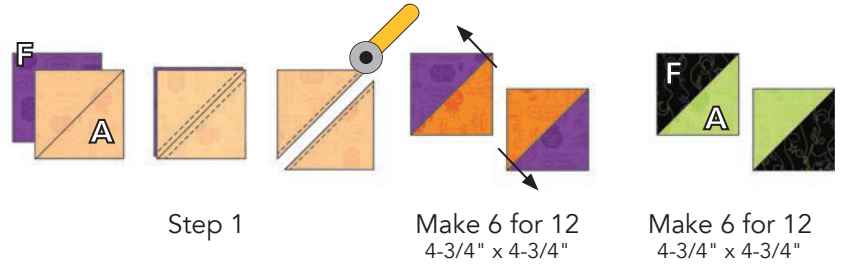

❑ 2. Repeat step 1 with the F3-A and F5-F squares.

❑ 3. Lay the HST units out as illustrated to the right. Sew into pairs. Press to nest in opposite directions. Sew the pairs together. Press open.



❑ 4. Mark a diagonal line from corner to corner on the F6-K squares. Place a F6-K square, RST, on the upper left corner of the lollipop block. Sew on the marked line. Trim 1/4" away from the stitched line. Press away from center. Repeat on the remaining three corners of the block. Block is 9" x 9" - Make 6.

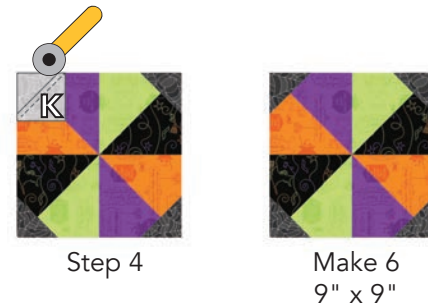

### Lollipop Rows

Gather (4) F6-M rectangles, (2) F7-S strips, and (2) F5-J strips.

❑ 5. Sew a F6-M rectangle between the Lollipop blocks as illustrated to the right. Press toward M. Make 2.



❑ 6. Sew a F7-S strip to the Step 5 row. Make sure to sew mirror image rows by sewing the strips to opposite sides on the two rows. Press toward S. Make 2 mirror image rows.



❑ 7. Sew a F5-J strip to the Step 6 sections. Press toward S. Make 2 mirror image rows.



Step 5

Step 6

Make 2  
Lollipop sections



## Spider Blocks

### Corner Units

Gather (4) F6-N squares, (4) F5-L squares, (4) F6-B squares, (4) F2-B squares, (4) F3-E squares

\*Note - Fabric 5 is a directional fabric. If you'd like the fabric to all be in the same direction you will need to place the N blocks on opposite corners of the L squares to make mirror image units. You will need to make 2 of each.

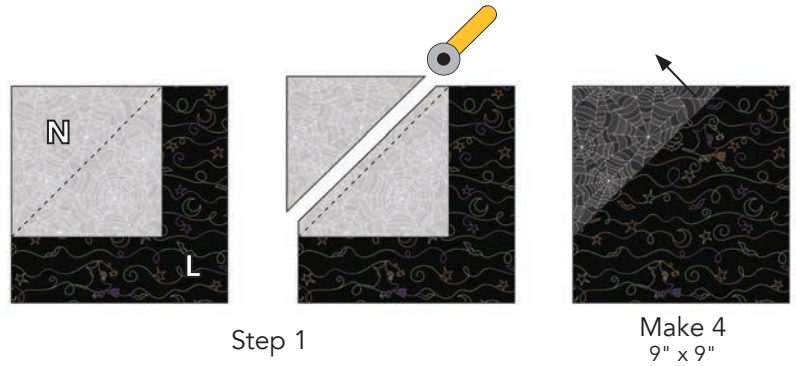

□ 1. Mark a diagonal line from corner to corner on the F6-N squares. Place an N square, RST on a F5-L square. Sew on the marked line. Cut 1/4" away from the stitching. Press away from G. Make 4.

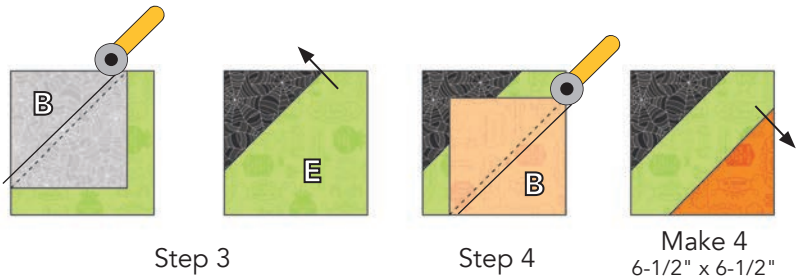

□ 2. Mark a diagonal line from corner to corner on the F6-B squares. Place a B square, RST on a F3-E square. Sew on the marked line. Cut 1/4" away from the stitching. Press away from E. Make 4.

□ 3. Mark a diagonal line from corner to corner on the F2-B squares. Place a B square, RST on the Step 1 unit. Sew on the marked line. Cut 1/4" away from the stitching. Press away from E. Make 4.



### Spider Leg Units

Gather (32) F5-H rectangles and (24) F6-O rectangles

□ 4. Sew the H and O blocks into the Spider Leg units as illustrated to the right, alternating (4) H rectangles with (3) O rectangles. Press toward H. Make 8.

□ 5. Lay the Corner units and the Spider Leg units out as illustrated below. Sew into pairs. Sew the pairs together. Press in the direction of the arrows. Make 4.

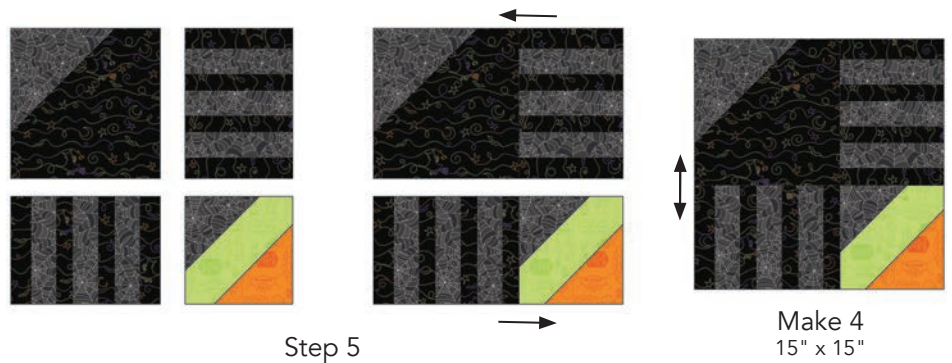

## Flag Blocks

Gather: (8 each) F2 & F3-C squares, (8) F6-P rectangles, (8 each) F2 & F3-D rectangles

### Flying Geese units

❑ 1. Mark a line from corner to corner on the F2-C squares. Place a C square, RST over a F6-P rectangle. Sew on the marked line. Trim 1/4" away from the sewn line. Press away from P.

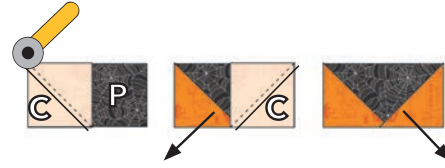

❑ 2. Repeat on the opposite corner. Make 4.

❑ 3. Sew a F2-D rectangle to the Flying Geese unit. press toward D. Make 6.

❑ 4. Repeat with steps 1-3 with F3-C & D squares and the remaining F6-P rectangles. Make 4.

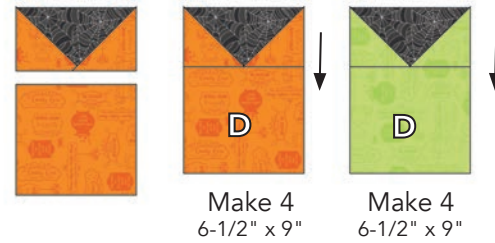

### Flag Rows

Gather: (6) F6-Q rectangles, (2) F7-R Strips, and (2) F6-I strips

❑ 5. Lay the Flag Blocks F6-Q rectangles out as illustrated to the right. Sew into a row. Press toward Q. Make 2.

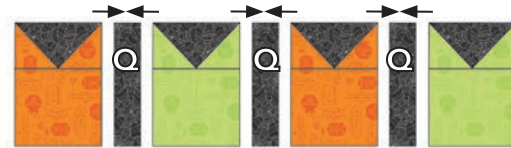

❑ 6. Sew a F7-R strip to the Step 5 row. Press toward R.

❑ 7. Sew a F5-I strip to the Step 6 section. Press toward R.

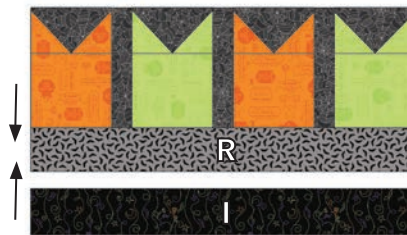

❑ 8. Lay the sections out as illustrated to the right. Sew a Spider block to either side of the Step 7 section. Make 2. Press in the direction of arrows.

### Follow the illustration on p. 7 for the next steps to assemble the quilt top.

Gather: (4) F4-G strips, (2) F6-T borders

❑ 9. Sew a F4-G strip to either side of the F1 rectangle. Press toward G.

❑ 10. Sew a F4-G strip to the top and bottom of the Step 9 section. Press toward G.

❑ 11. Sew the Lollipop sections to either side of the Step 10 section. Press away from center.

Add the top and bottom sections

❑ 12. Sew The Step 8 Spider/Flag section to the top and bottom of the center section. Press open.

❑ 13. Sew the F6-T borders to the top and bottom of the quilt top. Press toward T.



Make 2  
Spider/Flag sections



## Quilt Top Assembly



□ 14. Layer the backing (wrong side up), batting and quilt top (right side up). Baste layers to secure. Quilt as desired. Trim the excess backing and batting.

□ 15. Sew the binding strips together into one continuous strip. Press in half length-wise. Sew the binding to the quilt top with a 3/8" seam allowance. Turn the binding to the back side of the quilt and stitch down by hand with matching thread.

# Town Square Quilt Planning Diagram

