

INTERMEDIATE  
SKILL

# Chemin de Bouquets

designed by Wendy Sheppard

featuring Camilla fabric collection by Whistler Studios

SIZE: 84-1/4" x 84-1/4"

FREE  
PROJECT

THIS IS A DIGITAL REPRESENTATION OF THE QUILT TOP, FABRIC MAY VARY.

**PLEASE NOTE:** BEFORE MAKING YOUR PROJECT, CHECK FOR ANY PATTERN UPDATES AT WINDHAMFABRICS.COM'S FREE PROJECTS SECTION.



# Chemin de Bouquets

**NOTE:** Due to the layout being on-point, it is advised to measure the quilt center before cutting any border strips to length.

HST = Half-Square Triangle • QST = Quarter Square Triangle • WOF = Width of Fabric

KEY	FABRIC	SKU	YD	CUTTING INSTRUCTIONS
A		52338-1 Khaki	1-3/8	(2) 21" x WOF strips; subcut (1) 21" and (1) 10-3/4" squares from each strip for a total of (2) each. <b>QST:</b> Cut the 21" squares twice diagonally to yield (8). <b>HST:</b> Cut the 10-3/4" squares once diagonally to yield (4).
B		52338-3 Navy	1-3/4	(1) 6-1/2" x WOF strip; subcut (4) 6-1/2" squares. (9) 5" x WOF strips. Piece strips and subcut (2) 5" x 75-1/2" and (2) 5" x 84-1/2" strips.
C		52338-2 Denim	1/4	(1) 6-1/2" x WOF strip; subcut (4) 6-1/2" squares.
D		52341-1 Khaki	1-1/2	<b>Binding:</b> (9) 2-1/4" x WOF strips. (1) 14-1/2" x WOF strip; subcut (26) 1-1/2" x 14-1/2" rectangles. (5) 1-1/2" x WOF strips; subcut (8) 1-1/2" x 15-1/2" and (2) 1-1/2" x 16-1/2" rectangles.
E		52339-3 Navy	2/3	(4) 3" x WOF strips; subcut (52) 3" squares. (1) 6-1/2" x WOF strip; subcut (5) 6-1/2" squares.
F		52342-1 Khaki	1/2	(9) 1-1/2" x WOF strips. Reserve for chain piecing with <b>K</b> strips.
G		52341-2 Denim	1/3	(7) 1" x WOF strips. Piece strips and subcut (2) 1" x 66" and (2) 1" x 67" strips.





**PROJECT DISCLAIMER:** Every effort has been made to ensure that all projects are error free. All the information is presented in good faith, however, no warranty can be given nor results guaranteed. Therefore, we assume no responsibility nor damages that may occur when referring to this pattern. When errors are brought to our attention, we make every effort to correct and post a revision as soon as possible. We suggest you check [windhamfabrics.com](http://windhamfabrics.com) for pattern updates and to test the pattern prior to making the project. Test templates first, before cutting all the pieces. Free projects are not for resale.





# Chemin de Bouquets

WOF = Width of Fabric

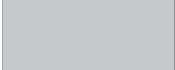
KEY	FABRIC	SKU	YD	CUTTING INSTRUCTIONS
H		52340-7 White	3/4	(3) 2-1/2" x WOF strips; subcut (40) 2-1/2" squares. (7) 2" x WOF strips. Piece strips and subcut (2) 2" x 67" and (2) 2" x 70" strips.
I		52340-5 Scarlet	3/8	(8) 1-1/4" x WOF strips. Piece strips and subcut (2) 1-1/4" x 74" and (2) 1-1/4" x 75-1/2" strips.
J		52342-5 Scarlet	1/4	(4) 1-1/2" x WOF strips. Reserve for chain piecing with <b>K</b> strips.
K		52341-6 Ivory	3	(4) 6-1/2" x WOF strips; subcut (52) 2-1/2" x 6-1/2" rectangles. (4) 3" x WOF strips; subcut (52) 3" squares. (8) 2-1/2" x WOF strips. Piece strips and subcut (2) 2-1/2" x 70" and (2) 2-1/2" x 74" strips. (1) 2-1/2" x WOF strip; subcut (12) 2-1/2" squares. (7) 1-1/2" x WOF strips. Piece strips and subcut (2) 1-1/2" x 64" and (2) 1-1/2" x 66" strips. (1) 1-1/2" x WOF strip; subcut (12) 1-1/2" squares. (13) 1-1/2" WOF strips. Reserve for chain piecing with <b>F</b> and <b>J</b> strips.
		Backing	7-3/4	Batting 93" x 93"



# Chemin de Bouquets

## CHAIN BLOCK

1. Sew together (1) each **F** and **K** 1-1/2" x WOF strips lengthwise. As shown, subcut strip set at:
  - a. 6-1/2" intervals to yield (4) 2-1/2" x 6-1/2" units and
  - b. 1-1/2" intervals to yield (8) 1-1/2" x 2-1/2" units.

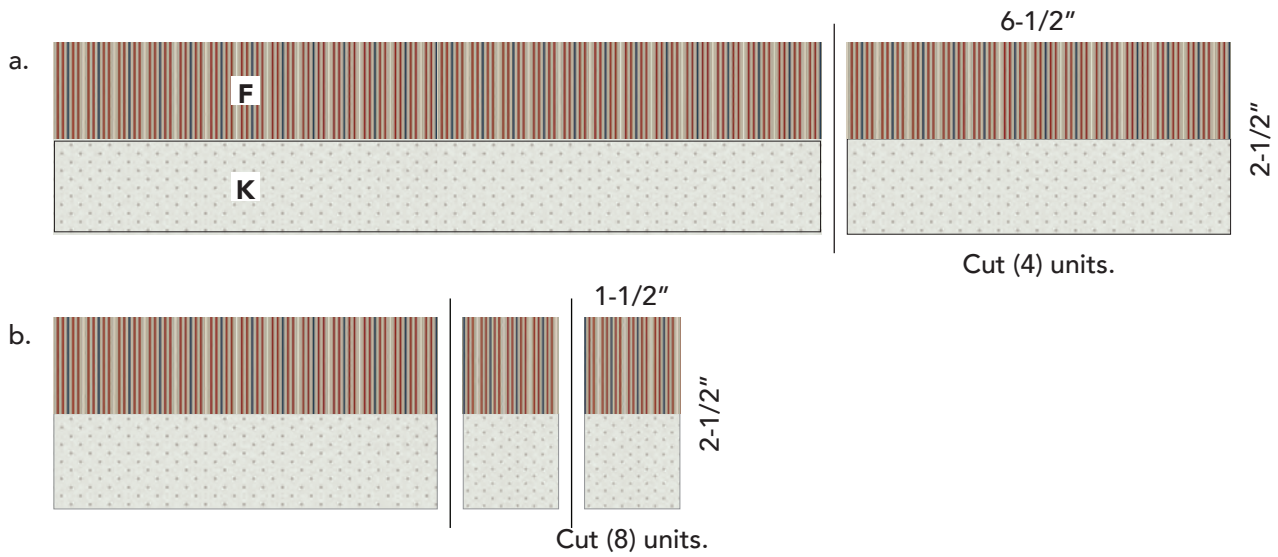

2. Noting placement of units, sew (1) **F/K** 2-1/2" x 6-1/2" unit to the long side of (1) **K** 2-1/2" x 6-1/2" rectangle as shown. Make (4) total.
3. Noting placement of units, sew (2) units made in **Step 2** to the left and right sides of (1) **E** 6-1/2" square to make a row unit.
4. **4-Patch Units:** Noting rotation, sew together (2) **F/K** 1-1/2" x 2-1/2" units as shown. Make (4).

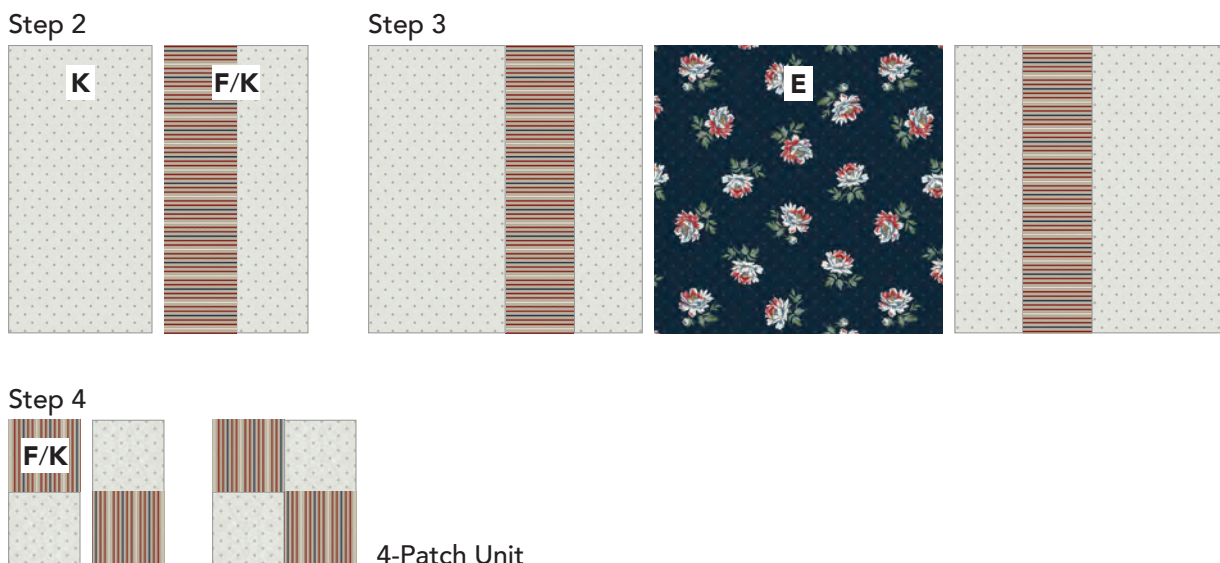



# Chemin de Bouquets

5. **Half-Square Triangles:** Draw a diagonal line on the wrong side of (1) **K** 3" square. Place marked **K** square, right sides together, onto (1) **E** 3" square. Sew 1/4" away from both sides of the drawn line. Cut along drawn line to yield (2) HST units. Trim units to measure 2-1/2" square. Make (8).

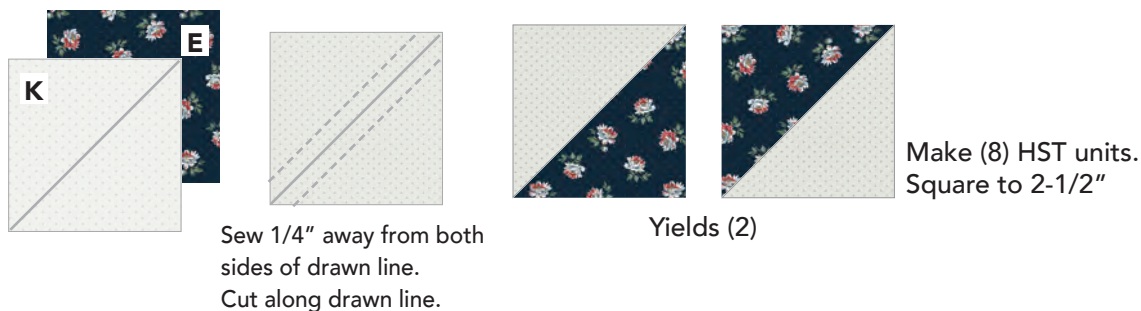

6. **Corner Units:** Lay out (1) **H** 2-1/2" square, (2) HST Units and (1) 4-Patch Unit square as shown. Sew into rows and join rows to make (1) **H** Corner Unit. Make (2). Repeat steps using (2) **K** 2-1/2" square to make (2) **K** corner units
7. Sew (2) **H** Corner Units to the opposite short sides of (1) **F/K** unit (Step 2) to make a row unit. Repeat to make a row unit with the **K** Corner Units.

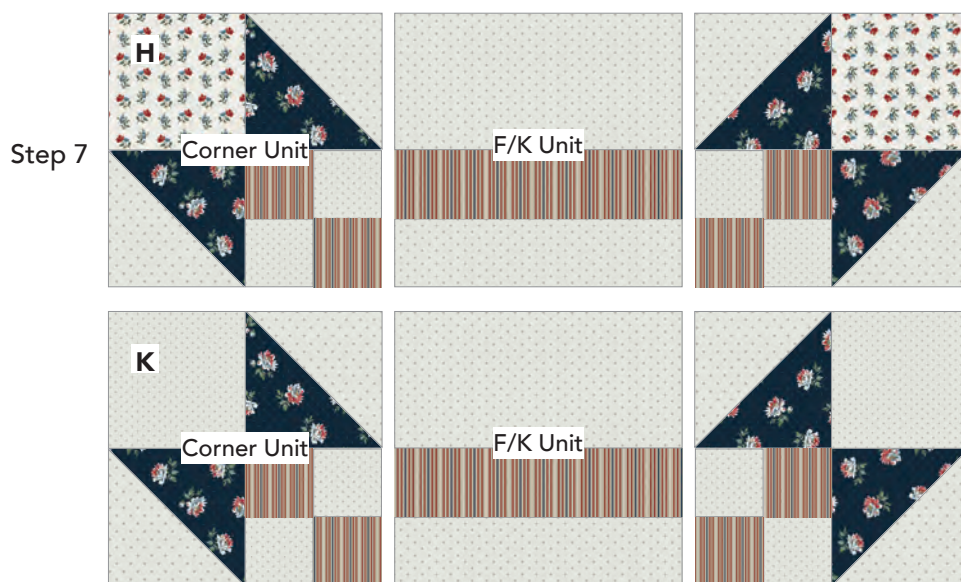
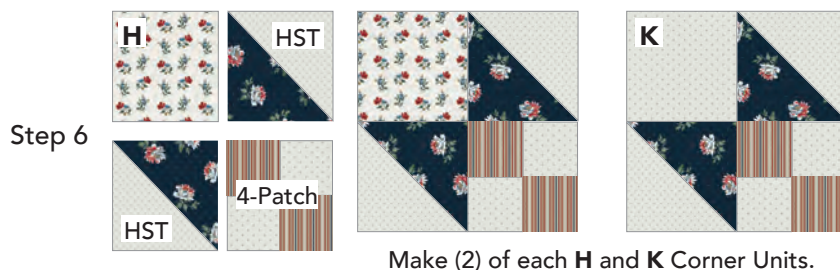



# Chemin de Bouquets

8. Sew together (2) Step 7 and (1) Step 3 row units to complete (1) Chain Block. Make (4) **E/F/H** Chain Blocks. Measures: 14" Square.
9. Make the following total number of Chain Blocks using the fabric combinations and 2-1/2" squares indicated for the Corner Units:

Step 8

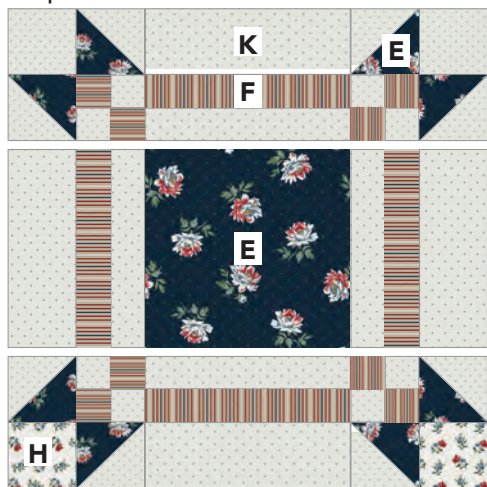

Make (4) **E/F/H** Chain Blocks

Measures: 14" Square

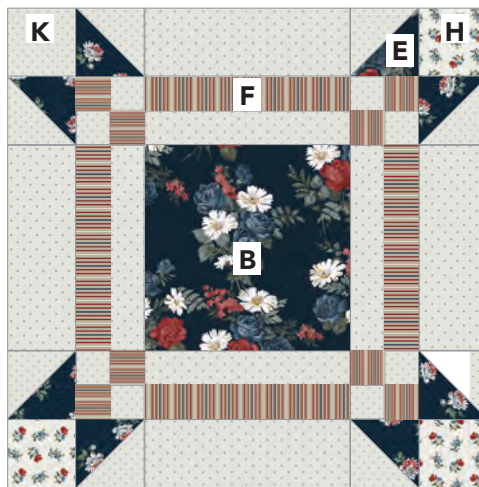

Make (4) **B/E/F/H**

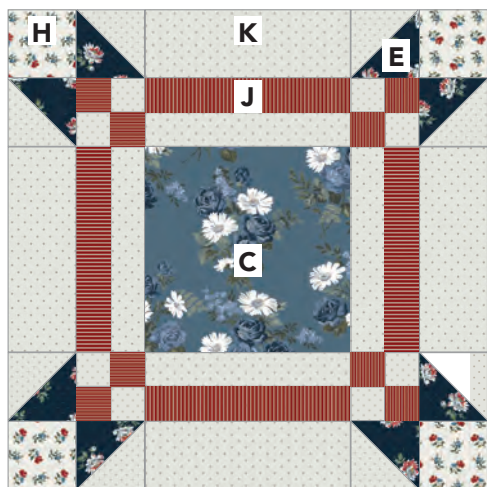

Make (4) **C/E/J/H**

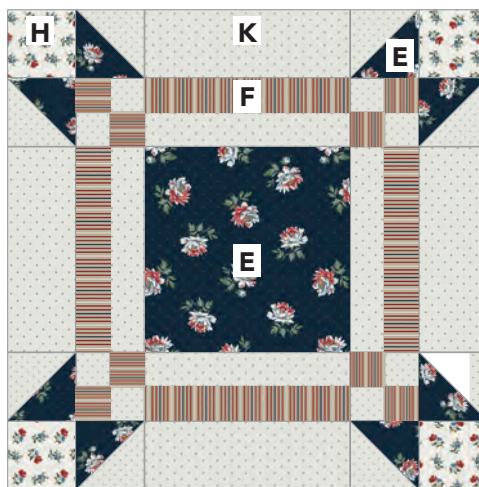

Make (1) **E/F/H**





# Chemin de Bouquets

## QUILT CENTER ASSEMBLY

10. Refer to Quilt Assembly (page 8) for block placement and orientation. Sew together Chain Blocks and **D** 1-1/2" x 14-1/2" sashing rectangles to make diagonal rows, starting from the top left.

Row 1 & 5: (1) Chain Block, (2) **D** sashing rectangles, and (2) **A** 21" QSTs. (Example below.)

Row 2 & 4: (3) Chain Blocks, (4) **D** sashing rectangles and (2) **A** 21" QSTs.

Row 3: (5) Chain Blocks, (6) **D** sashing rectangles and (2) **A** 10-3/4" HSTs.

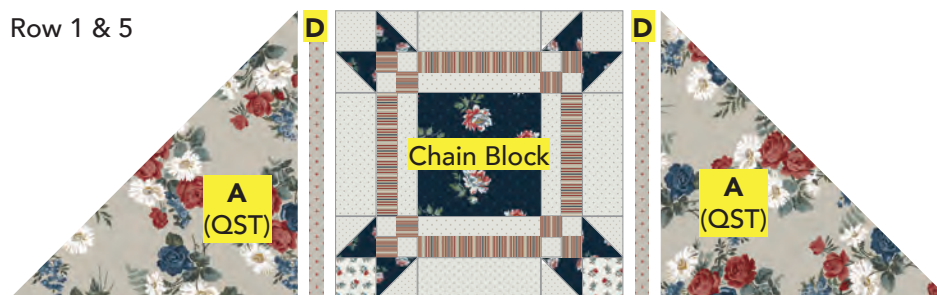

11. Arrange and sew together **D** 1-1/2" x 14-1/2", 1-1/2" x 15-1/2" and 1-1/2" x 16-1/2" sashing rectangles and **K** 1-1/2" squares to make pieced sashing rows. *NOTE: THERE WILL BE PIECES STICKING OUT FROM THE SASHING ROWS. TRIM LATER.*

Sashing Row 1 & 6: Sew (1) **D** 1-1/2" x 16-1/2" sashing rectangle on top of Row 1.

Sashing Row 2 & 5: Sew (2) **K** squares to the opposite short sides of **D** 1-1/2" x 14-1/2" sashing rectangle, followed by (2) **D** 1-1/2" x 15-1/2" sashing rectangle to the opposite ends. Example below.

Sashing Row 3 & 4: Sew together (4) **K** squares and (3) **D** 1-1/2" x 14-1/2" sashing rectangles in alternate order, followed by (2) **D** 1-1/2" x 15-1/2" sashing rectangles to the opposite ends.

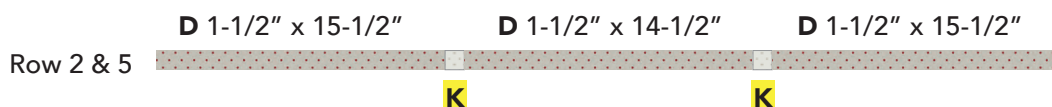

12. Sew together rows in order as shown on page 8.

13. Add (1) **A** 10-3/4" HSTs to the top left and bottom corner of Row 1 & 5 of the Quilt Center.

14. Trim around to include 1/4" seam allowance all around. Quilt Center should measure approximately 64" square.

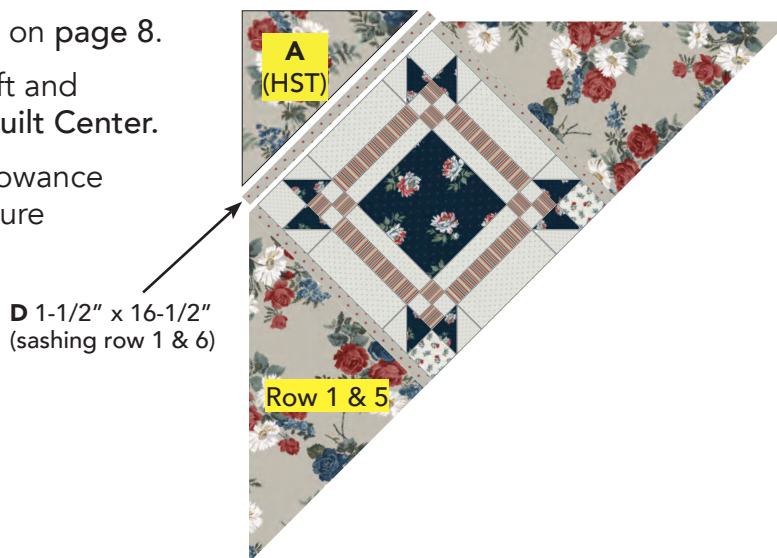



# Chemin de Bouquets

## BORDERS

- 15. Inner Border 1:** Sew (2) **K** 1-1/2" x 64" strips to the opposite sides of quilt center, followed by (2) **K** 1-1/2" x 66" strips to the remaining opposite sides of the quilt.
- 16. Inner Border 2:** Sew (2) **G** 1" x 66" strips to the opposite sides of quilt center, followed by (2) **G** 1" x 67" strips to the remaining opposite sides of the quilt.
- 17. Inner Border 3:** Sew (2) **H** 2" x 67" strips to the opposite sides of quilt center, followed by (2) **H** 2" x 70" strips to the remaining opposite sides of the quilt.
- 18. Inner Border 4:** Sew (2) **K** 2-1/2" x 70" strips to the opposite sides of quilt center, followed by (2) **K** 2-1/2" x 74" strips to the remaining opposite sides of the quilt.
- 19. Inner Border 5:** Sew (2) **I** 1-1/4" x 74" strips to the opposite sides of quilt center, followed by (2) **I** 1-1/4" x 75 1/2" strips to the remaining opposite sides of the quilt.
- 20. Outer Border:** Sew **B** (2) 5" x 75-1/2" strips to the opposite sides of quilt center, followed by (2) **B** 5" x 84 1/2" strips to the remaining opposite sides of the quilt to complete quilt top.





# Chemin de Bouquets

## Quilt Assembly



**FINISHING:** Layer quilt top, batting and backing together to form quilt sandwich. Baste and quilt as desired. Bind using **D** 2-1/4" strips.