

Autumn Steam Quilt



Finished Size: 68 ½" x 68 ½" (173.99cm x 173.99cm)

Fabric Needed

3 Wishes Fabric® Autumn Steam Collection

- 1 Panel – 4 Panel (16587-GRY-CTN-D)
- 1 ¾ yards – RR Crossing (16591-GRY-CTN-D)
- 1 ⅝ yards – Outlines (16588-CHC-CTN-D) for Piecing and Binding
- ½ yard – Tree Tops (16590-MLT-CTN-D)
- ⅜ yard – Tracks (16585-CHC-CTN-D)
- ⅓ yard – Tickets (16586-MLT-CTN-D)
- 4 ¼ yards – Tickets (16586-MLT-CTN-D) for Backing (Directional)

3 Wishes Fabric® Metallic Fusion Collection

- 1 yard – Neutral Geometric Outlines (16551-SLV-CTN-D)
- ⅝ yard – Neutral Granite (16557-MLT-CTN-D)

Additional Supplies Needed:

- 76" x 76" (193.04cm x 193.04cm) Cotton batting
- Piecing and sewing thread
- Quilting and sewing supplies
- Even-feed foot (optional for quilting)

Before You Begin

Read all instructions before beginning project. Do not pre-wash fabrics. Press fabrics with a dry iron on cotton setting before cutting. Use a 1/4" (6.35mm) seam allowance and sew fabrics with right sides together (RST) unless otherwise noted. Press seams in the direction of the arrows. wof = width of fabric

Cutting

Use a rotary cutter and acrylic ruler to cut the number of pieces from each fabric listed below.



4 Panel (16587-GRY-CTN-D) 1 Panel
Fussy Cut 4 - 12" x 12" (30.48cm x 30.48cm)
Label the Panels 1-4

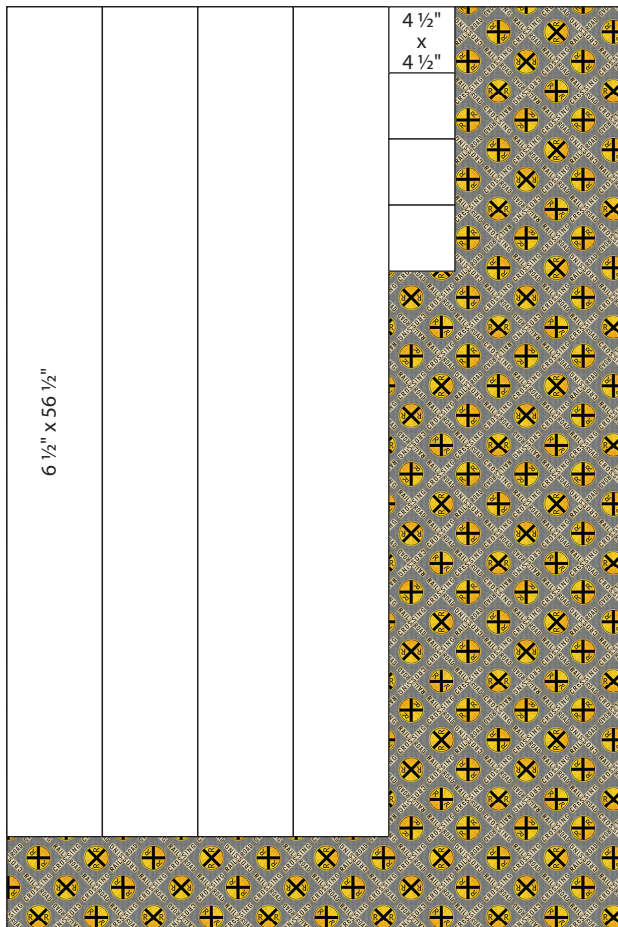

RR Crossing (16591-GRY-CTN-D) 1 3/4 yards
Cut 4 - 6 1/2" x 56 1/2" (16.51cm x 143.51cm)
Cut 4 - 4 1/2" x 4 1/2" (11.43cm x 11.43cm)

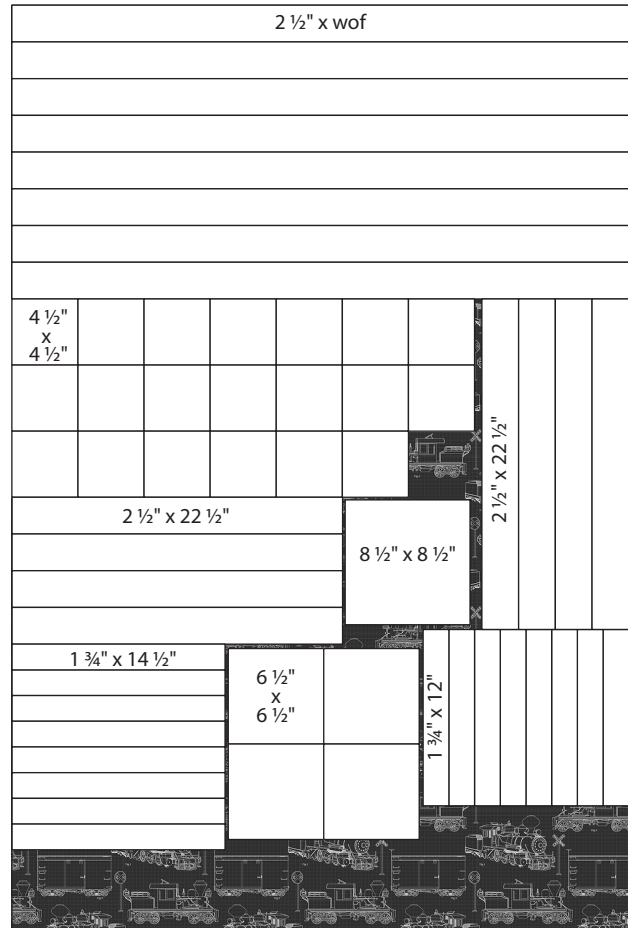

Outlines (16588-CHC-CTN-D) 1 3/4 yards

- Cut 8 - 2 1/2" (6.35cm) x wof (Binding)
- Cut 20 - 4 1/2" x 4 1/2" (11.43cm x 11.43cm)
- Cut 4 - 2 1/2" x 22 1/2" (6.35cm x 57.15cm) *horizontal
- Cut 4 - 2 1/2" x 22 1/2" (6.35cm x 57.15cm) *vertical
- Cut 1 - 8 1/2" x 8 1/2" (21.59cm x 25.19cm)
- Cut 8 - 1 3/4" x 14 1/2" (4.45cm x 36.83cm) *horizontal
- Cut 8 - 1 3/4" x 12" (6.35cm x 30.48cm) *vertical
- Cut 4 - 6 1/2" x 6 1/2" (16.51cm x 16.51cm)

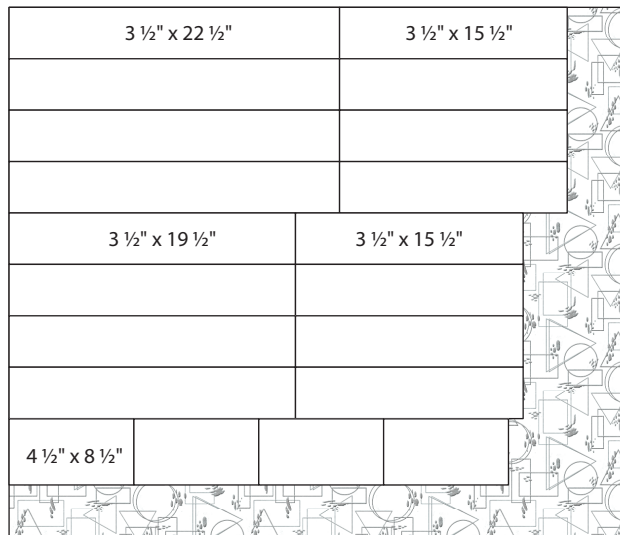

Neutral Geometric Outlines (16551-SLV-CTN-D) 1 yard from the 3Wishes Metallic Fusion Collection
 Cut 4 – 3 1/2" x 22 1/2" (8.89cm x 57.15cm)
 Cut 4 – 3 1/2" x 19 1/2" (8.89cm x 49.53cm)
 Cut 8 – 3 1/2" x 15 1/2" (8.89cm x 39.37cm)
 Cut 4 – 4 1/2" x 8 1/2" (11.43cm x 21.59cm)

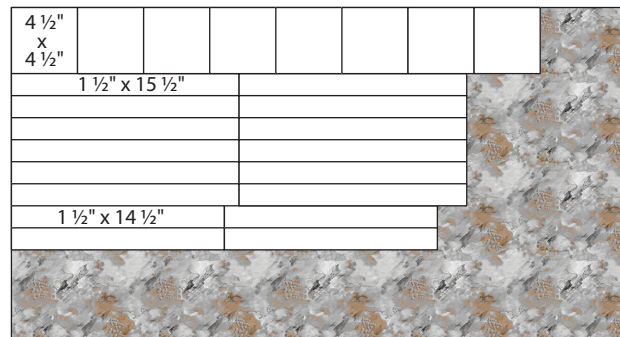

Neutral Granite(16557-MLT-CTN-D) 5/8 yard from the 3Wishes Metallic Fusion Collection
 Cut 8 – 4 1/2" x 4 1/2" (11.43cm x 11.43cm)
 Cut 12 – 1 1/2" x 15 1/2" (3.81cm x 39.37cm)
 Cut 4 – 1 1/2" x 14 1/2" (3.81cm x 36.83cm)

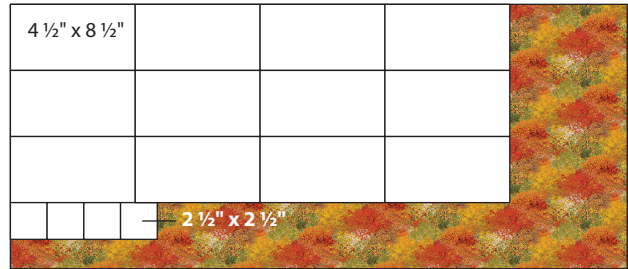

Tree Tops (16590-MLT-CTN-D) 1/2 yard
 Cut 12 – 4 1/2" x 8 1/2" (11.43cm x 21.59cm)
 Cut 4 – 2 1/2" x 2 1/2" (6.35cm x 6.35cm)

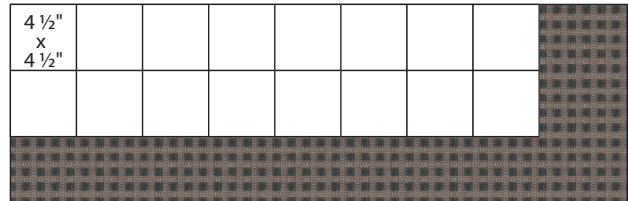

Tracks (16585-CHC-CTN-D) 3/8 yard
 Cut 16 – 4 1/2" x 4 1/2" (11.43cm x 11.43cm)

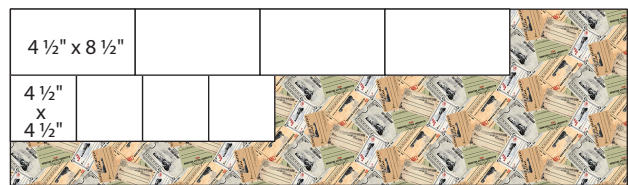

Tickets (16586-MLT-CTN-D) 1/3 yard
 Cut 4 – 4 1/2" x 8 1/2" (11.43cm x 21.59cm)
 Cut 4 – 4 1/2" x 4 1/2" (11.43cm x 11.43cm)

Sewing

- Place an Outlines Border (1 3/4" x 12" / 4.45cm x 30.48cm) on each side of a fussy cut Panel square (12" x 12" / 30.48cm x 30.48cm) as shown in Diagram A. Pin RST, sew and press. Place an Outlines Border (1 3/4" x 14 1/2" / 4.45cm x 36.83cm) on the top and bottom and pin RST, sew and press. Finished Panel 1 size will be 14 1/2" x 14 1/2" (36.83cm x 36.83cm). Repeat to make Panels 2-4.

Dia. A

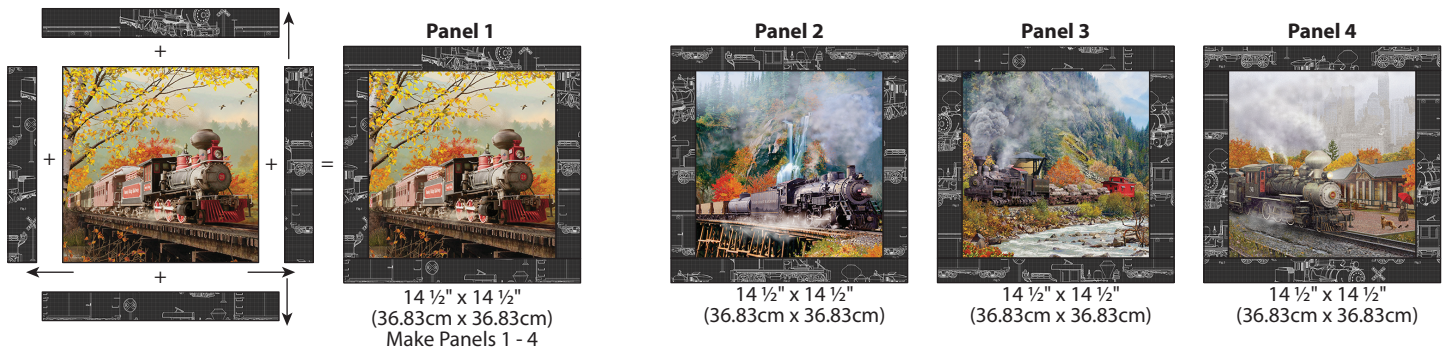

- Place a Tickets and a RR Crossing square (4 1/2" x 4 1/2" / 11.43cm x 11.43cm) as shown in Diagram B. Pin RST, sew and press to make one Border Unit (4 1/2" x 8 1/2" / 11.43cm x 21.59cm). Make four.

Dia. B

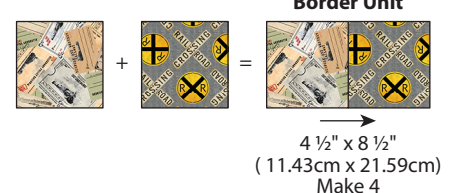

3. Refer to Diagram C to make Flying Geese Units. Draw a diagonal line on the **wrong** side of an Outlines square (4 1/2" x 4 1/2" / 11.43cm x 11.43cm). Place RST on the left side of a Tree Tops rectangle (4 1/2" x 8 1/2" / 11.43cm x 21.59cm). Sew on the diagonal line. Trim seam to 1/4" (6.35mm); press open. Repeat with a second Outlines square on the right side of the rectangle to make Flying Geese Unit 1 (4 1/2" x 8 1/2" / 11.43cm x 21.59cm). Make 8.

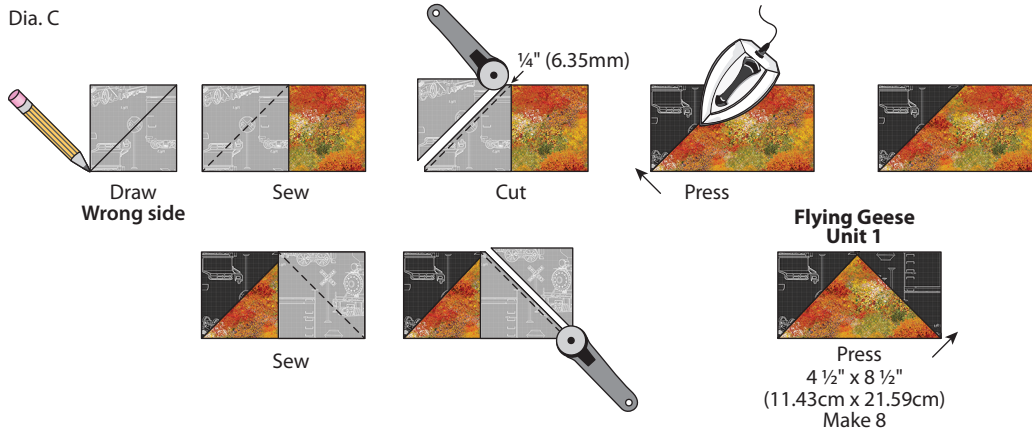

4. Repeat Step 3 and refer to Diagram D using eight Tracks squares (4 1/2" x 4 1/2" / 11.43cm x 11.43cm) and four Trees rectangles (4 1/2" x 8 1/2" / 11.43cm x 21.59cm) to make four Flying Geese Unit 2's (4 1/2" x 8 1/2" / 11.43cm x 21.59cm).

Dia. D

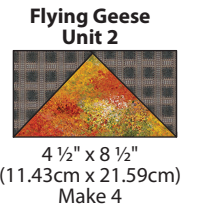

5. Repeat Step 3 and refer to Diagram E using eight Tracks squares (4 1/2" x 4 1/2" / 11.43cm x 11.43cm) and four Tickets rectangles (4 1/2" x 8 1/2" / 11.43cm x 21.59cm) to make four Flying Geese Unit 3's (4 1/2" x 8 1/2" / 11.43cm x 21.59cm).

Dia. E

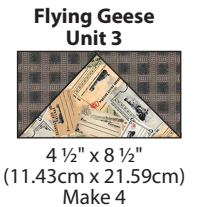

6. Repeat Step 3 and refer to Diagram F using eight Neutral Granite squares (4 1/2" x 4 1/2" / 11.43cm x 11.43cm) and four Neutral Geometric Outlines rectangles (4 1/2" x 8 1/2" / 11.43cm x 21.59cm) to make four Flying Geese Unit 4's (4 1/2" x 8 1/2" / 11.43cm x 21.59cm).

Dia. F

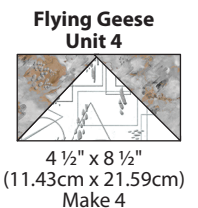

7. Place two Flying Geese Unit 1's, one each of Flying Geese Units 2-4 and one Border Unit as shown in Diagram G. Pin RST, sew and press to make one Flying Geese Row (8 1/2" x 24 1/2" / 21.59cm x 62.23cm). Make 4.

Dia. G

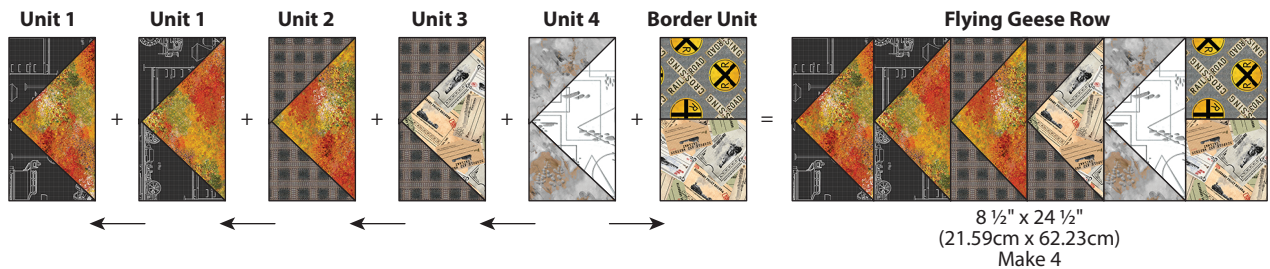

Tip: To ensure precise points when sewing a Flying Geese Unit to other pieces, place on top, stitch just next to the center of the "X", 1 or 2 threads above the intersection.

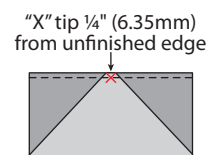

8. Place a Neutral Granite rectangle (1 1/2" x 15 1/2" / 4.45cm x 39.37cm) with a Neutral Geometric Outlines rectangle (3 1/2" x 15 1/2" / 8.89cm x 39.37cm) as shown in Diagram H. Pin RST, sew and press to make a Quadrant Border A (4 1/2" x 15 1/2" / 11.43cm x 39.37cm). Make 8.

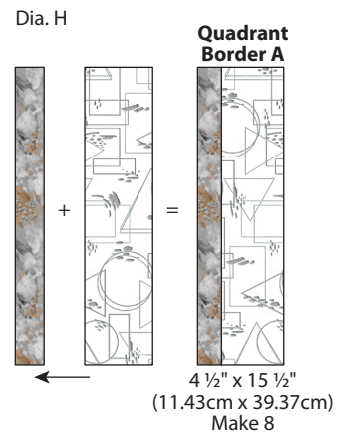

9. Place an Outlines square (4 1/2" x 4 1/2" / 11.43cm x 11.43cm) and a Quadrant Border A (4 1/2" x 15 1/2" / 11.43cm x 39.37cm) as shown in Diagram I. Pin, sew and press to make a Quadrant Border A-1 (4 1/2" x 19 1/2" / 11.43cm x 49.53cm). Make 2. Repeat to make two Quadrant Border A-2, noting the orientation of the pieces.

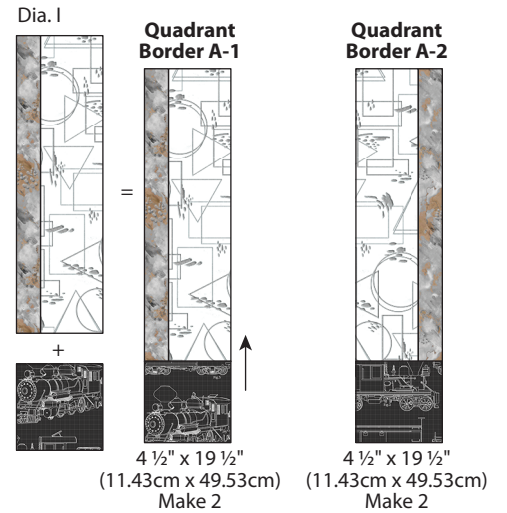

10. Place an Outlines rectangle (2 1/2" x 22 1/2" / 6.35cm x 57.15cm) and a Neutral Geometric Outlines rectangle (3 1/2" x 22 1/2" / 8.89cm x 57.15cm) as shown in Diagram J. Pin RST, sew and press to make a Quadrant Border B (5 1/2" x 22 1/2" / 13.97cm x 57.15cm). Make 4.

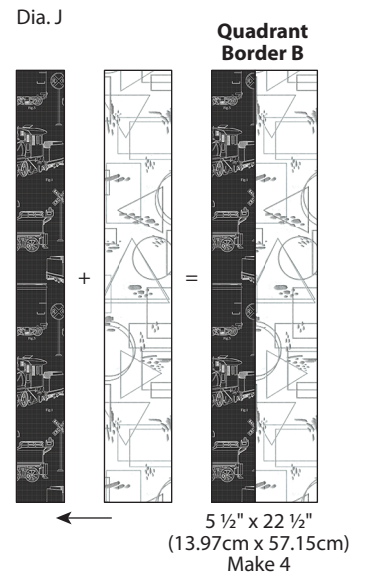

11. Place a Trees square (2 1/2" x 2 1/2" / 6.35cm x 6.35cm) and an Outlines rectangle (2 1/2" x 22 1/2" / 6.35cm x 57.15cm) as shown in Diagram K. Pin RST, sew and press to make a Quadrant Border C (2 1/2" x 24 1/2" / 6.35cm x 62.23cm). Make 4.

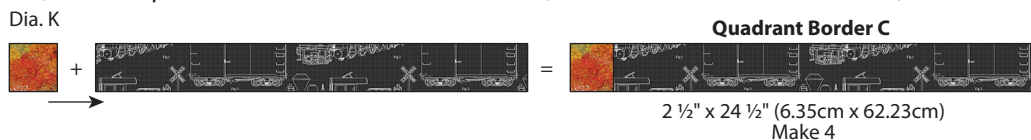

12. Construct Quadrant 1 using Fussy Cut Panel 1 square 1 (14 1/2"x 14 1/2" / 36.83cm x 36.83cm) in the center. Sew the pieces in the order shown in Diagrams L1-8. Pin pieces RST, sew and press toward the outside of the Quadrant. Check the measurements at each step to ensure the next border will fit.

- L1** Neutral Granite rectangle (1 1/2" x 14 1/2" / 4.45cm x 36.83cm). Quadrant size 14 1/2" x 15 1/2" (36.83cm x 39.37cm).
- L2** Neutral Granite rectangle (1 1/2" x 15 1/2" / 4.45cm x 39.37cm). Quadrant size 15 1/2" x 15 1/2" (39.37cm x 39.37cm).
- L3** Quadrant Border A (4 1/2" x 15 1/2" / 11.43cm x 39.37cm). Quadrant size 15 1/2" x 19 1/2" (39.37cm x 49.53cm).
- L4** Quadrant Border A-1. Quadrant size 19 1/2" x 19 1/2" (49.53cm x 49.53cm).
- L5** Neutral Geometric Outlines rectangle (3 1/2" x 19 1/2" / 8.89cm x 49.53cm). Quadrant size 19 1/2" x 22 1/2" (49.53cm x 57.15cm).
- L6** Quadrant Border B (5 1/2" x 22 1/2" / 13.97cm x 57.15cm). Quadrant size 22 1/2" x 24 1/2" (57.15cm x 62.23cm).
- L7** Quadrant Border C (2 1/2" x 24 1/2" / 6.35cm x 62.23cm). Quadrant size 24 1/2" x 24 1/2" (62.23cm x 62.23cm).
- L8** Quadrant 1 (24 1/2" x 24 1/2" / 62.23cm x 62.23cm).



13. Construct Quadrant 2 using Fussy Cut Panel 2 square (14 ½"x 14 ½" / 36.83cm x 36.83cm) in the center as shown in Diagram M. Use the piecing and pressing methods in Step 12 as a general guide but follow the numbers for the piecing order which are different for each Quadrant.

- M1** Neutral Granite rectangle (1 ½" x 14 ½" / 4.45cm x 36.83cm).
Quadrant size 14 ½" x 15 ½" (36.83cm x 39.37cm).
- M2** Neutral Granite rectangle (1 ½" x 15 ½" / 4.45cm x 39.37cm).
Quadrant size 15 ½" x 15 ½" (39.37cm x 39.37cm).
- M3** Quadrant Border A (4 ½" x 15 ½" / 11.43cm x 39.37cm).
Quadrant size 15 ½" x 19 ½" (39.37cm x 49.53cm).
- M4** Quadrant Border A-1. Quadrant size 19 ½" x 19 ½" (49.53cm x 49.53cm).
- M5** Neutral Geometric Outlines rectangle (3 ½" x 19 ½" / 8.89cm x 49.53cm).
Quadrant size 19 ½" x 22 ½" (49.53cm x 57.15cm).
- M6** Quadrant Border B (5 ½" x 22 ½" / 13.97cm x 57.15cm).
Quadrant size 22 ½" x 24 ½" (57.15cm x 62.23cm).
- M7** Quadrant Border C (2 ½" x 24 ½" / 6.35cm x 62.23cm).
Quadrant size 24 ½" x 24 ½" (62.23cm x 62.23cm).
- M8** Quadrant 2 (24 ½" x 24 ½" / 62.23cm x 62.23cm).

Dia. M

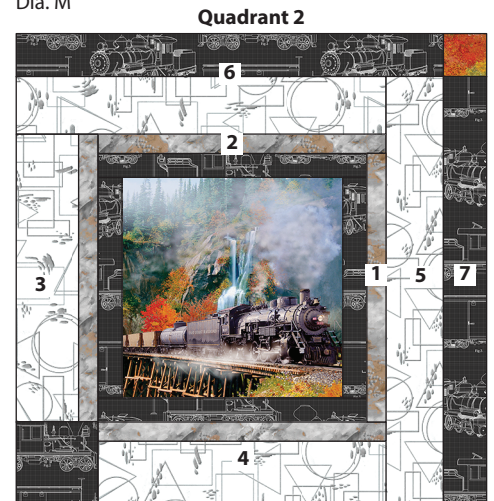

24 ½" x 24 ½" (62.23cm x 62.23cm)

14. Construct Quadrant 3 using Fussy Cut Panel 3 square (14 ½"x 14 ½" / 36.83cm x 36.83cm) in the center as shown in Diagram N. Use the piecing and pressing methods in Step 12 as a general guide but follow the numbers for the piecing order which are different for each Quadrant.

- N1** Neutral Granite rectangle (1 ½" x 14 ½" / 4.45cm x 36.83cm).
Quadrant size 14 ½" x 15 ½" (36.83cm x 39.37cm).
- N2** Neutral Granite rectangle (1 ½" x 15 ½" / 4.45cm x 39.37cm).
Quadrant size 15 ½" x 15 ½" (39.37cm x 39.37cm).
- N3** Quadrant Border A (4 ½" x 15 ½" / 11.43cm x 39.37cm).
Quadrant size 15 ½" x 19 ½" (39.37cm x 49.53cm).
- N4** Quadrant Border A-2. Quadrant size 19 ½" x 19 ½" (49.53cm x 49.53cm).
- N5** Neutral Geometric Outlines rectangle (3 ½" x 19 ½" / 8.89cm x 49.53cm).
Quadrant size 19 ½" x 22 ½" (49.53cm x 57.15cm).
- N6** Quadrant Border B (5 ½" x 22 ½" / 13.97cm x 57.15cm).
Quadrant size 22 ½" x 24 ½" (57.15cm x 62.23cm).
- N7** Quadrant Border C (2 ½" x 24 ½" / 6.35cm x 62.23cm).
Quadrant size 24 ½" x 24 ½" (62.23cm x 62.23cm).
- N8** Quadrant3 (24 ½" x 24 ½" / 62.23cm x 62.23cm).

Dia. N

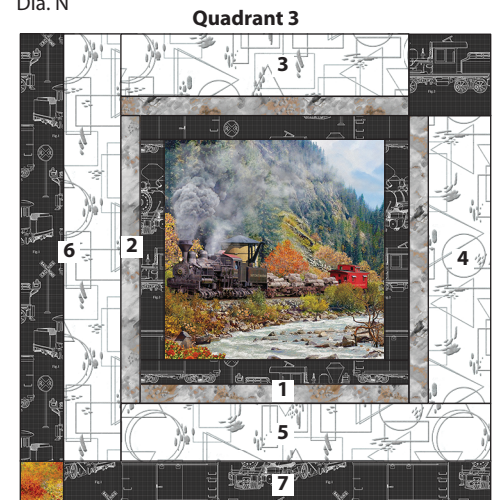

24 ½" x 24 ½" (62.23cm x 62.23cm)

15. Construct Quadrant 4 using Fussy Cut Panel 4 square (14 ½"x 14 ½" / 36.83cm x 36.83cm) in the center as shown in Diagram O. Use the piecing and pressing methods in Step 12 as a general guide but follow the numbers for the piecing order which are different for each Quadrant.

- O1** Neutral Granite rectangle (1 ½" x 14 ½" / 4.45cm x 36.83cm).
Quadrant size 14 ½" x 15 ½" (36.83cm x 39.37cm).
- O2** Neutral Granite rectangle (1 ½" x 15 ½" / 4.45cm x 39.37cm).
Quadrant size 15 ½" x 15 ½" (39.37cm x 39.37cm).
- O3** Quadrant Border A (4 ½" x 15 ½" / 11.43cm x 39.37cm).
Quadrant size 15 ½" x 19 ½" (39.37cm x 49.53cm).
- O4** Quadrant Border A-2. Quadrant size 19 ½" x 19 ½" (49.53cm x 49.53cm).
- O5** Neutral Geometric Outlines rectangle (3 ½" x 19 ½" / 8.89cm x 49.53cm).
Quadrant size 19 ½" x 22 ½" (49.53cm x 57.15cm).
- O6** Quadrant Border B (5 ½" x 22 ½" / 13.97cm x 57.15cm).
Quadrant size 22 ½" x 24 ½" (57.15cm x 62.23cm).
- O7** Quadrant Border C (2 ½" x 24 ½" / 6.35cm x 62.23cm).
Quadrant size 24 ½" x 24 ½" (62.23cm x 62.23cm).
- O8** Quadrant 4 (24 ½" x 24 ½" / 62.23cm x 62.23cm).

Dia. O

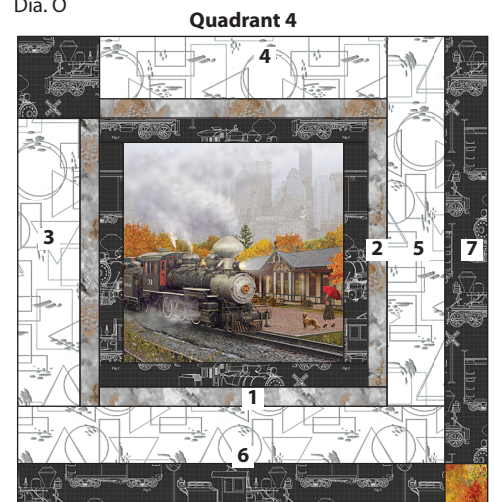

24 ½" x 24 ½" (62.23cm x 62.23cm)

16. Place Quadrants 1 and 2 ($24\frac{1}{2}'' \times 24\frac{1}{2}''$ / 62.23cm x 62.23cm) with a Flying Geese Row ($8\frac{1}{2}'' \times 24\frac{1}{2}''$ / 21.59cm x 62.23cm) as shown in Diagram P. Pin RST, sew and press to make Row 1 ($24\frac{1}{2}'' \times 56\frac{1}{2}''$ / 62.23cm x 143.51cm).

Dia. P

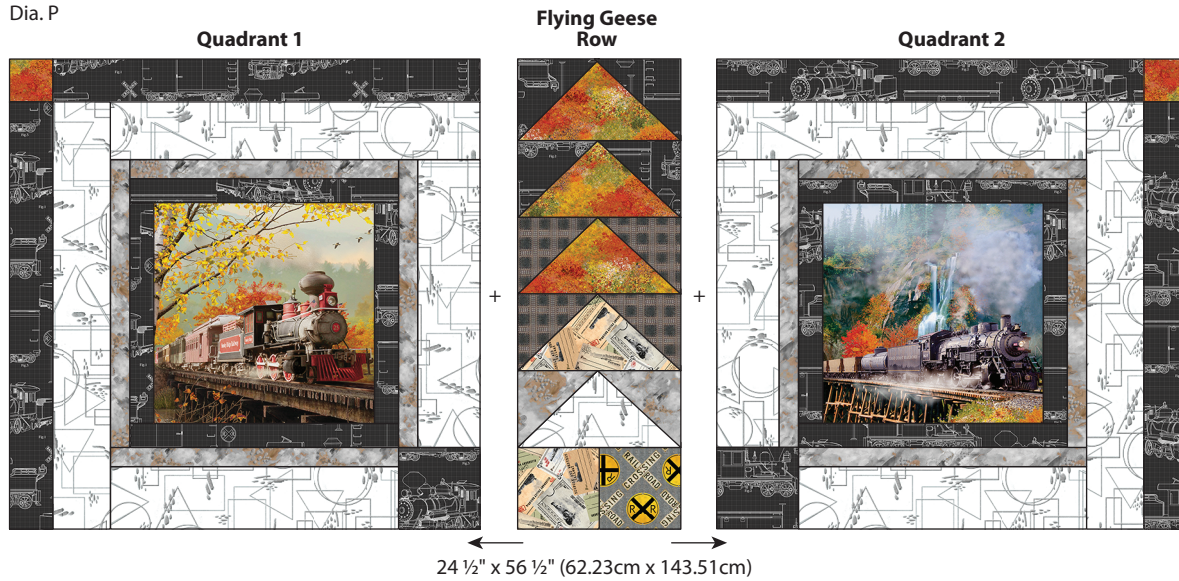

17. Place two Flying Geese Rows ($8\frac{1}{2}'' \times 24\frac{1}{2}''$ / 21.59cm x 62.23cm) with the Outlines square ($8\frac{1}{2}'' \times 8\frac{1}{2}''$ / 21.59cm x 21.59cm) as shown in Diagram Q. Pin RST, sew and press to make Row 2 ($8\frac{1}{2}'' \times 56\frac{1}{2}''$ / 21.59cm x 143.51cm).

Dia. Q

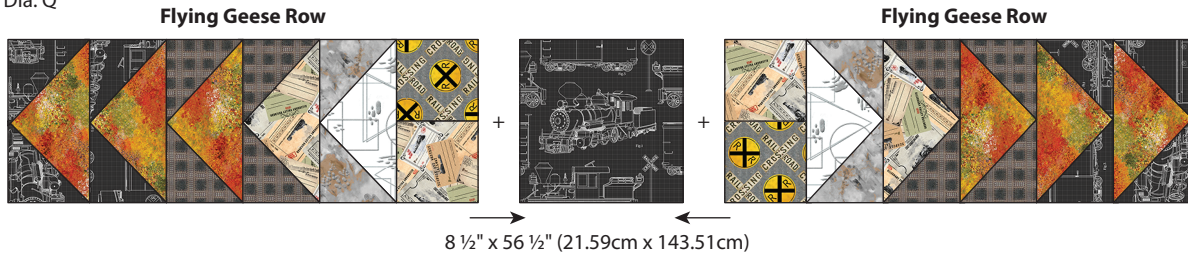

18. Place Quadrants 3 and 4 ($24\frac{1}{2}'' \times 24\frac{1}{2}''$ / 62.23cm x 62.23cm) and one Flying Geese Row ($8\frac{1}{2}'' \times 24\frac{1}{2}''$ / 21.59cm x 62.23cm) as shown in Diagram R. Pin RST, sew and press to make Row 3 ($24\frac{1}{2}'' \times 56\frac{1}{2}''$ / 62.23cm x 143.51cm).

Dia. R

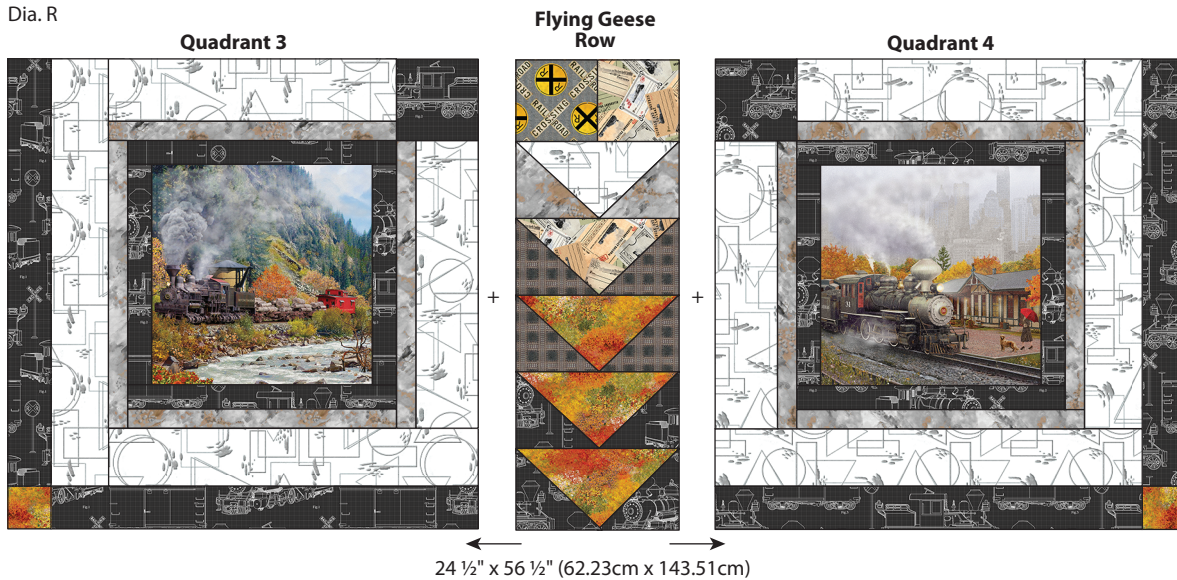

19. Place the three rows as shown in Diagram S. Pin RST matching ends, middles and seams; sew and press to make the Quilt Center (56 1/2" x 56 1/2" / 143.51cm x 143.51cm).

Dia. S



20. Place an Outlines square (6 1/2" x 6 1/2" / 16.51cm x 16.51cm) on each end of one RR Crossing rectangle (6 1/2" x 56 1/2" / 16.51cm x 143.51cm) as shown in Diagram T. Pin RST, sew and press to make the Top Border (6 1/2" x 68 1/2" / 16.51cm x 173.99cm). Repeat to make the Bottom Border.

Dia. T

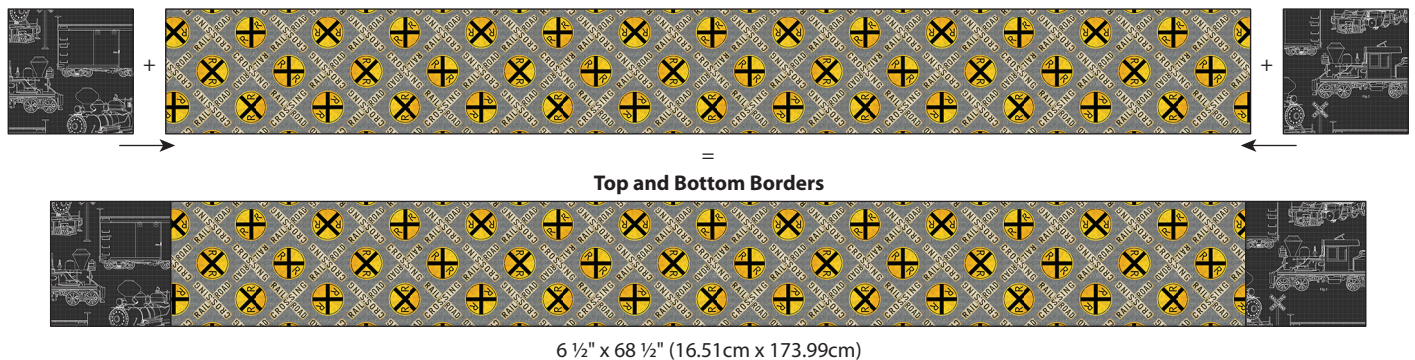

21. Refer to Diagram U to place the Borders around the Quilt Center (56 ½" x 56 ½" / 143.51cm x 143.51cm). Pin and sew the two RR Crossing rectangles (6 ½" x 56 ½" / 16.51cm x 143.51cm) to each side, then sew the top and bottom borders (6 ½" x 68 ½" / 16.51cm x 173.99cm) made in Step 20 to the top and bottom. Press seams as shown. The finished Quilt Top should measure 68 ½" x 68 ½" (173.99cm x 173.99cm).

Dia. U



68 ½" x 68 ½" (173.99cm x 173.99cm)

22. To make the Tickets Backing, remove the selvages and cut two pieces $38\frac{1}{4}'' \times 76''$ (97.16cm x 193.04cm) as shown in Diagram V. Pin RST and sew along the long edges. Press seams open or to one side. The Backing should measure $76'' \times 76''$ (193.04cm x 193.04cm).

Dia. V

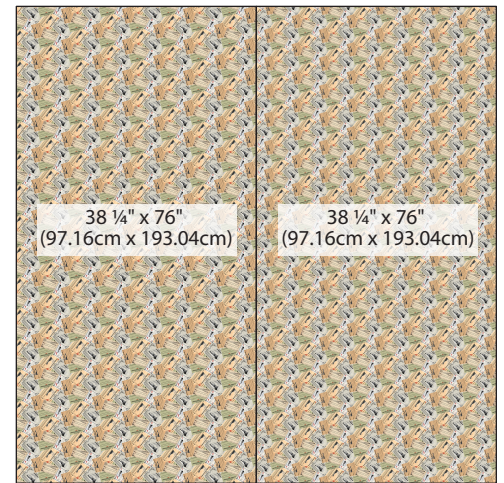

Backing
 $76'' \times 76''$ (193.04cm x 193.04cm)

23. Press finished Quilt Top and Backing. Tape the Backing **wrong** side up to a firm surface. Layer Batting and Quilt Top (right side up). Baste the layers together with safety pins. Quilt as desired.
24. Once quilting is complete, square up corners and edges, trimming excess Backing and Batting even with the Quilt Top.
25. To make the Outlines Binding, remove selvages and sew the short ends of the eight $2\frac{1}{2}''$ (6.35cm) x wof strips RST end to end at a 45° angle to make one continuous strip; press seams open. Press one short end $\frac{1}{4}''$ (6.35mm) to the **wrong** side. Fold in half lengthwise with **wrong** sides together; press. Leaving a 2" (5.08cm) tail on the folded end, place cut edges of folded Binding even with the edge of the Quilt Top and sew, mitering the corners. Overlap ends, trim any excess and finish sewing the Binding. Fold Binding over to back and hand stitch.

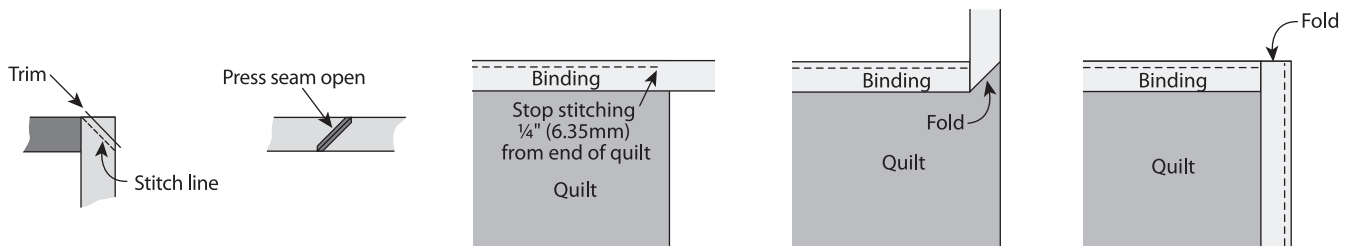

Finished Care Instructions

Machine wash in cold water; gentle cycle. Do not bleach. **Tip:** Before drying, check for fabric dyes that may have run. If fabric dyes run, rewash and rinse using a color catcher to absorb loose dye. Lay flat to dry or tumble dry low.