

NORTHCOTT
Cottons that feel like silk

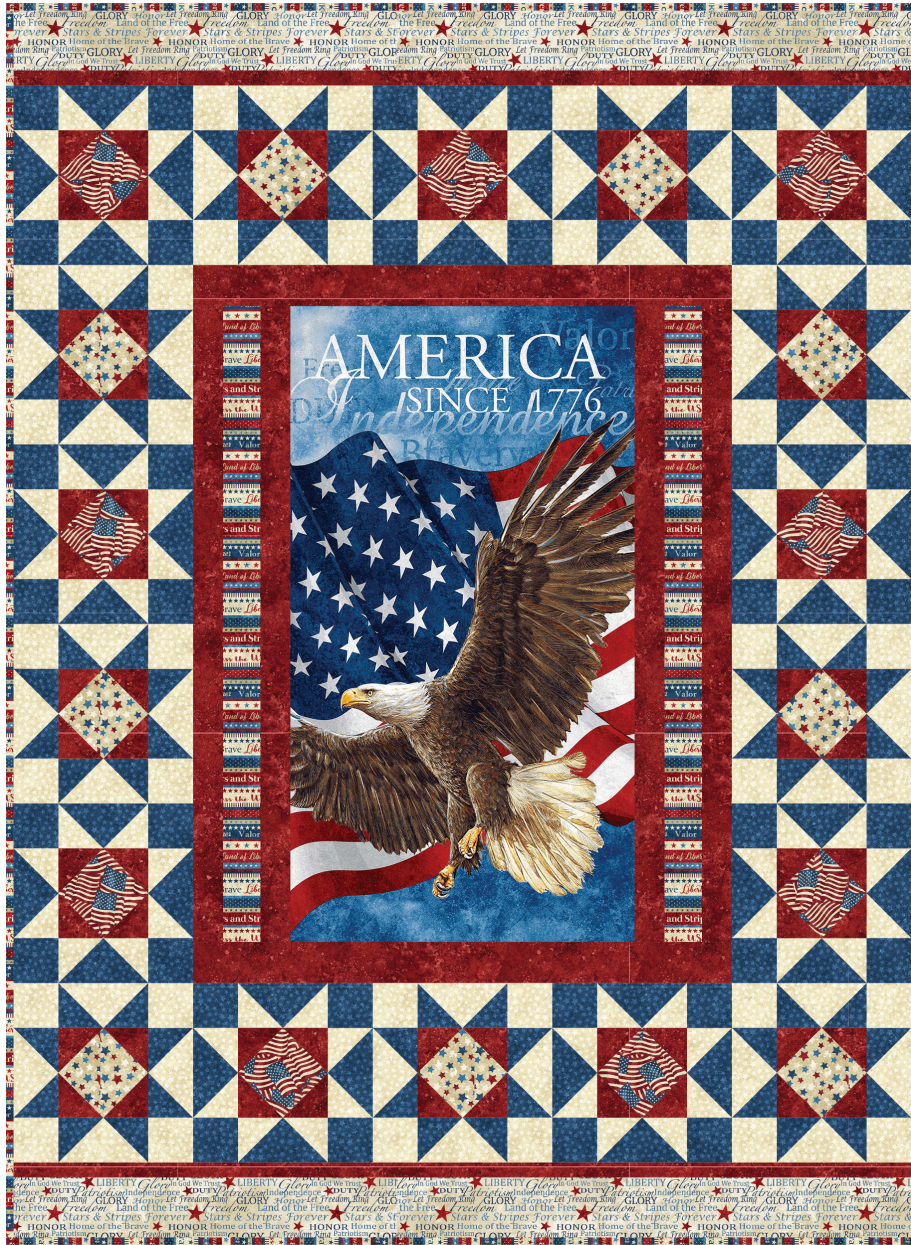

AMERICAN INDEPENDENCE

FREE PATTERN • 60" x 82" • By Tony Jacobson

Northcott Canada
101 Courtland Avenue
Vaughan, Ontario L4K 3T5

Northcott USA
1099 Wall St. West, Suite 250
Lyndhurst, NJ 07071

www.northcott.com

American Independence

QUILT DESIGNED AND PIECED BY **Tony Jacobson**

Make this patriotic quilt in cozy Stars and Stripes flannel fabrics by Northcott.

Quilt Size: 60" × 82" | Block Size: 12" Star Blocks

Materials

- 1 panel (F39371-49)
- ½ yard multi-color star print (F20159-30)
- ½ yard waving flag print (F20158-49)
- 1½ yards cream star print (F20160-12)
- 1½ yards blue star print (F20160-49)
- 1½ yards red stonehenge print (F22925-24)
- ⅞ yard stripe (includes binding) (F39386-24)
- ½ yard word print (F39195-30)
- 5 yards for backing (F39436-30)

Cutting

Measurements include ¼" seam allowances.

From panel, cut:

- 1 (23½" × 43½") rectangle.

From multi-color star print, cut:

- 2 (6½") strips. From strips, cut: 9 (6½") C squares.

From waving flag print, cut:

- 2 (6½") strips. From strips, cut: 9 (6½") C squares.

From cream star print, cut:

- 2 (7¼") strips. From strips, cut: 9 (7¼") A squares.
- 4 (3⅞") strips. From strips, cut: 36 (3⅞") B squares.
- 2 (3½") strips. From strips, cut: 36 (3½") D squares.

From blue star print, cut:

- 2 (7¼") strips. From strips, cut: 9 (7¼") A squares.
- 4 (3⅞") strips. From strips, cut: 36 (3⅞") B squares.
- 2 (3½") strips. From strips, cut: 36 (3½") D squares.

From red stonehenge print cut:

- 7 (3½") strips. From strips, cut: 72 (3½") D squares.
- 2 (3¼") strips. From strips, cut: 2 (3¼" × 36½") G rectangles.
- 5 (2½") strips. Piece strips together and cut into 4 (2½" × 43") E rectangles.
- 3 (1½") strips. Piece strips together and cut into 2 (1½" × 60½") H rectangles.

From stripe, cut:

- 3 (3") strips. Piece strips together to make 2 (3" × 43") F rectangles.
- 8 (2½") strips for binding.

From word print, cut:

- 3 (4½") strips. Piece strips together to make 2 (4½" × 60½") I rectangles.

Star Point Assembly

1. On the wrong side of cream star print B squares, draw a diagonal line from corner to corner. Draw lines $\frac{1}{4}$ " away from each side of the previously drawn line as shown in *Star Point Assembly Diagrams*.

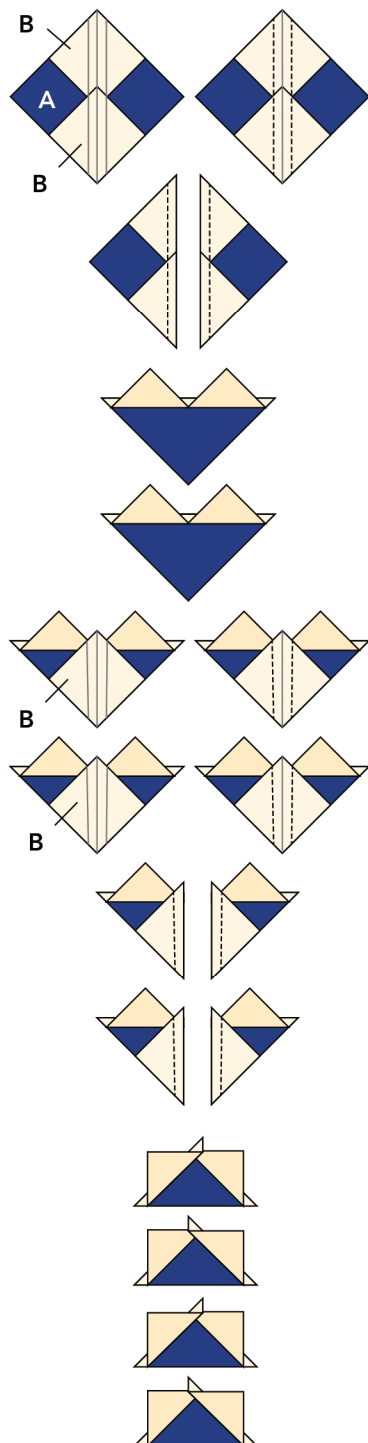

Star Point Assembly Diagrams

2. Place 2 marked B squares on blue star print A square, right sides together. Stitch on the outer marked lines. Cut on the centerline and press the seams toward the cream star print triangles as shown.
3. Place 2 marked B squares on the triangle units in Step 2 as shown in *Star Point Assembly Diagrams*. Stitch on the outer marked lines.
4. Cut on the centerline and press seams toward cream star print triangles, as shown, to make 4 cream star print/blue star print #1 Star Point Units.
5. Repeat steps 1 through 4 to make a total of 36 cream star print/blue star print #1 Star Point Units as shown in *Star Point Unit Diagrams*. Dog ears can be trimmed off at this stage.

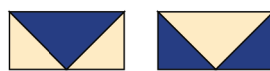

MAKE 36 MAKE 36
Star Point Unit Diagrams

6. In the same manner, make 36 blue star print/cream star print #2 Star Point Units using cream star print A squares and blue star print B squares.

Center Unit Assembly

1. On the wrong side of 72 red stonehenge print D squares draw a diagonal line from corner to corner as shown in *Center Unit Assembly Diagrams*.
2. Referring to the *Center Unit Assembly Diagrams*, place 1 red stonehenge print D square atop 1 multi-color star print C square, right sides facing. Stitch on the drawn line from corner to corner

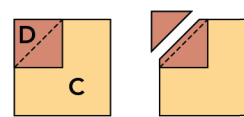

MAKE 9



MAKE 9

Center Unit Assembly Diagrams

as shown. Trim $\frac{1}{4}$ " beyond stitching. Press open.

3. Repeat on the remaining three corners of the multi-color star print C square to complete 1 Multi-Color Star Center Unit. Make 9 Multi-Color Star Center Units.
4. In the same manner, make 9 Waving Flag Center Units using red stonehenge print D squares and waving flag print C squares.

Star Block Assembly

1. Lay out 4 blue star print D squares, 4 cream star print/blue star print #1 Star Point Units and 1 Multi-Color Star Center Unit as shown in *Block Diagrams* on page 4.
2. Sew units together in rows. Sew rows together to make Block #1. Make 9 Block #1.
3. In the same manner, lay out 4 cream star print D squares, 4 blue star print/cream star print #2 Star Point Units and 1 Waving Flag Center Unit.
4. Sew units together in rows. Sew rows together to make Block #2. Make 9 Block #2.

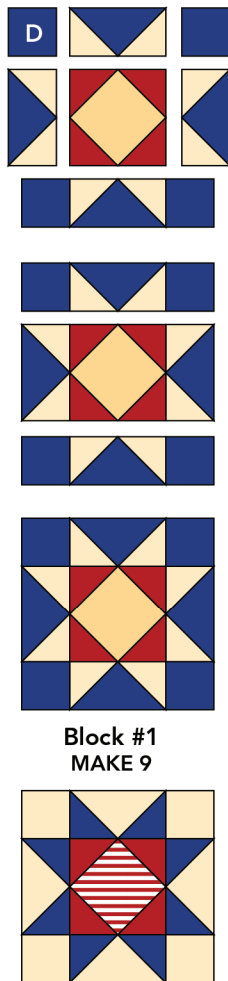

Block #1
MAKE 9

Block #2
MAKE 9

Block Diagrams

Quilt Top Assembly

1. Lay out 2 red stonehenge print E rectangles and 1 stripe F rectangle as shown in *Side Unit Diagrams*. Sew an E rectangle to opposite sides of the stripe F rectangle to create a side unit. Make 2 Side Units.

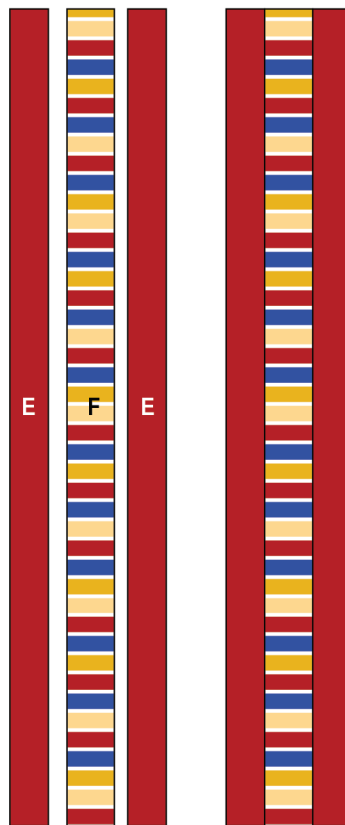

Side Unit Diagrams

2. Lay out 2 Side Units and the panel as shown. Sew a Side Unit to either side of the panel as shown in the *Quilt Top Assembly Diagram* on page 5.
3. Attach a red stonehenge print G rectangle to the top and bottom of the panel unit you just created to complete the Quilt Top Center.
4. Lay out 2 Star Block #1 and 2 Star Block #2, alternating as shown in *Quilt Top Assembly Diagram*. Sew together to make a side Star Block Unit. Make 2 Side Star Block Units. Attach a Side Star Block Unit to either side of the Quilt Top Center.

5. Layout out three Star Block #1 and 2 Star Block #2 as shown. Sew together in a row to create the top star block row. Attach to the top of the panel/star block unit created in step 4.
6. Layout out three Star Block #2 and 2 Star Block #1 as shown. Sew together in a row to create the bottom star block row. Attach to the bottom of the panel/star block unit created in step 5.
7. Attach a red stonehenge print H rectangle to the top and bottom of the panel/star block unit.
8. Attach a word print I rectangle to the top and bottom of the panel/star block unit to complete the quilt top.

Finishing

1. Divide backing into 2 (90") length panels. Join panels vertically.
2. Layer backing, batting, and quilt top; baste. Quilt as desired.
3. Join 2½"-wide stripe print binding strips into 1 continuous piece for double-fold binding. Add binding to quilt.



Quilt Top Assembly Diagram