

# Tivoli Garden

by Anne Rowan



Small Throw Quilt : 48" x 63"

  
WILMINGTON  
*Prints*

Wilmington *Prints*: A World of Possibilities  
[www.wilmingtonprints.com](http://www.wilmingtonprints.com)



# *Tivoli Garden* by Anne Rowan



Twin Quilt : 64" x 84"

Wilmington Prints: A World of Possibilities  
[www.wilmingtonprints.com](http://www.wilmingtonprints.com)





# Tivoli Garden

by Anne Rowan



Queen Quilt : 83" x 93"



Wilmington Prints: A World of Possibilities [www.wilmingtonprints.com/projects](http://www.wilmingtonprints.com/projects)



# Tivoli Garden

Please read all instructions carefully AND identify all fabrics before beginning.

All instructions include a 1/4" seam allowance and strips are cut selvage to selvage, unless stated otherwise.

## 1. Cut the following for Throw Quilt:

**Fabric A** - PLEASE NOTE: Panels do not always print the size intended. For this pattern, the panel has a coping border added then trimmed so the panel will fit the quilt correctly.

Fussy cut 1/4" beyond outside edges of panel to approximately 21-1/2" x 40-1/2"

**Fabric B** - Referring to the quilt image, fussy cut strips, the length of fabric parallel to selvage: (1) 7" x 67", (1) 7" x 55", (1) 7" x 52", and (1) 7" x 40" floral stripe borders. Cut each border in half lengthwise for (2) 3-1/2" x 67", (2) 3-1/2" x 55", (2) 3-1/2" x 52", and 2) 3-1/2" x 40" floral stripe borders.

**Fabric C** - Cut (3) 3-7/8" strips, subcut (30) 3-7/8" squares then cut in half diagonally for 60 triangles 

**Fabric D** - Cut (2) 5-1/2" strips  
Cut (2) 3-1/2" strips, subcut (2) 3-1/2" x 32" strips

**Fabric E** - Cut (3) 3-7/8" strips, subcut (30) 3-7/8" squares then cut in half diagonally for 60 triangles   
Cut (1) 3-1/2" strip, subcut (2) 3-1/2" squares strips

**Fabric F** - Cut (6) 2-1/2" strips (binding)  
Cut (3) 1-1/2" strips, sewn together end to end and cut into (2) 1-1/2" x 45-1/2" and (1) 1-1/2" x 30-1/2" strips for flat piping  
Cut (1) 1-1/2" strip, subcut (1) 1-1/2" x 30-1/2" strip for flat piping

## 2. Piecing Order for Throw Quilt:

1. Sew 1 each **Fabrics C** and **E** 3-7/8" triangles together along their long edges. Make a total of 60 Triangle Units (3-1/2" square unfinished).



2. Refer to Throw Quilt Layout (Page 4) for arrangement and placement of panel, strips, triangle units, squares, and borders.

3. Stitch **Fabric D** 5-1/2" x width of fabric strips to sides of the **Fabric A** panel. Trim strip ends even. Add 3-1/2" x 32" **Fabric D** strips to top and bottom of panel. **Trim bordered panel to 30-1/2" x 45-1/2" (unfinished).**

4. Fold and press **Fabric F** 1-1/2" x 45-1/2" and 1-1/2" x 30-1/2" strips in half lengthwise, right side out, forming 3/4" wide flat piping strips.

5. Baste 3/4" x 45-1/2" **Fabric F** flat piping strips on top of sides of quilt, with raw edges even with raw edges of **Fabric D** border. Baste 3/4" x 30-1/2" **Fabric F** flat piping on top of top and bottom of quilt, with raw edges even with raw edges of **Fabric D** border.

6. Center **Fabric B** 3-1/2" x 55" borders on right and left sides of bordered panel and **Fabric B** 3-1/2" x 40" borders on top and bottom of bordered panel with the dark edges next to quilt center. Stitch borders to sides starting and stopping 1/4" from corners of quilt center. Do not trim. Press borders out so flat piping lays over **Fabric D** border.

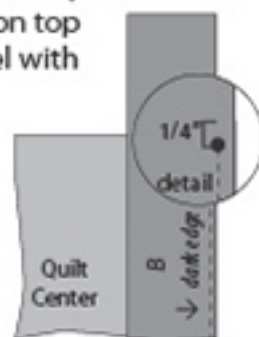

Letters in italics indicate wrong side of fabric.

7. Working with 1 corner at a time, fold the quilt right sides together so the outside edges of the borders line up. Using a 45-degree ruler, mark from the end of border seams to outer edges of borders. Stitch along marked line. Trim seam allowance to 1/4". Press corner seam open. Repeat on remaining corners.

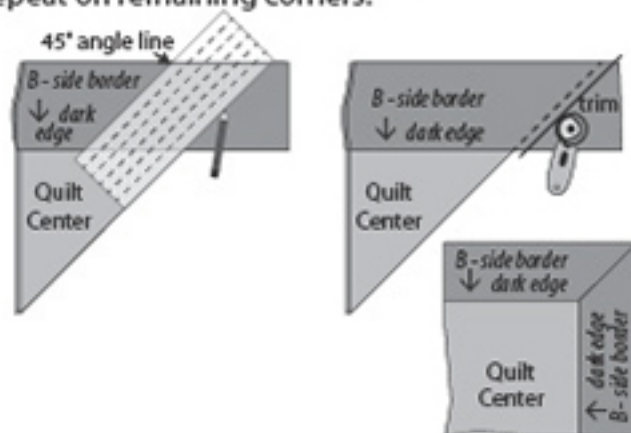

# Tivoli Garden

8. Arrange 16 triangle units and 1 **Fabric E** 3-1/2" square in vertical rows on each side of the quilt. Sew into rows (3-1/2" x 51-1/2" unfinished). Stitch to right and left sides of quilt.

9. Arrange 14 triangle units in horizontal rows on top and bottom of the quilt. Sew into rows (3-1/2" x 42-1/2" unfinished). Stitch to top and bottom of quilt.

10. Center **Fabric B** 3-1/2" x 67" borders on right and left sides of bordered panel and **Fabric B** 3-1/2" x 52" borders on top and bottom of quilt with the floral edges next to quilt center. Refer to Steps 6 and 7 to stitch and miter borders.

11. The throw quilt measures approximately 48-1/2" x 63-1/2" (unfinished). Make backing (**Fabric I**) approximately 8" larger than the top.

12. Layer and baste top, batting, and backing together. Quilt as desired. Attach binding (**Fabric F**) and enjoy!!

## 3. Cut the following for Twin Quilt:

### Fabrics A, B, C, D, and E:

Refer to Throw Quilt cutting directions

**Fabric F** - Cut (8) 2-1/2" strips (binding)

Cut (9) 1-1/2" strips, sewn together end to end and cut into (2) 1-1/2" x 68-1/2", (2) 1-1/2" x 53-1/2", (2) 1-1/2" x 45-1/2", and (1) 1-1/2" x 30-1/2" strips for flat piping

Cut (1) 1-1/2" strip, subcut (1) 1-1/2" x 30-1/2" strip for flat piping

**Fabric G** - Cut (6) 3" strips, sewn together end to end and cut into (2) 3" x 63-1/2" and (2) 3" x 53-1/2" borders

**Fabric H** - Cut (4) 8-1/2" strips, sewn together end to end and cut into (2) 8-1/2" x 64-1/2" borders

Cut (4) 6" strips, sewn together end to end and cut into (2) 6" x 68-1/2" borders

## 4. Piecing Order for Twin Quilt:

1. Refer to Piecing Order for Throw Quilt Steps 1-10 to make quilt center.

2. Refer to Twin Quilt Layout (Page 5) for arrangement and placement of quilt center, flat piping strips, and borders.

3. Stitch **Fabric G** 3" x 63-1/2" borders to right and left sides of quilt center. Add **Fabric G** 3" x 53-1/2" borders to top and bottom of quilt.

4. Fold and press **Fabric F** 1-1/2" x 68-1/2" and 1-1/2" x 53-1/2" strips in half lengthwise, right side out, forming 3/4" wide flat piping strips.

5. Baste 3/4" x 68-1/2" **Fabric F** flat piping strips on top of sides of quilt, with raw edges even with raw edges of **Fabric G** border. Baste 3/4" x 53-1/2" **Fabric F** flat piping on top of top and bottom of quilt, with raw edges even with raw edges of **Fabric G** border.

6. Stitch **Fabric H** 6" x 68-1/2" borders to right and left sides of quilt. Press toward borders leaving flat piping over **Fabric G** borders. Add **Fabric H** 8-1/2" x 64-1/2" borders to top and bottom of quilt. Press toward borders leaving flat piping over **Fabric G** borders.

7. The twin quilt measures approximately 64-1/2" x 84-1/2" (unfinished). Make backing (**Fabric I**) approximately 8" larger than the top.

8. Layer and baste top, batting, and backing together. Quilt as desired. Attach binding (**Fabric F**) and enjoy!!



# Tivoli Garden

## 5. Cut the following for Queen Quilt:

### Fabrics A, B, D, and E:

Refer to Throw Quilt cutting directions

**Fabric C** - Cut (4) 9-1/2" strips, sewn together end to end and cut into (2) 9-1/2" x 68-1/2" borders

Cut (4) 8" strips, sewn together end to end and cut into (2) 8" x 71-1/2" borders

Cut (3) 3-7/8" strips, subcut (30) 3-7/8" squares then cut in half diagonally for 60 triangles

**Fabric F** - Cut (10) 2-1/2" strips (binding)

Cut (9) 1-1/2" strips, sewn together end to end and cut into (2) 1-1/2" x 68-1/2", (2) 1-1/2" x 53-1/2", (2) 1-1/2" x 45-1/2", and (1) 1-1/2" x 30-1/2" strips for flat piping

Cut (1) 1-1/2" strip, subcut (1) 1-1/2" x 30-1/2" strip for flat piping

**Fabric G** - Cut (6) 3" strips, sewn together end to end and cut into (2) 3" x 63-1/2" and (2) 3" x 53-1/2" borders

**Fabric H** - Cut (4) 6-1/2" strips, sewn together end to end and cut into (2) 6-1/2" x 83-1/2" borders

Cut (4) 5-1/2" strips, sewn together end to end and cut into (2) 5-1/2" x 83-1/2" borders

## 6. Piecing Order for Queen Quilt:

1. Refer to Piecing Order for Throw Quilt Steps 1-10 to make quilt center.

2. Refer to Piecing Order for Twin Quilt Steps 3-5 to add **Fabric G** border and **Fabric F** flat piping strips.

3. Refer to Queen Quilt Layout (Page 6) for arrangement and placement of quilt center, flat piping strips, and borders.

4. Stitch **Fabric C** 9-1/2" x 68-1/2" borders to right and left sides of quilt center. Press borders out so **Fabric F** flat piping lays over **Fabric G** border. Add **Fabric C** 8" x 71-1/2" borders to top and bottom of quilt. Press borders out so **Fabric F** flat piping lays over **Fabric G** border.

5. Stitch **Fabric H** 6-1/2" x 83-1/2" borders to right and left sides of quilt. Add **Fabric H** 5-1/2" x 83-1/2" borders to top and bottom of quilt.

6. The queen quilt measures approximately 83-1/2" x 93-1/2" (unfinished). Make backing (**Fabric I**) approximately 8" larger than the top.

7. Layer and baste top, batting, and backing together. Quilt as desired. Attach binding (**Fabric F**) and enjoy!!

# Tivoli Garden

## THROW QUILT LAYOUT

Border measurements are the cut size.

Arrow indicates orientation of directional print.

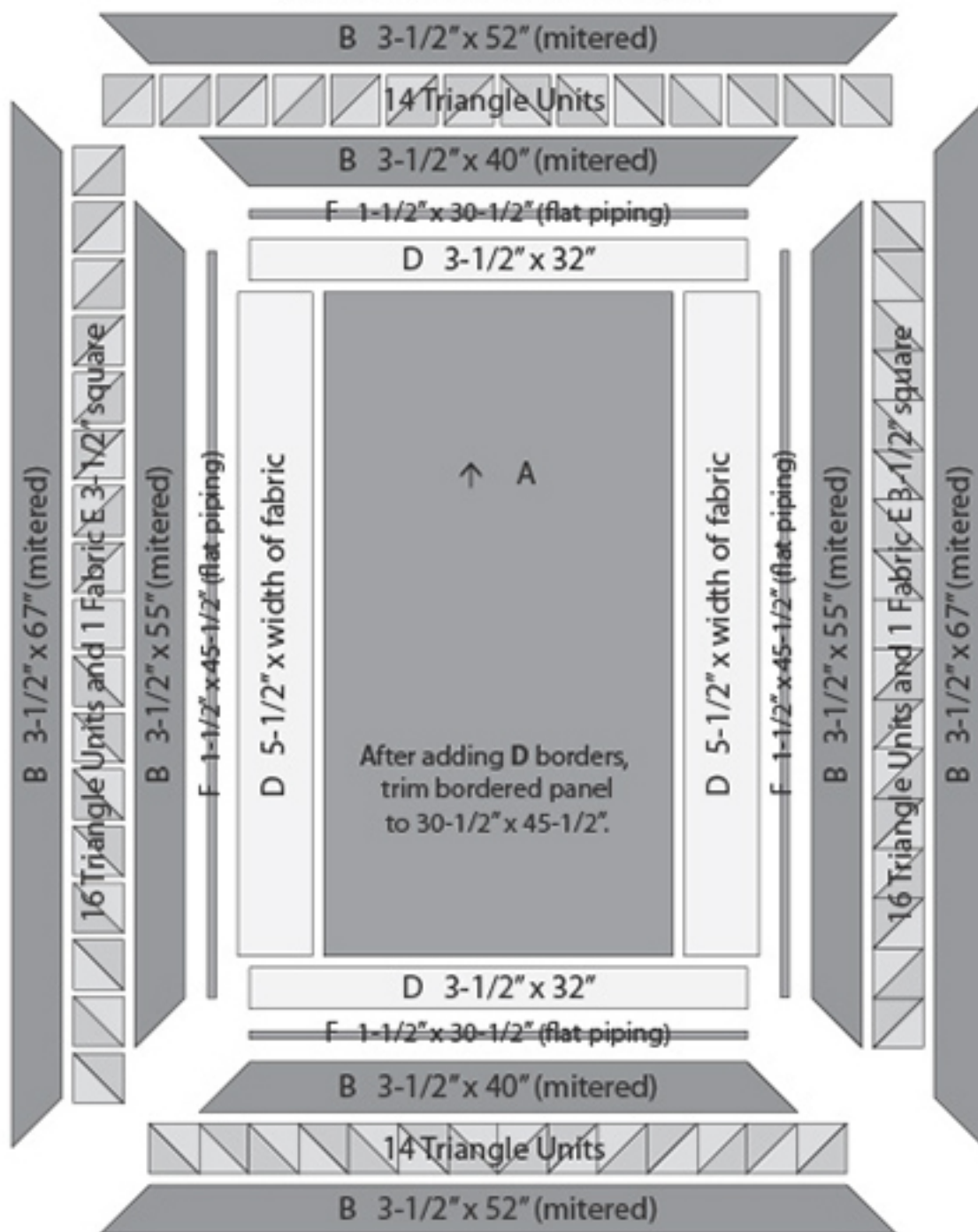

# Tivoli Garden

## TWIN QUILT LAYOUT

Border measurements are the cut size.

Arrows indicate orientation of directional prints.

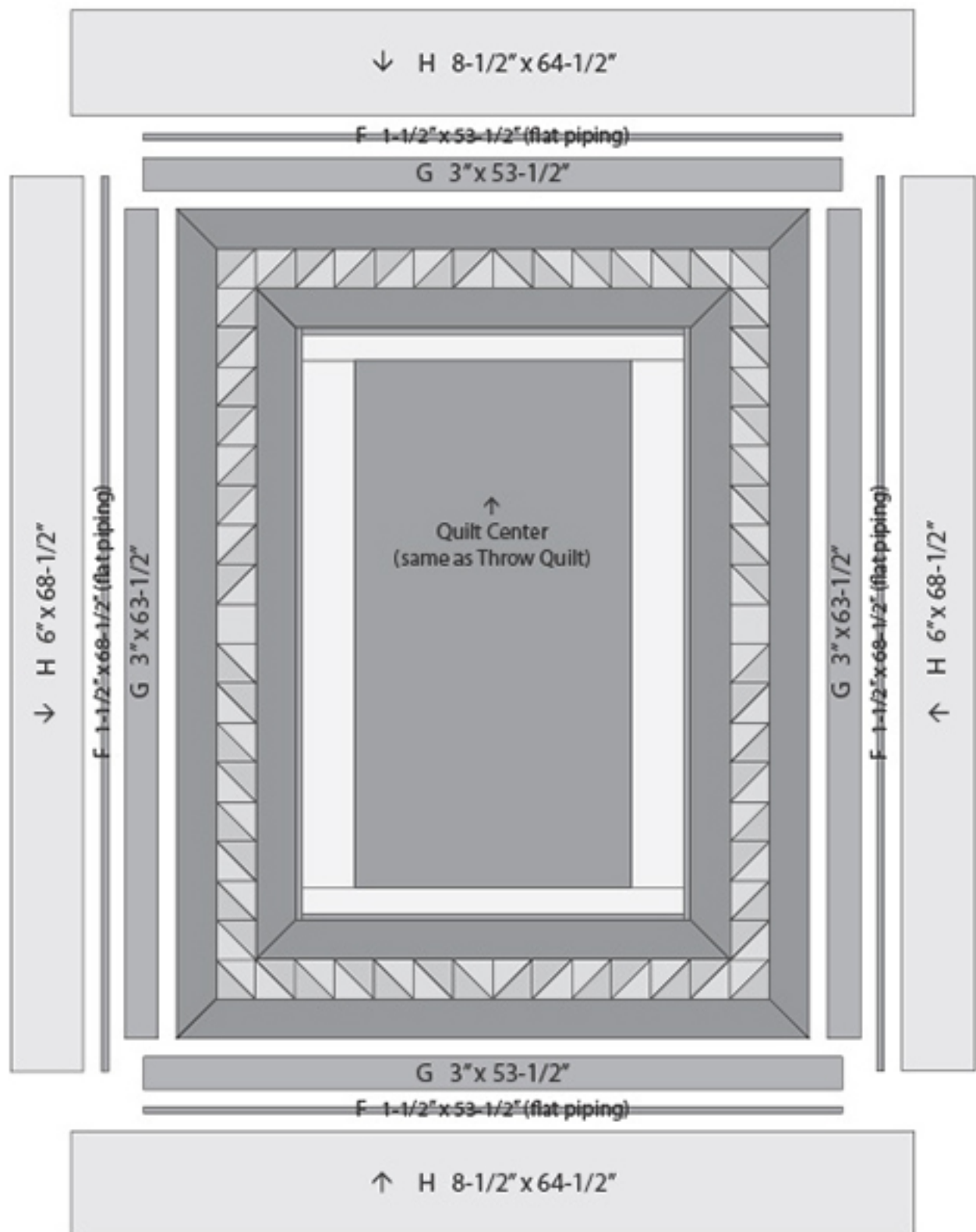



# Tivoli Garden

## QUEEN QUILT LAYOUT

Border measurements are the cut size.

Arrows indicate orientation of directional prints.

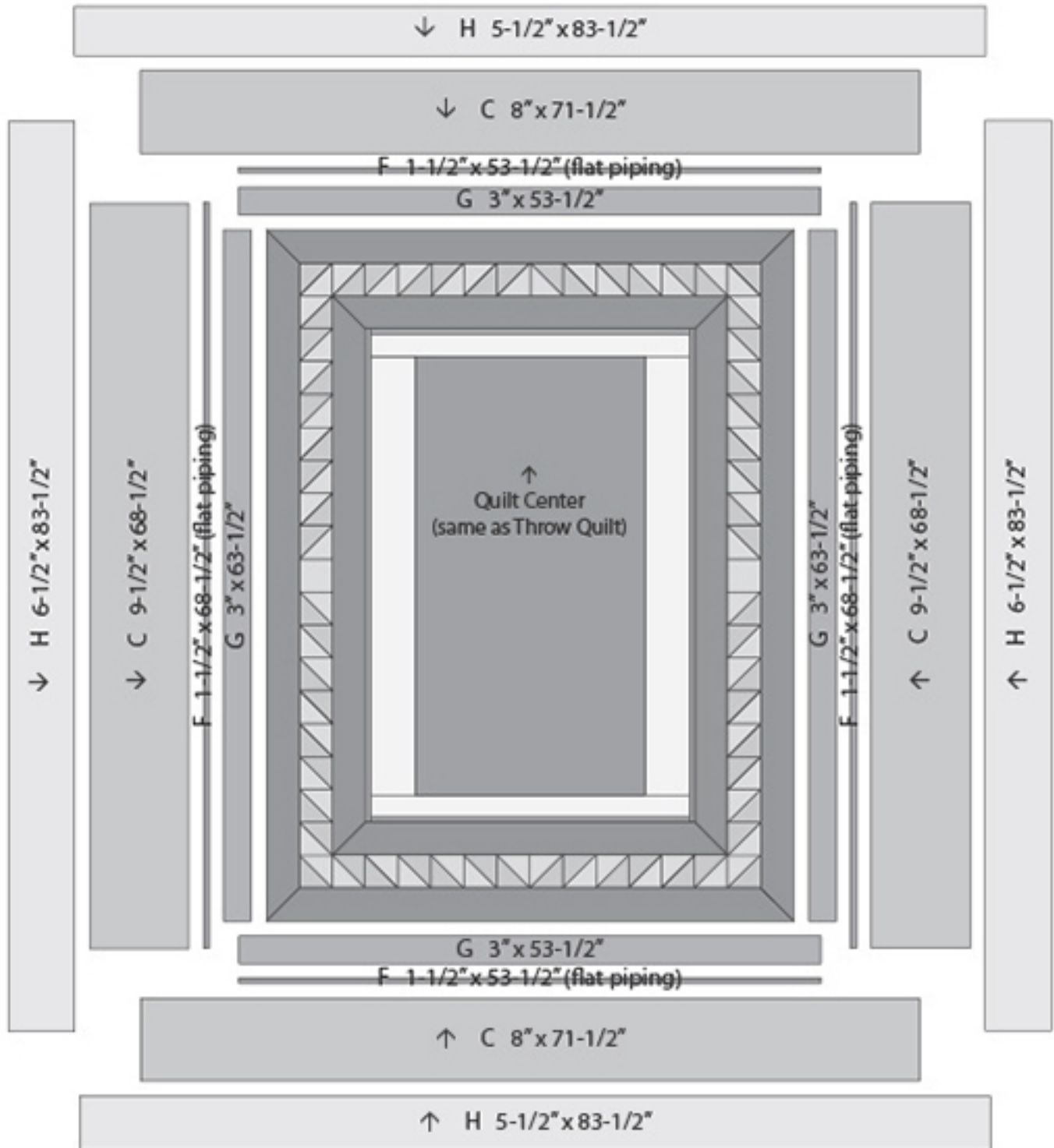



# Q3007 *Tivoli Garden* by Anne Rowan

## Fabric & Yardage Needed:

S=Small Throw, TW=Twin, Q=Queen



Fabric A (24" x 43" panel)  
Q3007-68400-937  
All sizes 2/3 yd. (1 panel)



Fabric B (24" repeat)  
Q3007-68401-973  
All sizes 2-1/8 yds.



Fabric C  
Q3007-68402-930  
S 1/2 yd. TW 1/2 yd.  
Q 2-5/8 yds.



Fabric D  
Q3007-68404-117  
All sizes 5/8 yd.



Fabric E  
Q3007-68407-319  
All sizes 5/8 yd.



Fabric F  
(flat insert & binding)  
Q1825-85507-700  
S 7/8 yd. TW 1-1/4 yds. Q 5/8 yd.  
Q1-3/8 yds.



Fabric G  
Q3007-68405-331  
TW 5/8 yd.  
Q 5/8 yd.



Fabric H  
Q3007-68408-133  
TW 1-7/8 yds.  
Q 1-5/8 yds.



Fabric I (backing only)  
Q3007-68406-138  
S 3-1/4 yds.  
TW 5-1/4 yds.  
Q 7-3/4 yds.

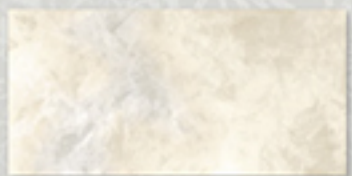

Fabric I (108" backing)  
Q1054-2079-109  
TW 2-1/8 yds.  
Q 2-2/3 yds.

OR

Patterns shown at 25%  
unless otherwise indicated.

