

7. Assemble the top/bottom borders following the diagrams below using **BORDER BLOCKS 1, 2 and 3.**

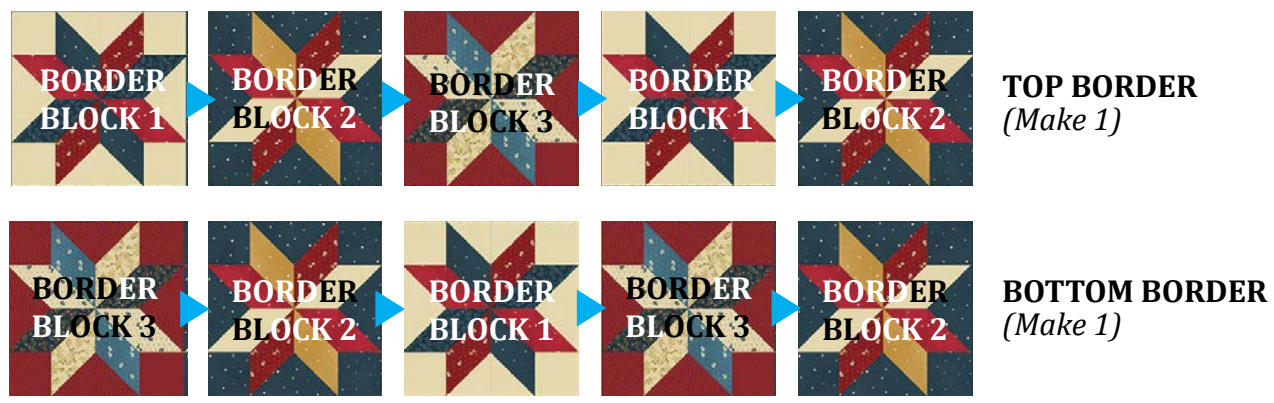

QUILT DIAGRAM



Finished Quilt Size: 40" W x 60" L

QUILT ASSEMBLY

8. Sew (1) **O** 1" x 40-1/2" strip to left and (1) to right side of trimmed **A** panel.
9. Sew **LEFT BORDER** to left side of **Quilt Center**, then sew **RIGHT BORDER** to right side of **Quilt Center**. (Note rotation)
10. Sew (1) **E** 2-1/2" x 40-1/2" strip to top and (1) to bottom of **Quilt Center**.
11. Then sew **TOP BORDER** to the top of **Quilt Center** and sew **BOTTOM BORDER** to the bottom of **Quilt Center**.

FINISHING:

Cut batting and backing 3" larger than top on all sides. Layer backing, batting and top together and baste or pin. When quilting is completed, trim excess batting and backing. Bind as usual.

Note: If this Benartex pattern is included in a kit, any questions about the kit should be addressed to the vendor from whom you bought it.

Americana Folk

Designed by Benartex Studios

One "Liberty Hill" panel plus border blocks makes a handsome wallhanging that will surely become a family heirloom. Choose from the "Freedom" panel or "Family and Friends" or make both! A beautiful example of American Folkart.

Uses Benartex's Liberty Hill collection by Cheryl Haynes
Finished Size: 40" x 60"

Benartex
Fabric for quilters. By quilters.

THE QUILT SHOWN IS A DIGITAL REPRESENTATION. ACTUAL FABRIC REPEATS WILL VARY FROM DESIGN SHOWN.

SAMPLE	KEY/SKU	QTY	CUT
A	Freedom Panel/ Faith Panel 2540-55/2541-55 Blue/Multi	1 Panel	Panel should measure 24" x WOF. Trim length to 40 1/2".
B	Flags 2542-10 Red	1/4 yd	(8) 4-7/8" squares, cut in half diagonally to yield 16 HST's
C	Flags 2542-55 Dark Blue	1/4 yd	(6) 4-7/8" squares, cut in half diagonally to yield 12 HST's
D	Twill Daisy Stripe 2543-10 Red	1/3 yd	(5) 2 1/4" x WOF strips, <i>BINDING</i>
E	Twill Daisy Stripe 2543-55 Blue	1/4 yd	(2) 2 1/2" x 40 1/2" strips
F	Daisy Dot 2544-07 Cream	1/8 yd	(6) 2-7/8" squares, cut in half diagonally to yield 12 HST's
G	Daisy Dot 2544-10 Red	1/8 yd	(14) 2-7/8" squares, cut in half diagonally to yield 28 HST's
H	Daisy Dot 2544-50 Blue	1/4 yd	(6) 2-7/8" squares, cut in half diagonally to yield 12 HST's (6) 3-7/8" squares, cut in half diagonally to yield 12 HST's
I	Cheryl's Dot 2546-10 Red	1/4 yd	(14) 2-7/8" squares, cut in half diagonally to yield 28 HST's (6) 3-7/8" squares, cut in half diagonally to yield 12 HST's
J	Cheryl's Dot 2546-33 Honey	1/4 yd	(8) 2-7/8" squares, cut in half diagonally to yield 16 HST's (8) 3-7/8" squares, cut in half diagonally to yield 16 HST's
K	Cheryl's Dot 2546-55 Dark Blue	1/4 yd	(16) 2 1/2" squares; (22) 2-7/8" squares, cut in half diagonally to yield 44 HST's.
L	Twill 2547-07 Cream	3/8 yd	(12) 2 1/2" squares; (20) 2 7/8" squares, cut in half diagonally to yield 40 HST's, (8) 3 7/8" squares, cut in half diagonally to yield 16 HST's
M	Twill 2547-10 Red	1/3 yd	(12) 2 1/2" squares (12) 2-7/8" squares cut in half diagonally to yield 24 HST's (6) 3-7/8" squares cut in half diagonally to yield 12 HST's
N	Leaves & Berries 2549-52 Blue/Multi	1/8 yd	(6) 2-7/8" squares, cut in half diagonally to yield 12 HST's
O	Leaves & Berries 2549-55 Dark Blue	1/3 yd	(6) 2-7/8" squares, cut in half diagonally to yield 12 HST's (6) 3-7/8" squares, cut in half diagonally to yield 12 HST's (2) 1" x WOF strips.
P	Leaves & Berries 2549-70 Natural	1/4 yd	(6) 2-7/8" squares, cut in half diagonally to yield 12 HST's (6) 4-7/8" squares, cut in half diagonally to yield 12 HST's

WOF = WIDTH OF FABRIC

*SEW STRIPS VIA SHORT ENDS, THEN SUBCUT AS INDICATED



SIDE BORDER BLOCKS & ASSEMBLY

- Sew (1) **M** 3-7/8" HST to (1) **I** 3-7/8" HST. Then sew (1) **C** 4-7/8" HST to **MI** HST. Square to 4-1/2" to make **CMI Unit**. *Make 4.*
- Sew the 4 **CMI Units** together as shown in diagram below to create **SIDE BLOCK 1**. *Square to 8-1/2"*
- Repeat steps 1 & 2 replacing **C,M,I** fabrics with **B,L,J** then **P,O,H** fabrics to create **SIDE BLOCKS 2** and **3**.
- Assemble the side borders following the diagrams below using **SIDE BLOCKS 1,2 & 3**.

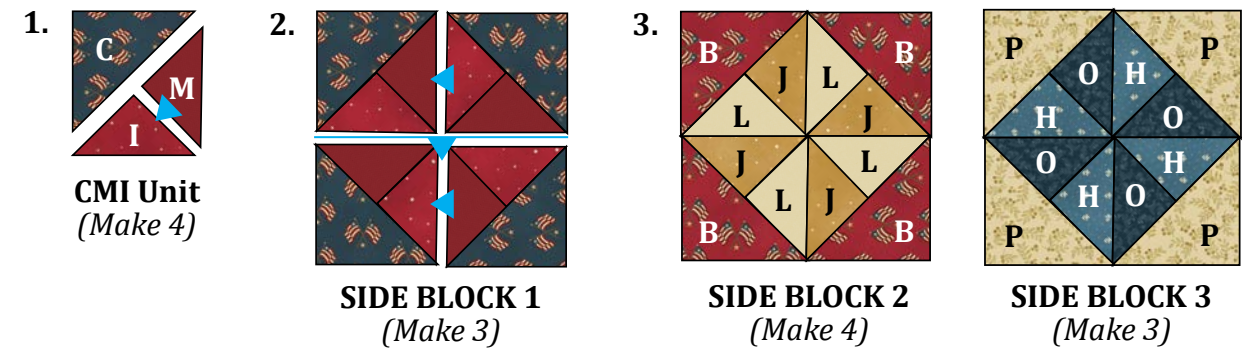

- Assemble the side borders following the diagrams below using **SIDE BLOCKS 1,2 & 3**.

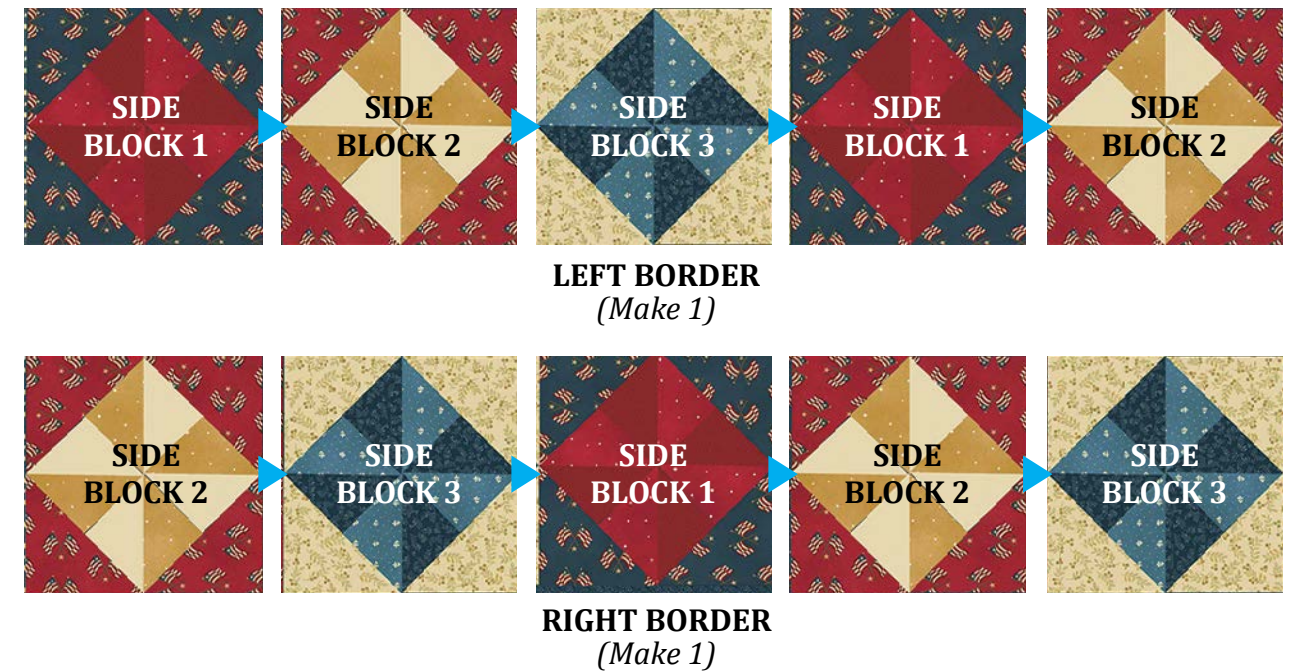

TOP/BOTTOM BORDER BLOCKS & ASSEMBLY

- Using 2-1/2" squares and 2-1/2" HST's, create **BORDER BLOCKS 1,2** and **3** following the diagrams below. *Square to 8-1/2"*

