

Leaves

Quilt is 55" x 70".

Supplies

Leaves and Sashing

12 Fat Quarters*

Background and Borders

3½ yards

Binding: ⅝ yard

Backing: 4⅓ yards

*Fat Quarter = 18" x 22"

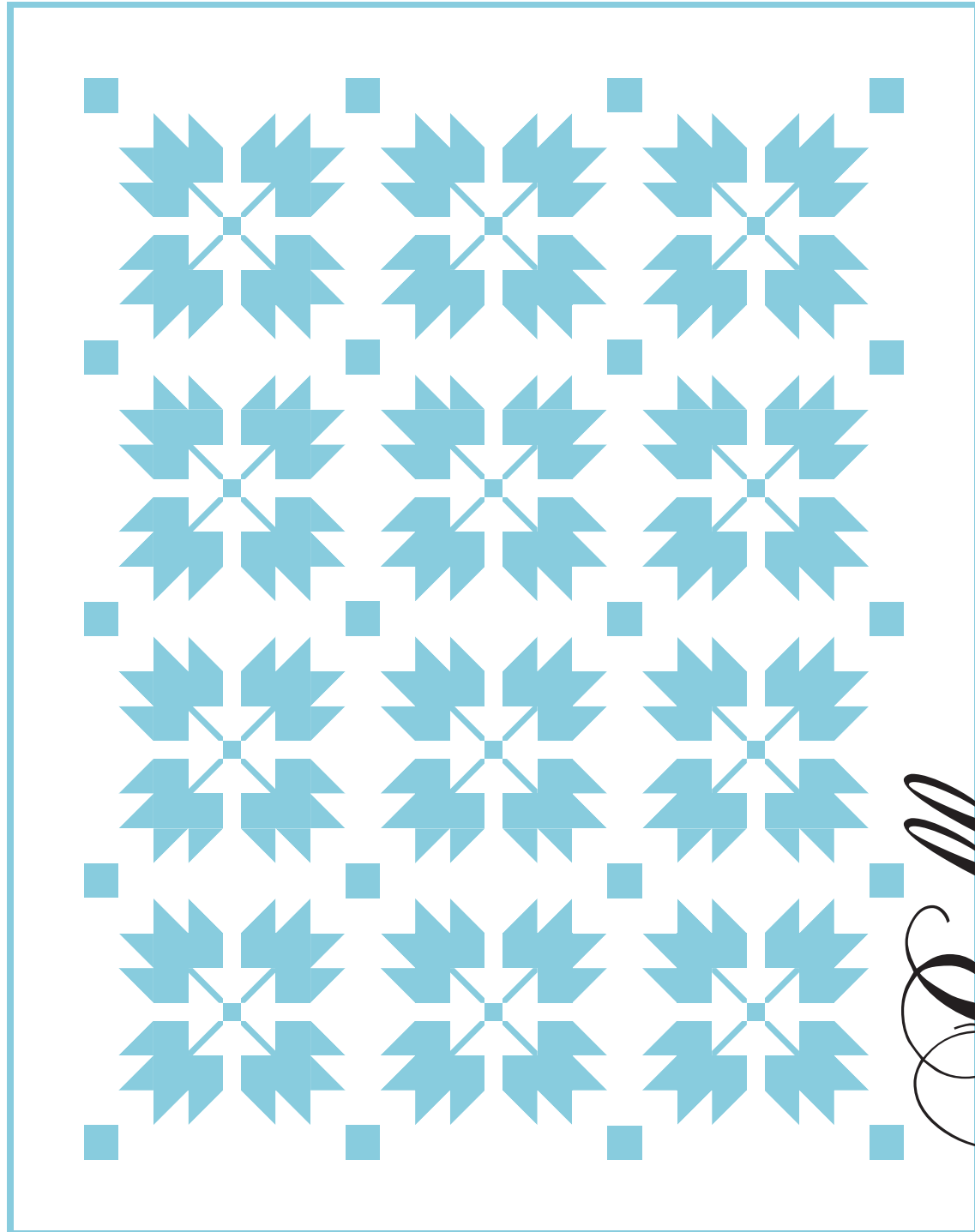

moda
Bella[™]
Solids

12 pack

Which colors will you choose?

Leaves

Quilt is 55" x 70".



moda

MODAFABRICS.COM

BSPK14011 — SUGGESTED RETAIL \$6.00

- 5 Join 5 sashing rows, and 4 leaf rows as shown. Sew the $4\frac{1}{2}$ " x $62\frac{1}{2}$ " border strips to the quilt sides. Sew the $4\frac{1}{2}$ " x $55\frac{1}{2}$ " border strips to the top and bottom. Layer, quilt, and bind.

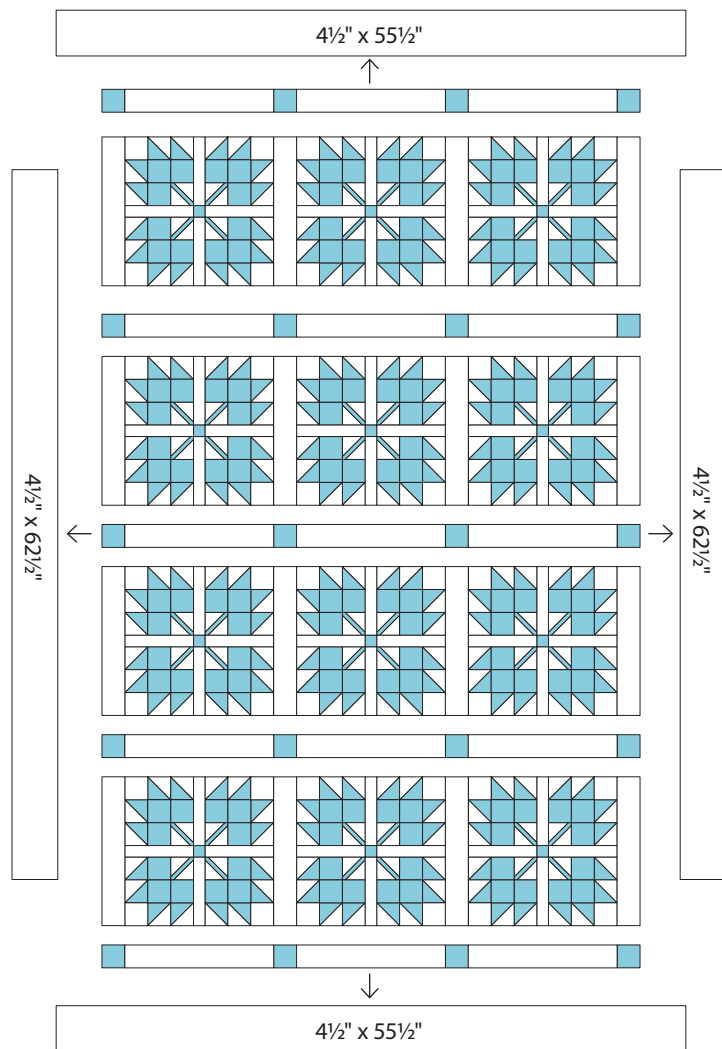

moda

Leaves

Quilt is 55" x 70".

Cutting

Leaves and Sashing

From EACH of the 12 Fat Quarters cut

2-3" x 22" strips

From the strips, cut 8-3" squares

3- $2\frac{1}{2}$ " x 22" strips

From the strips, cut 18- $2\frac{1}{2}$ " squares and 1- $1\frac{1}{2}$ " square

Background and Borders

2- $13\frac{1}{2}$ " x width of fabric strips

From the strips, cut 31- $13\frac{1}{2}$ " x $2\frac{1}{2}$ " strips

2- $6\frac{1}{2}$ " x width of fabric strips

From the strips, cut 48- $6\frac{1}{2}$ " x $1\frac{1}{2}$ " rectangles

7- $4\frac{1}{2}$ " x width of fabric strips

Sew the strips end to end. From this long strip, cut 2- $4\frac{1}{2}$ " x $62\frac{1}{2}$ " and
2- $4\frac{1}{2}$ " x $55\frac{1}{2}$ " borders.

8-3" x width of fabric strips

From the strips, cut 96-3" squares

3- $2\frac{1}{2}$ " x width of fabric strips

From the strips, cut 48- $2\frac{1}{2}$ " squares

6- $2\frac{1}{4}$ " x width of fabric strips

From the strips, cut 96- $2\frac{1}{4}$ " squares

Binding

7- $2\frac{1}{2}$ " x width of fabric strips

Sew the strips end to end to make the binding.

moda

Construction Use $\frac{1}{4}$ " seams. Press in the direction of the arrows in the diagrams.

1 Leaves

(A) Draw a diagonal line from corner to corner on the wrong side of $96-3"$ background squares. Layer the marked background square and a $3"$ leaf square right sides together. Sew $\frac{1}{4}"$ from each side of the diagonal line. Cut on the diagonal line. Press open to make 2 half square triangle blocks. Trim to $2\frac{1}{2}"$ square. Repeat to make 16 half square triangles (HST) from EACH of the 12 leaf fabrics.

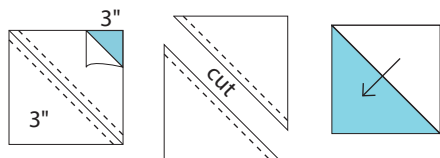

$2\frac{1}{2}" \times 2\frac{1}{2}"$ unfinished
Make 16 HST from EACH
of the 12 fabrics.

(B) Draw a diagonal line from corner to corner on the wrong side of a $96-2\frac{1}{4}"$ background squares. Layer the marked background square and a $2\frac{1}{2}"$ leaf square right sides together as shown. Sew on the diagonal line. Cut $\frac{1}{4}"$ from the diagonal line. Press to form a triangle on the corner. Repeat on the opposite corner of the same leaf square. Repeat to make 4 from EACH of the 12 leaf fabrics.

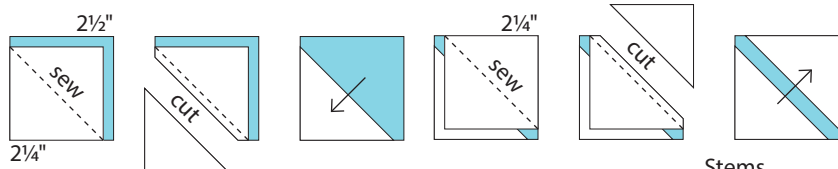

Stems
Make 4 from EACH
of the 12 fabrics.

moda

(C) Arrange and sew 4 matching half square triangles, 3- $2\frac{1}{2}"$ leaf squares, 1 stem, and 1- $2\frac{1}{2}"$ background square in 3 rows as shown. Join the rows. Repeat to make 48 leaves, 4 from EACH of the 12 leaf fabrics.

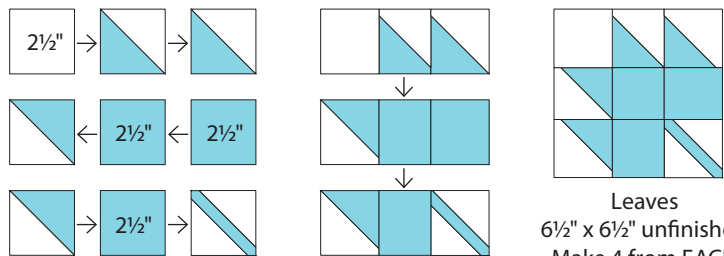

Leaves
 $6\frac{1}{2}" \times 6\frac{1}{2}"$ unfinished
Make 4 from EACH
of the 12 fabrics.

2 Arrange and sew 4 leaves, $1-1\frac{1}{2}"$ sashing square, and $4-1\frac{1}{2}" \times 6\frac{1}{2}"$ background rectangles in 3 rows as shown. Press away from the leaves. Join the rows. Repeat to make 12 leaf blocks.

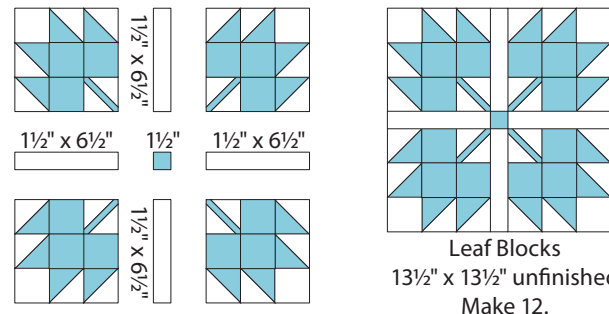

Leaf Blocks
 $13\frac{1}{2}" \times 13\frac{1}{2}"$ unfinished
Make 12.

moda

3 Arrange and sew 3 leaf blocks, and $4-13\frac{1}{2}" \times 2\frac{1}{2}"$ background rectangles in a row as shown. Repeat to make 4 leaf rows.

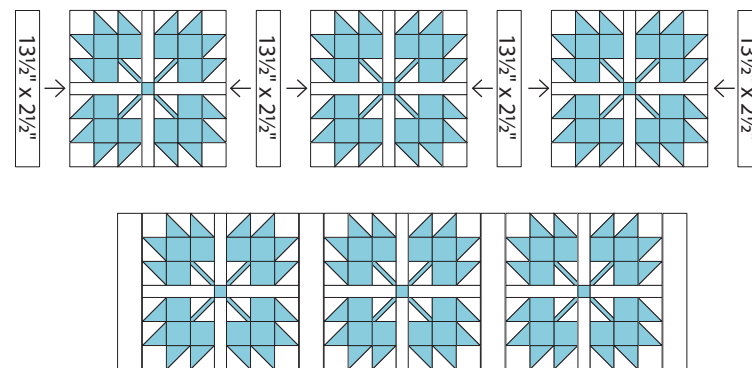

Leaf Rows
 $13\frac{1}{2}" \times 47\frac{1}{2}"$ unfinished
Make 4.

4 Arrange and sew $4-2\frac{1}{2}"$ sashing squares, and $3-13\frac{1}{2}" \times 2\frac{1}{2}"$ background rectangles in a row as shown. Repeat to make 5 sashing rows.

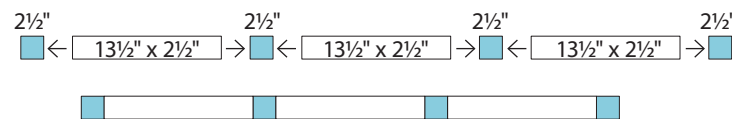

Sashing Rows
 $2\frac{1}{2}" \times 47\frac{1}{2}"$ unfinished
Make 5.