

CHICKADEE STARS

DESIGN BY JACKIE ROBINSON



Another gorgeous quilt pattern by Jackie Robinson!
Her new collection *Chickadees and Berries* is sure to be a classic.
Beautiful winter chickadees and bright holly fabrics
make lovely star centers.
This quilt will add a touch of winter charm to any room.

Uses Benartex's *Chickadees and Berries* collection by Jackie Robinson
Finished Size: 58-1/2" x 56-1/2"

Benartex
Fabric for quilters. By quilters.

BENARTEX, LLC • 132 WEST 36TH STREET • 4TH FLOOR • NEW YORK, NY 10018 • 212.840.3250 • WWW.BENARTEX.COM

THE QUILT SHOWN IS A DIGITAL REPRESENTATION. ACTUAL FABRIC REPEATS WILL VARY FROM DESIGN SHOWN.

©2014 Jackie Robinson for Benartex, LLC







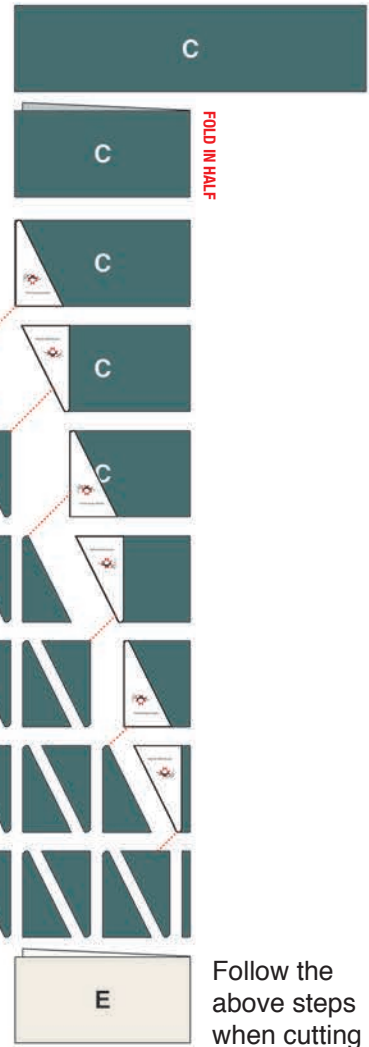

This project uses precise 1/4" seams. To test your seam allowance, accurately cut (2) 2-1/2" x 5" rectangles. Stitch them together along the 5" length. At the midpoint, measure across the unit. It should be exactly 4-1/2" wide. If not, adjust your seam allowance and repeat.

1 Use the Half Rectangle Template below OR use a Tri Recs or a Half Rectangle tool to cut Half Rectangle shapes from the 6" strips of *Chickadees & Holly Allover* (C) and from *Golden Pine* (E). Fold each strip (C shown as an example) in half, selvedge to selvedge. Place the template and pin it through the folded fabric and cut. Then rotate the template 180°. DO NOT FLIP IT OVER. Place, pin, and cut another. Continue to rotate and cut until there are 10 going across, which will also give you 10 of the mirror image on the underside of the folded fabric.



THUMBNAILKEY	SKU/COLOR	QTY	CUT
	A Chickadees & Berries Panel 4741M-99 Multi	1 panel	(1) 11-1/2" x 22-1/2" center panel (2) 11-1/2" x 6-1/2" top & bottom Motifs (4) 5" x 6-1/2" corners (2) 5" squares (Chickadee/Blue) (2) 5" squares (Chickadee/Wreath) (2) 5" squares (Holly)
	B Grand Fir 4744M-55 Blue	1-1/8 yds	Cut (3) 2-3/4" x WOF strips, then Subcut (32) 2-3/4" squares (4) 2" squares Cut (6) 2-1/2" strips for Binding Cut (6) 2" x WOF strips, then Subcut (2) 2" x 56" rectangles (2) 2" x 54" rectangles
	C Chickadees & Holly Allover 4742M-80 Teal	5/8 yd	Cut (1) 6" x WOF strip Cut (3) 3-1/2" x WOF strips, then Subcut (24) 3-1/2" squares (2) 2-3/4" squares Cut (1) 2-3/4" x WOF strip, then Subcut (14) 2-3/4" squares
	D Holly & Berries 4743M-33 Gold	1/4 yd	Cut (3) 2-3/4" x WOF strips, then Subcut (32) 2-3/4" squares (12) 2" squares
	E Golden Pine 4745M-07 Parchment	2-3/8 yds	Cut (1) 6" x WOF strip Cut (2) 9-1/2" x WOF strips, then Subcut (2) 9-1/2" x 10" rectangles (4) 9-1/2" x 9-3/4" rectangles (2) 9-1/2" x 1-1/4" rectangles (2) 10-1/4" x 3" rectangles (4) 3-1/4" squares Cut (1) 5-1/4" x WOF strip, then Subcut (2) 5-1/4" x 12" rectangles (4) 2-3/4" squares Cut (4) 3-1/2" x WOF strips, then Subcut (12) 3-1/2" x 6-1/2" rectangles (8) 3-1/2" x 3-1/4" rectangles (16) 3-1/2" x 2-3/4" rectangles Cut (7) 2-3/4" x WOF strips, then Subcut (40) 2-3/4" x 5" rectangles (28) 2-3/4" squares Cut (6) 2" x WOF strips, then Subcut (2) 2" x 53" rectangles (2) 2" x 51" rectangles Cut (1) 1-1/2" x WOF strip, then Subcut (2) 1-1/2" x 21-1/2" rectangles (use left over 2" if needed)

WOF = WIDTH OF FABRIC

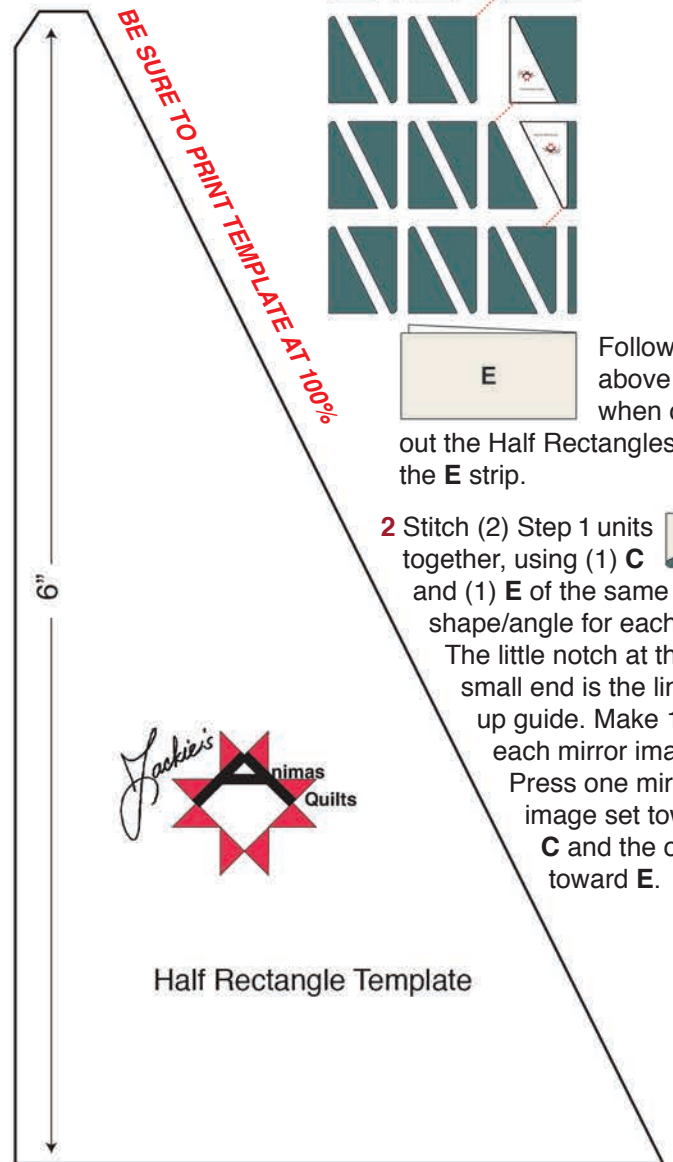

Follow the above steps when cutting out the Half Rectangles from the E strip.

2 Stitch (2) Step 1 units together, using (1) C and (1) E of the same shape/angle for each unit. The little notch at the small end is the line up guide. Make 10 of each mirror image. Press one mirror image set toward C and the other toward E.



Half Rectangle Template

3 Stitch one each of the mirror image Step 2 units together. Because of the opposite pressing, the seam will “nest” where it meets. Make 10. Each unit will measure 3-1/4” x 11-1/2”.



4 As shown below, sew two pair of Step 3 units together. The length will measure 22-1/2”.



Then, as shown right, stitch the pair to each side of the 11-1/2” x 22-1/2” *Center Panel*.

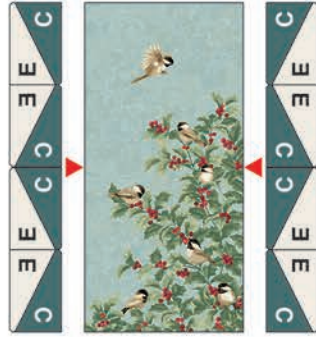

5 As shown below, add a 3-1/4” E square to both ends of two of the remaining Step 3 units.



Then, as shown right, attach them to the top and bottom of the *Center Panel*. Press gently.



6 Sew the remaining (4) Step 3 units above and below the 11-1/2” x 6-1/2” *Top* and *Bottom Motifs*.



7 Diagonally stitch a 3-1/2” C square to the left side of a 3-1/2” x 6-1/2” E rectangle. Then trim excess. Press toward C. Make 12 units.



8 Following the same method for the (12) Step 7 units, add another 3-1/2” diagonally stitched square of C to the right side. Then trim excess. Press toward C. Each unit will measure 6-1/2” x 3-1/2”.



9 As shown right, add a 3-1/2” x 3-1/4” E to both ends of 4 of the Step 8 units.



Stitch these units to the sides of the Step 6 *Top* and *Bottom Motifs*.

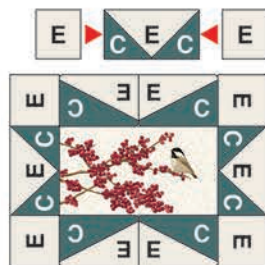

10 Sew the remaining 8 of the Step 8 units to both sides of the 5” x 6-1/2” *Corner Stars*.



11 As in Steps 7, 8 and 9, diagonally stitch 2-3/4” squares of C to a 2-3/4” x 5” E rectangle.



Add a 2-3/4” x 3-1/2” E to both sides. Make 8 units.

12 Stitch the Step 11 units to the top and bottom of the Step 10 *Corner Stars*. Sew together (◀▶) to make 2 units.

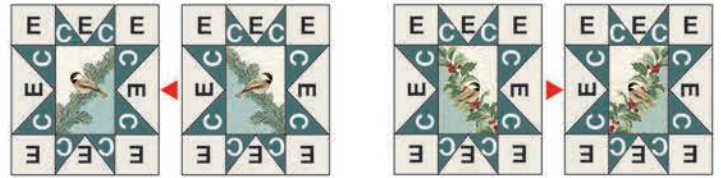

13 As in Steps 7, 8 and 9, diagonally stitch (2) 2-3/4” B squares to a 2-3/4” x 5” E rectangle (*diagram right*).



Then diagonally stitch (2) 2-3/4” D squares to a 2-3/4” x 5” E rectangle (*diagram left*). Make 16 each of the “B” and “D” units.



14 Using Step 13 units, stitch (8) “B” units to sides of 5” panel squares of (2) “Chickadee/Blue” and (2) “Chickadee/Wreath”.



Stitch (8) “D” units to the (4) 5” panel squares of “Holly.”



15 Add 2-3/4” squares of E to the remaining Step 13 units (*diagrams right*), and attach them to the top and bottom of each Step 14 block. Make 4 of each as shown below.

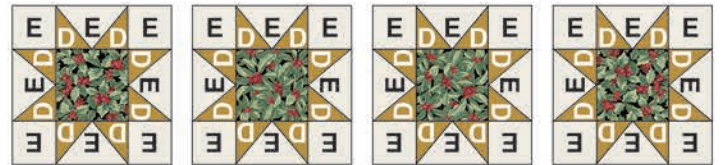
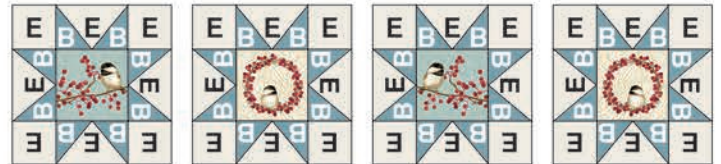

16 Vertically stitch a 9-1/2” x 10” E rectangle between 2 of the “Holly” *Gold Stars*. Sew a 9-1/2” x 9-3/4” E rectangle above and below the “Chickadee/Wreath” *Stars*.

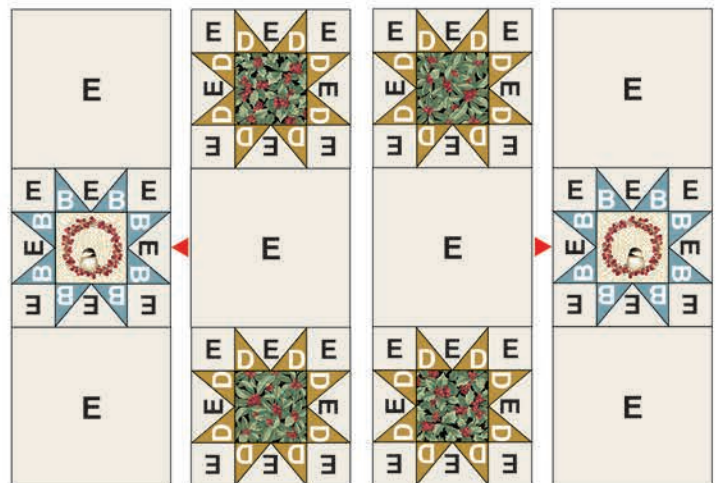

Sew together (◀▶) as shown to make 2 units.

17 Referring to the illustration below, stitch the Step 16 units to the sides¹ of the *Center Panel Star*.

18 Sew a 1-1/4" x 9-1/2" **E** to the right² of one "Chickadee/Blue" *Star*, and to the left³ of the other. Add a 10-1/4" x 3" **E** above⁴ one and below⁵ the other, followed by a 5-1/4" x 12" **E** to the left⁶ or right⁷. Make 2 which are opposites.

19 Add a 1-1/2" x 21-1/2" **E** above⁸ OR below⁹ each *Corner Star* pair.

20 Looking at the line drawing after Step 25, sew the Step 9, 18, and 19 units together. Attach them above and below the center.

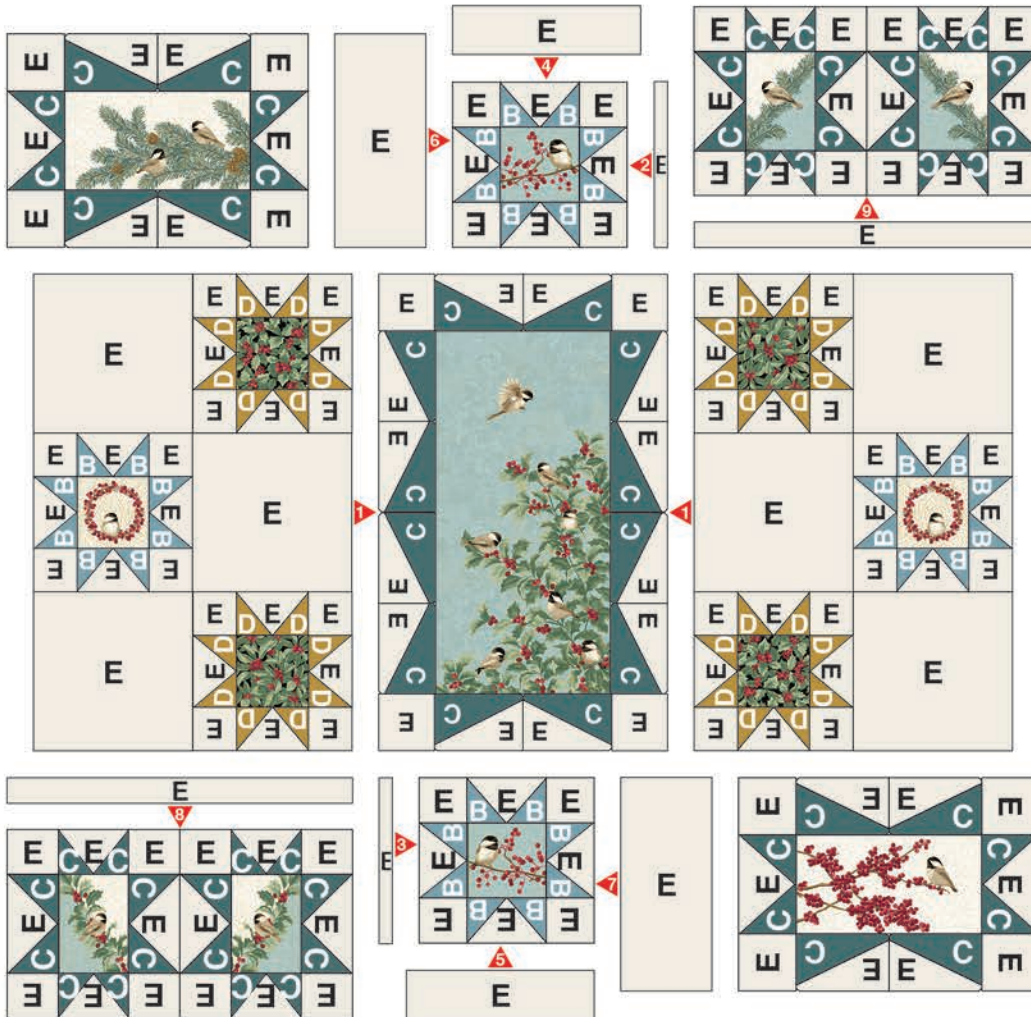

BORDER ASSEMBLY ♦ QUILTING ♦ BINDING

MEASURE WIDTH AND LENGTH OF THE QUILT TOP TO ENSURE BORDER SIZES. BELOW ARE [OUR CUTTING SIZES].

21 Add a 2" x [51"] **E** border to both sides¹⁰ of the quilt. Stitch a 2" **D** square to both ends¹¹ of the 2" x [53"] **E**. Attach them to the top and bottom¹² of the quilt.

22 Diagonally stitch¹³ a 2" **D** square to both ends of the 2" x [54"] and 2" x [56"] **B**. Be certain to use opposite diagonals at the ends so they will create the trapezoid shape shown at right.

23 Sew the [54"] **B** borders to the sides¹⁴ of the quilt. Add 2" **B** squares¹⁵ to both ends of the [56"] borders, and attach them¹⁶ to the top and bottom. Press carefully.

24 Cut batting and backing 3" larger than top on all sides. Make a quilt

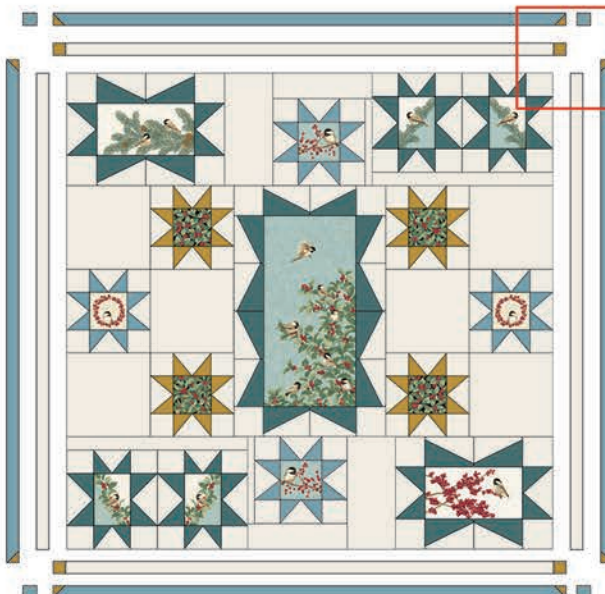

"sandwich" by layering backing, batting and top together. Then baste or pin. Quilt as desired, then trim the

excess batting and backing. Detail the star shapes with straight or freehand stitches. We suggest outlining the images from the Panel.

25 Bind with the 2-1/2" **B** strips specified, following the instructions with the Binding Miter Tool. There is also a video demo of this terrific tool at www.animasquilts.com.

NOTE: If this Benartex pattern is included in a kit, any questions about the kit should be addressed to the vendor from whom you bought it.