

"Flower Show" by Anne Rowan



Throw Quilt: 61 1/2" x 77 1/2"



Wall Quilt: 37" x 56"



Wilmington Prints: A World of Possibilities
www.wilmingtonprints.com/projects

Flower Show

Please read all instructions carefully AND identify all fabrics before beginning.

All instructions include a 1/4" seam allowance and strips are cut selvage to selvage, unless stated otherwise.

1. Cut the following for Wall Quilt:

Refer to thumbnails on pattern cover for Fabrics A-E used in this design.

Fabric A - PLEASE NOTE: Panels do not always print the size intended. For this pattern, the panel has a coping border added then trimmed so the panel will fit the quilt correctly.

Fussy cut 1/4" beyond outside edges of panel to approximately 22-1/2" x 41-1/2"

Fabric B - Cut (6) 2-1/2" strips (binding)

Cut (4) 2" strips, subcut (2) 2" x 26" borders

Fabric C - Cut (1) 3" strip, subcut (1) 3" x 21" strip

Cut (8) 2-1/2" strips

Fabric D - Cut (4) 3" strips

Cut (1) 2-1/2" strip, subcut (2) 2-1/2" x 21" strips

2. Piecing Order for Wall Quilt:

1. Stitch 2 **Fabric C** 2-1/2" x width of fabric strips together end to end. Make a total of 4.

2. Stitch 2 **Fabric D** 3" x width of fabric strips together end to end. Make a total of 2.

3. Sew a double-length **Fabric D** 3" strip between 2 **Fabric C** 2-1/2" double-length strips. Make a second strip set. Subcut each into (1) 7" x 43-1/2" border, (1) 7" x 24-1/2" border, and (2) 3" x 7" Unit 1.

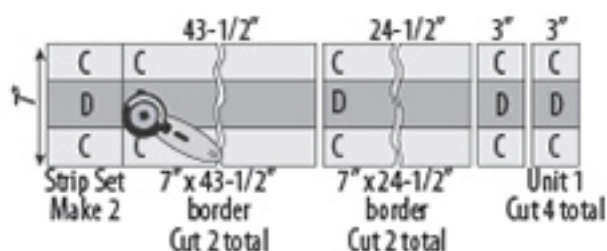

4. Sew a **Fabric C** 3" x 21" strip lengthwise between 2 **Fabric D** 2-1/2" x 21" strips. Subcut into (8) 2-1/2" x 7" Unit 2.

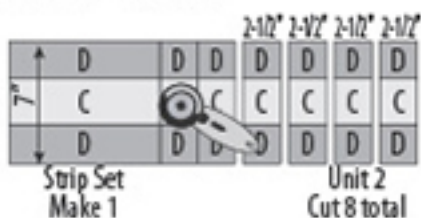

5. Sew a Unit 1 between 2 Unit 2. Make a total of 4 blocks (7" square unfinished).



Make 4 Blocks

6. Refer to Quilt Layout (Page 3) for arrangement and placement of panel, borders, and blocks

7. Stitch **Fabric B** 2" x width of fabric strips to sides of the **Fabric A** panel. Trim strip ends even. Add 2" x 26" **Fabric B** strips to top and bottom of panel. *Trim bordered panel to 24-1/2" x 43-1/2" (unfinished).*

8. Stitch **Fabrics C** and **D** 7" x 43-1/2" borders to right and left sides of bordered panel. Sew blocks to short ends of **Fabrics C** and **D** 7" x 24-1/2" borders then add to top and bottom of quilt.

9. The quilt measures approximately 37-1/2" x 56-1/2" (unfinished). Make backing (**Fabric E**) approximately 8" larger than the top.

10. Layer and baste top, batting, and backing together. Quilt as desired. Attach binding (**Fabric B**) and enjoy!!

3. Cut the following for Throw Quilt:

Refer to thumbnails on pattern cover for Fabrics A-K used in this design.

Fabric A - Referring to the quilt image, fussy cut strips, the length of fabric parallel to selvage: (2) 9-3/4" x 82" and (2) 9-3/4" x 66" multi-stripe borders

Fabric B - Cut (1) 8-1/2" strip, subcut (1) 8-1/2" square and (5) 4-1/2" squares
Cut (1) 4-1/2" strip, subcut (9) 4-1/2" squares

Fabric C - Cut (1) 4-1/2" strip, subcut (16) 2-1/2" x 4-1/2" strips

Fabric D - Cut (8) 2-1/2" strips (binding)
Cut (3) 2-1/2" strips, subcut (48) 2-1/2" squares

Flower Show

Fabric E - Cut (1) 4-1/2" strip, subcut (4) 4-1/2" squares

Cut (1) 2-1/2" strip, subcut (16) 2-1/2" squares

Fabric F - Cut (1) 2-7/8" strip, subcut (12) 2-7/8" squares then cut in half diagonally for a total of 24 triangles

Cut (6) 2-1/2" strips, subcut (40) 2-1/2" x 4-1/2" pieces and (24) 2-1/2" squares

Fabric G - Cut (1) 4-1/2" strip, subcut (4) 4-1/2" squares and (8) 2-1/2" squares

Cut (1) 2-1/2" strip, subcut (16) 2-1/2" squares

Fabric H - Cut (1) 2-7/8" strip, subcut (12) 2-7/8" squares then cut in half diagonally for a total of 24 triangles

Cut (6) 2-1/2" strips, subcut (32) 2-1/2" x 4-1/2" pieces and (24) 2-1/2" squares

Fabric I - Cut (2) 2-7/8" strips, subcut (24) 2-7/8" squares then cut in half diagonally for a total of 48 triangles

Cut (3) 2-1/2" strips, subcut (40) 2-1/2" squares
Cut (5) 2" strips, sewn together end to end and cut into 2" x 56-1/2" and 2" x 43-1/2" borders

Fabric J - Cut (4) 2-1/2" strips, subcut (56) 2-1/2" squares

4. Piecing Order for Throw Quilt:

1. Arrange 1 **Fabric E** 4-1/2" square, 4 **Fabric E** 2-1/2" squares, and 4 **Fabric H** 2-1/2" x 4-1/2" pieces in 3 rows as shown. Stitch into rows. Sew rows together.

Make a total of 4 **Block 1a** (8-1/2" square unfinished).



2. In the same manner, make the number of **Blocks 1b-1d** listed with fabrics indicated.



Block 1b - Make 10



Block 1c - Make 4



Block 1d - Make 4

3. Stitch **Fabrics H** and **I** 2-7/8" triangles together along their long edges. Make a total of 24 **Unit 1** (2-1/2" square finished). In the same manner, make 24 **Unit 2** with fabrics indicated.



4. Arrange **Fabrics D, F, G,** and **H** 2-1/2" squares and 2 each **Units** and 2 (**U1** and **U2**) in 4 rows as shown. Stitch into rows. Sew rows together. Make a total of 12 **Block 2** (8-1/2" square unfinished).



5. Refer to Quilt Layout (Page 4) for arrangement and placement of blocks, **Fabric B** square, and borders.

6. Arrange blocks and **Fabric B** 8-1/2" square into 7 rows. Sew into rows. Stitch rows together to complete quilt center (40-1/2" x 56-1/2" unfinished).

7. Stitch **Fabric I** 2" x 56-1/2" borders to right and left sides of quilt center. Add **Fabric I** 2" x 43-1/2" borders to top and bottom of quilt center.

8. Center **Fabric A** 9-3/4" x 82" borders on right and left sides of quilt center and **Fabric A** 9-3/4" x 66" borders on top and bottom of quilt center with the flower stripe next to quilt center. Stitch borders to sides starting and stopping 1/4" from corners of quilt center. Do not trim. Press borders out.



Letters in italics indicate wrong side of fabric. Arrows indicate orientation of directional prints.

Flower Show

9. Working with 1 corner at a time, fold the quilt right sides together so the outside edges of the borders line up. Using a 45-degree ruler, mark from the end of border seams to outer edges of borders. Stitch along marked line. Trim seam allowance to 1/4". Press corner seam open. Repeat on remaining corners.

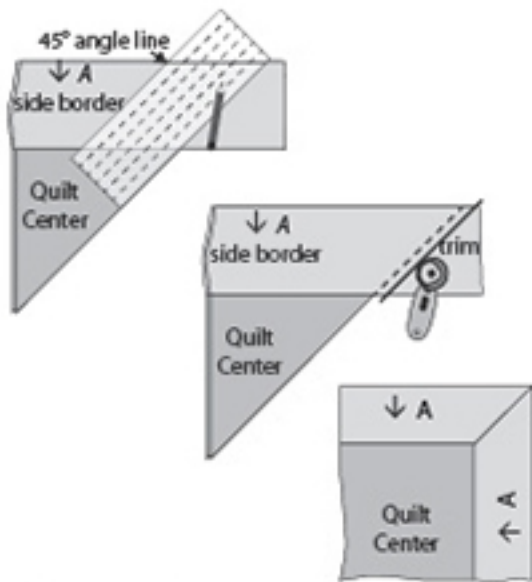

10. The quilt measures approximately 62" x 78" (unfinished). Make backing (**Fabric K**) approximately 8" larger than the top.

11. Layer and baste top, batting, and backing together. Quilt as desired. Attach binding (**Fabric D**) and enjoy!!

WALL QUILT LAYOUT

Border measurements are the cut size.

Arrow indicates orientation of directional print.

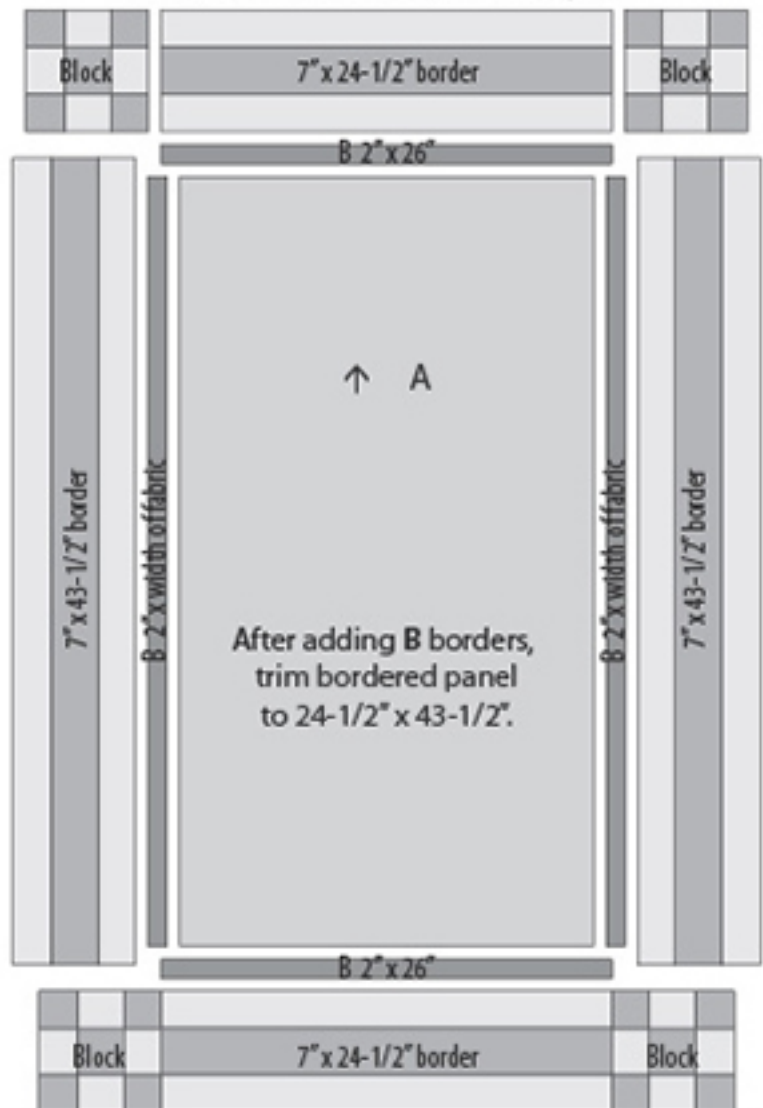

Flower Show

THROW QUILT LAYOUT

Border measurements are the cut size.

Arrows indicate orientation of directional prints.

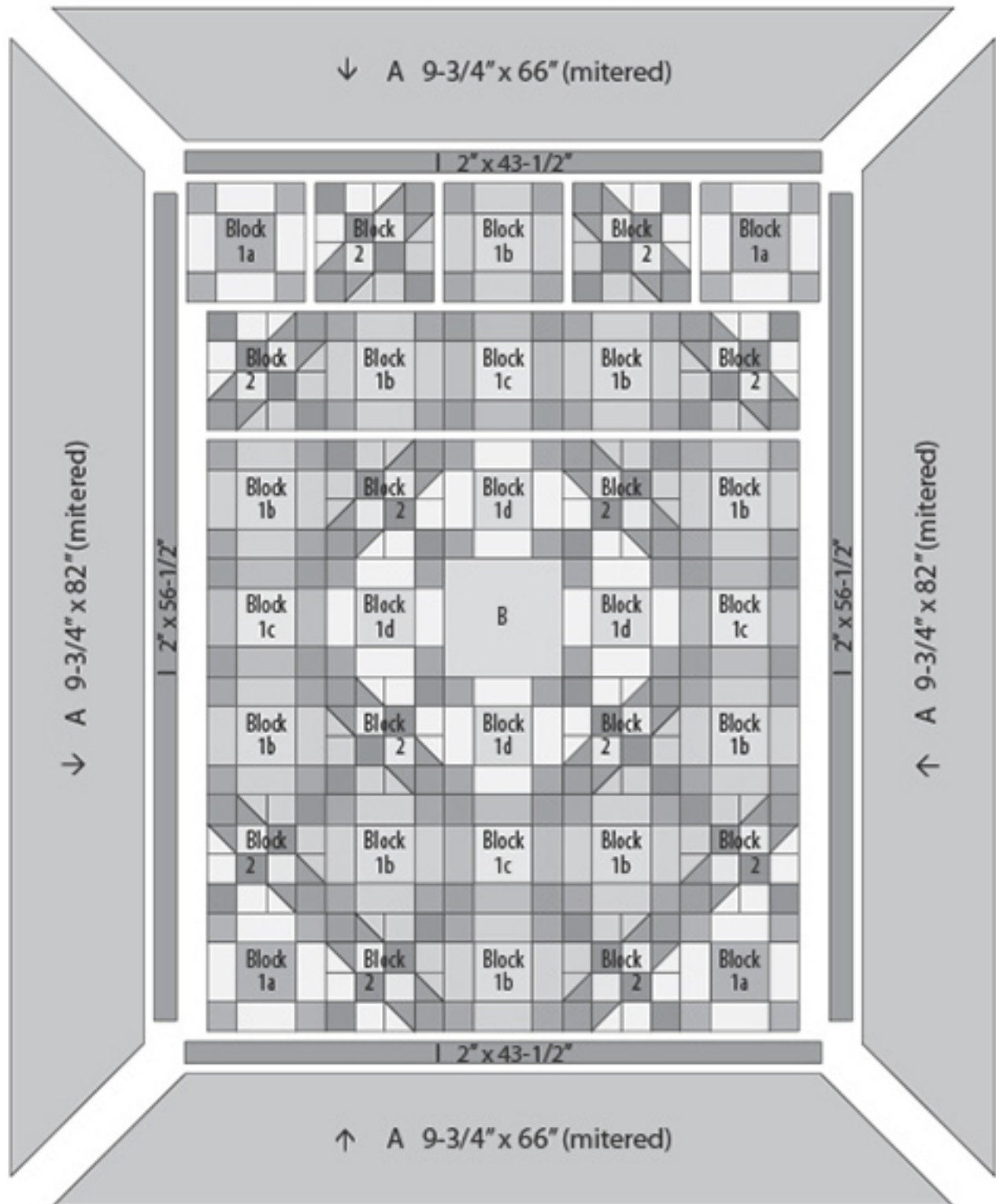

"Flower Show" by Anne Rowan

Fabric Yardage Needed for Wall Quilt:



Fabric A1 (24" x 43")
Q3007-68419-176
2/3 yd. (1 panel)



Fabric B1 (Essentials)
Q1825-85507-700
7/8 yd. (incl. binding)



Fabric C1
Q3007-68428-171
7/8 yd.



Fabric D1
Q3007-68421-673
5/8 yd.



Fabric E1 (Backing)
Q3007-68423-763
2 5/8 yds.

Fabric Yardage Needed for Throw Quilt:



Fabric A2 (24" repeat)
Q3007-68420-173
2 1/2 yds.



Fabric B2
Q3007-68421-173
1/2 yd.



Fabric C2
Q3007-68422-361
1/4 yd.



Fabric D2
Q3007-68424-661
1 1/8 yds. (incl. binding)

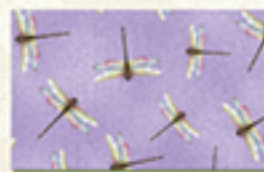

Fabric E2
Q3007-68426-624
1/3 yd.

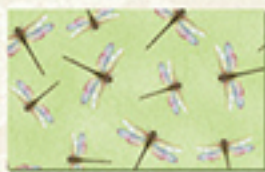

Fabric F2
Q3007-68426-724
5/8 yd.



Fabric G2
Q3007-68427-139
1/3 yd.



Fabric H2
Q3007-68428-171
5/8 yd.



Fabric I2 (Essentials)
Q1825-85507-700
1 yd.



Fabric J2 (Essentials)
Q1810-42324-330
3/8 yd.



Fabric K2 (Backing)
Q3007-68425-772
4 7/8 yds.



Or Fabric K2 (108" Backing)
Q1054-2081-663
2 1/8 yds.

Patterns shown at 25% unless otherwise indicated.



745181383048



Wilmington Prints: A World of Possibilities

www.wilmingtonprints.com/projects